

**INTRODUCTION:**

Adam Tech's RFC series RF connectors are a comprehensive assortment of Radio Frequency signal connectors in standard, miniature, sub-miniature, micro miniature and surface mount style. Included are our BNC, TNC, FME, FMA, SMA, SMB, N, F, PAL, UHF, Mini-UHF, MCX, MMCX and 1.6/5.6 coupling versions. Each has standard interfaces and are of a strong lightweight design. Most are ideal for applications where size and weight are important in densely populated applications. All afford excellent RF characteristics

**FEATURES:**

- DC to 50 GHz versions
- Plating Options
- Insulator options
- Impedance options
- Mating options
- PCB, Bulkhead and Cable versions

**MATING CONNECTORS:**

Adam Tech RF series connectors and all industry Standard RF connectors

**SPECIFICATIONS:**

**Material:**

- Housing: Brass, Nickel plated  
Zinc diecast, Nickel plated
- Standard Insulators: Delrin, Polypropylene or Teflon
- Optional Hi-Temp Insulator: Teflon
- Contacts: Beryllium copper, Gold plated

**Electrical:**

- Operating voltage: 150V AC max.
- Contact resistance: 5 mΩ max. initial
- Impedance: 50 or 75 ohms
- Insulation resistance: 5000 MΩ min.
- Dielectric withstanding voltage: 1000V AC for 1 minute
- VSWR: 1.2 max
- Frequency range: 0 – 6 GHZ

**Mechanical:**

- Engagement force: 4.5 lbs max
- Disengagement force: 2 lbs min
- Cable retention: equal to breaking strength of cable employed
- Durability: 500 cycles

**Temperature Rating:**

- Operating temperature: -65°C to +165°C
- Soldering process temperature:  
Standard insulator: 235°C  
Hi-Temp insulator: 260°C

**PACKAGING:**

Anti-ESD plastic trays or bags



**ORDERING INFORMATION**

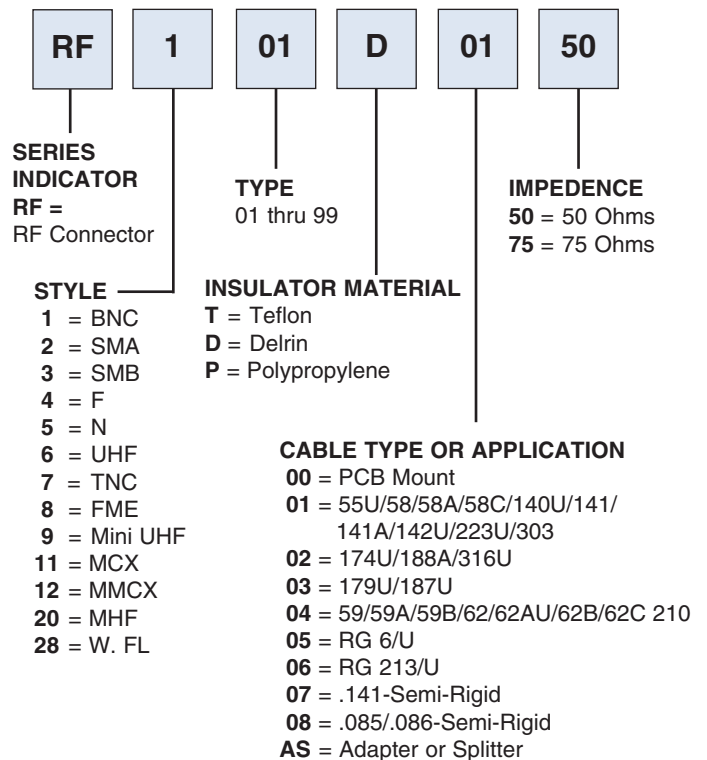

**OPTIONS:**

- Add as suffix to basic part no.
- HT = Hi-Temp insulator for hi-temp soldering processes up to 260°C
- G = Gold plated body and contact



**RF1 TYPE 01**  
BNC RIGHT ANGLE FEMALE PCB MOUNT

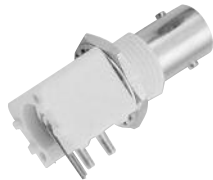

RF1-01-P-00-50

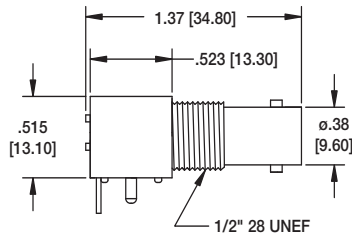

**RF1 TYPE 01V**  
BNC STRAIGHT FEMALE PCB MOUNT



RF1-01V-P-00-75

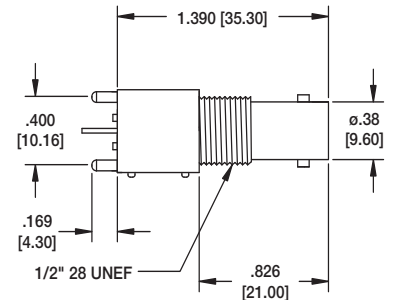

**RF1 TYPE 01A**  
BNC HIGH PROFILE RIGHT ANGLE FEMALE PCB MOUNT



RF1-01A-P-00-50

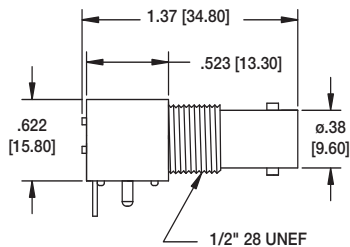

**RF1 TYPE 03**  
BNC MALE CRIMP



RF1-03-D-05-75

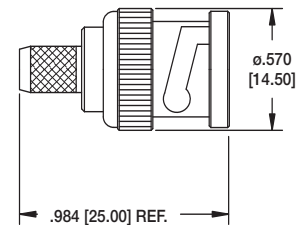

**RF1 TYPE 04**  
BNC FEMALE BULKHEAD CRIMP



RF1-04-T-01-75

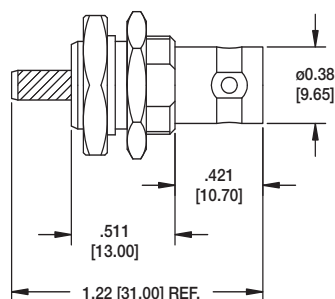

**RF1 TYPE 05**  
BNC MALE TO BNC DOUBLE FEMALE



RF1-05-D-AS-75

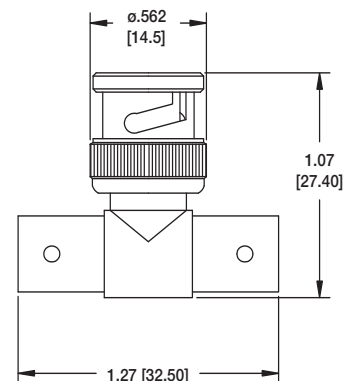

**RF1 TYPE 06**  
BNC MALE "Y" ADAPTER



RF1-06-D-AS-50

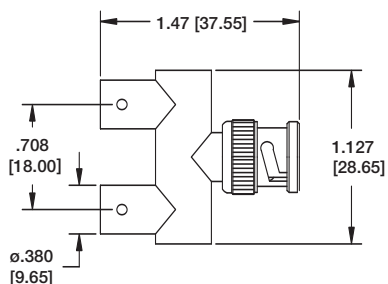

**RF1 TYPE 07**  
BNC FEMALE PC BOARD MOUNT



RF1-07-T-00-75

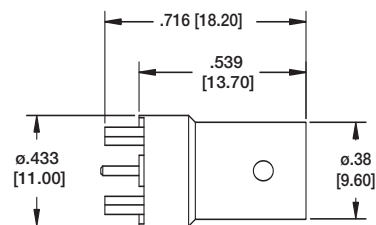

**RF2 TYPE 01**  
SMA RIGHT ANGLE MALE CRIMP TYPE



RF2-01-T-02-50

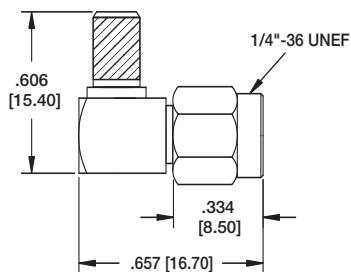

**RF2 TYPE 02**  
SMA MALE CRIMP TYPE



RF2-02-T-02-50-G

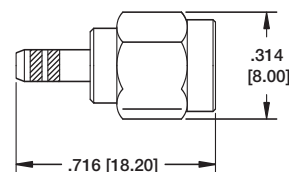

**RF2 TYPE 03**  
SMA RIGHT ANGLE FEMALE PC BOARD MOUNT



RF2-03-T-00-50-G

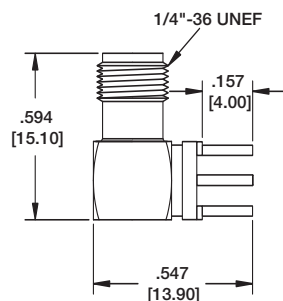

**RF2 TYPE 04**  
SMA FEMALE PC BOARD MOUNT



RF2-04-T-00-50-G

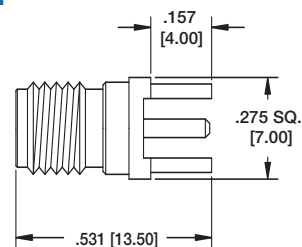

**RF2 TYPE 05**  
SMA FEMALE CHASSIS CRIMP



RF2-05-T-00-50-G

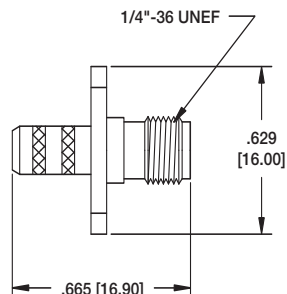

**RF2 TYPE 06**  
SMA FEMALE BULKHEAD CRIMP



RF2-06-T-02-50

