

## D2PH-1 (SMT)

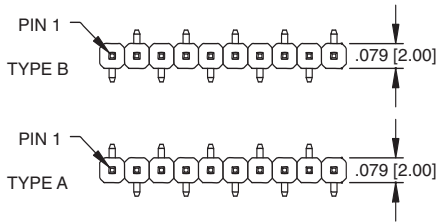

A = .079" [2.00] x No. of positions  
B = .079" [2.00] x No. of spaces



D2PH-1-12-U-100/SMT/240

### Recommended PCB Layout

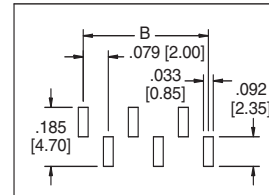
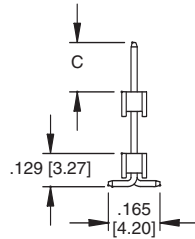
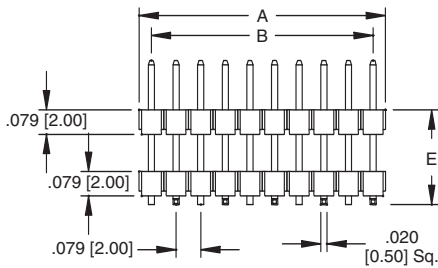

SMT-A

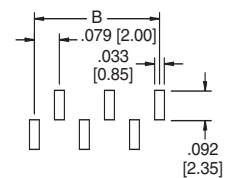

SMT-B

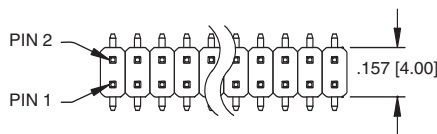

A = .079" [2.00] x No. of positions  
B = .079" [2.00] x No. of spaces

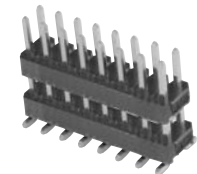

## D2PH-2 (SMT)

D2PH-2-16-U-145/SMT/360

### Recommended PCB Layout

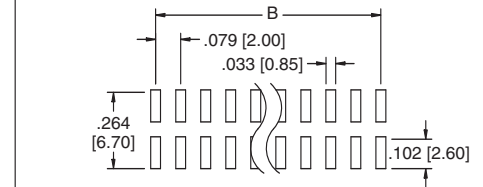
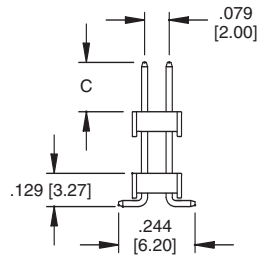
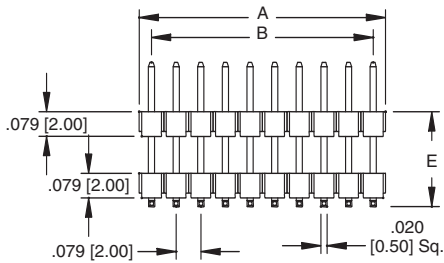

## MS2A

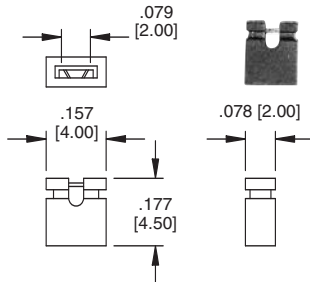

## MS2B

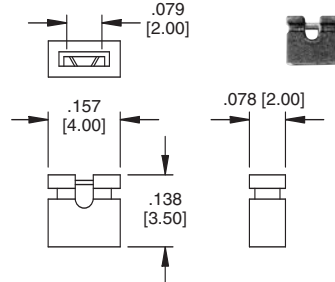

## MS2C

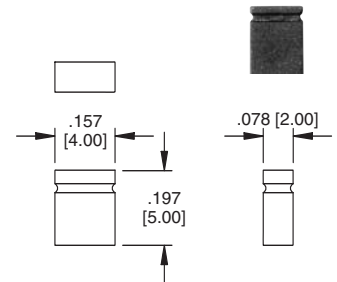

## MS2H-1

WITH RIGID SHORT HANDLE

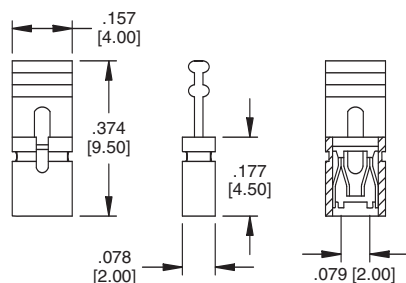

## MS2H-2

WITH FLEXIBLE LONG HANDLE

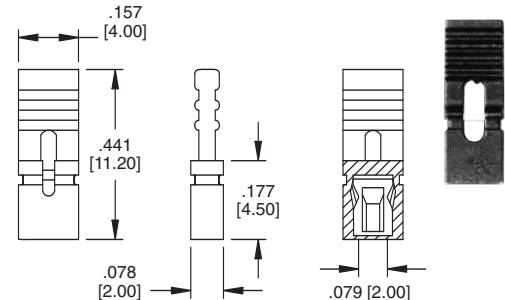

#### INTRODUCTION:

Adam Tech MS Series Mini Shunts are available in .050", 2.0mm, .100" and .200" centerlines. They quickly and easily jump individual or strip pin headers to perform manual programming on PCB's. This series offers a broad range of sizes, shapes and colors. Shunts are designed with detents at top for easy fingertip installation and removal. Options include integrated pull tabs and gang types which are molded in one piece. This series is extremely low cost and is a highly economical, cost effective solution to replacing PCB switches. Adam Tech's shunts are available in Gold or Tin plating.

#### FEATURES:

Electrically connects two pin header posts  
Wide variety of bodies and styles to choose from  
Superior insulator design provides easy Fingertip extraction  
Pull Tab and Ganged options available  
Choice of Gold or Tin-plated contact area  
Side and end stackable

#### MATING OPTIONS:

Mates with .025" sq. pin headers on .100" centers and all industry standard pin headers with .025" square post on .100" [2.54mm] centerlines.

#### SPECIFICATIONS:

##### Material:

Insulator: PBT, rated UL94V-0  
Insulator Color: Black  
Contacts: Phosphor Bronze

##### Contact Plating:

G = Gold flash (30u" optional) over nickel underplate overall  
T = Tin over copper underplate overall

##### Electrical:

Operating voltage: 250V AC max.  
Current rating: 3 Amps max  
Contact resistance: 20 mΩ max. initial  
Insulation resistance: 5000 MΩ min.  
Dielectric withstanding voltage: 1000V AC for 1 minute

##### Mechanical:

Insertion force: 1.57 lbs max.  
Withdrawal force: .65 lbs min  
Mating durability: 50 Cycles Gold  
20 Cycles Tin

##### Temperature Rating:

Operating temperature: -55°C to +105°C

#### PACKAGING:

Anti-ESD plastic bags

#### SAFETY AGENCY APPROVALS:

UL Recognized File No. E224053  
CSA Certified File No. LR1578596

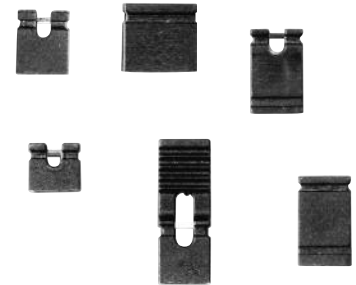

#### ORDERING INFORMATION

MSB

G

#### BODY STYLE/HEIGHT

MSA = Closed top, .256"  
MSB = Open top, .236"  
MSC = Open top, .177"  
MSDA = Closed top, .315"  
MSDB = Open top, .315"  
MSBH = Handle-top, .531"  
HMSA = .050" Mini Shunt  
HMSB = .050" Mini Shunt

MSE = Closed top, 3 position  
MST = 10 piece strip

MSBG = Ganged, block type  
(Specify # of positions, 2 thru 10)

#### PLATING

G = Gold plated  
T = Tin plated

2.00mm Shunts - Pg. 249

#### OPTIONS:

Add designator(s) to end of part number  
30 = 30 μin gold plating in contact area

#### STANDARD INSULATOR COLOR IS BLACK

Other insulator colors available  
Add designator(s) to end of part number

R = Red \*  
B = Blue \*  
W = White \*  
Y = Yellow \*  
G = Green \*

\* Minimum order required

<p><b>MSA</b> .100"</p>	<p><b>MSB</b> .100"</p>	
<p><b>MSC</b> .100"</p>	<p><b>MSDA</b> .100"</p>	
<p><b>MSDB</b> .100"</p>	<p><b>MSBH</b> .100"</p>	
<p><b>HMSA</b> .050"</p>	<p><b>HMSB</b> .050"</p>	<p><b>MSE</b> 3P JUMPER</p>
<p><b>MSBG</b> .100" GANGED BLOCK</p> <p>A - .100 [2.54] X No of Positions B - .100 [2.54] X No of Spaces</p>	<p><b>MST</b> .100" 10 pc. STRIP</p>	