

INTRODUCTION:

Adam Tech Combination Signal/Coax D-Sub connectors are a popular interface for many mixed signal I/O applications. Offered in a 25 position shell they are a good choice for a low cost industry standard connection that requires utilization of standard signal and high performance, low impedance signals. Adam Tech connectors are manufactured with precision stamped standard signal contacts and precision turned coax contacts. These connectors are manufactured with precision stamped contacts offering a choice of contact plating and a wide selection of mating and mounting options.

FEATURES:

Mixed Signal Contact and Coax Interface
Industry standard compatibility
Durable metal shell design
Precision formed bifurcated contacts
Variety of Mating and mounting options

MATING CONNECTORS:

Adam Tech D-Subminiatures and all industry standard D-Subminiature connectors.

SPECIFICATIONS:

Material:

Insulator: PBT, 30% glass reinforced, rated UL94V-0
Insulator Colors: Black (Green optional)
Contacts: Phosphor Bronze
Shell: Steel, Tin or Zinc plated
Hardware: Brass, Nickel plated

Contact Plating:

Gold Flash (15 and 30 μ m Optional) over Nickel underplate.

Electrical:

Operating voltage: 250V AC / DC max.
Signal Current rating: 5 Amps max.
High Power contact current rating: 20 or 40 Amps.
Coaxial Impedance: 50 Ω (75 Ω optional)
Contact resistance: 20 m Ω max. initial
Insulation resistance: 5000 M Ω min.
Dielectric withstanding voltage: 1000V AC for 1 minute

Mechanical:

Insertion force: 0.75 lbs max
Extraction force: 0.44 lbs min

Temperature Rating:

Operating temperature: -65°C to +125°C

PACKAGING:

Anti-ESD plastic trays

APPROVALS AND CERTIFICATIONS:

UL Recognized File No. E224053
CSA Certified File No. LR1578596

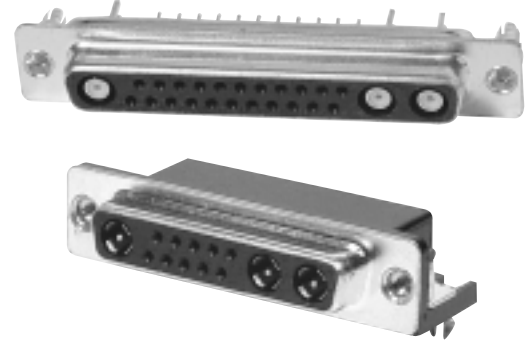

ORDERING INFORMATION

D3W3

SCL

24

SHELL CONFIGURATION

D5W1, D3W3,
D7W2, D11W1,
D3W3, D9W4,
D13W3, D17W2,
D21W1, D8W8,
D13W6, D21W4,
D25W3, D24W7,
D36W4

MATING FACE & BOARD MOUNTING OPTIONS

1 = Mounting holes only
24 = Forked boardlocks & #4-40 flush threaded inserts (right angle only)
25 = Forked boardlocks & #4-40 flush threaded inserts with jackscrews installed (right angle only)

CONTACT ARRANGEMENT

SCL = Socket, Right Angle Mount
PCD = Plug, solder cup signal contacts
PCR = Plug, crimp signal contacts
SCD = Socket, solder cup signal contacts

See pg. 68 for possible contact arrangements.

OPTIONS:

Add designator(s) to end of part number
30 = 30 μ m gold plating in contact area
RC = RoHS compliant lead-free product with Hi-Temp insulator
75 = 75 Ω impedance

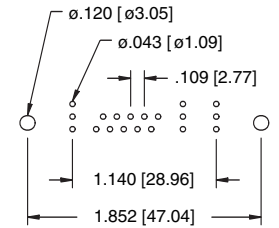
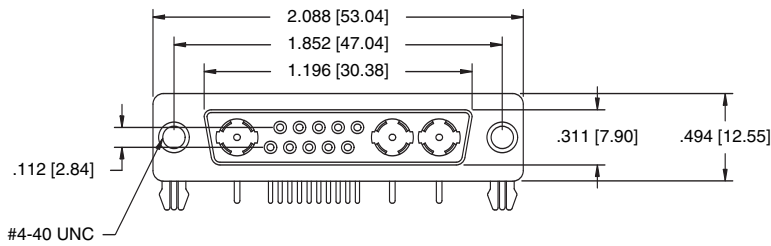

Recommended PCB Layout

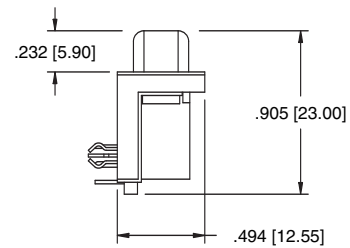
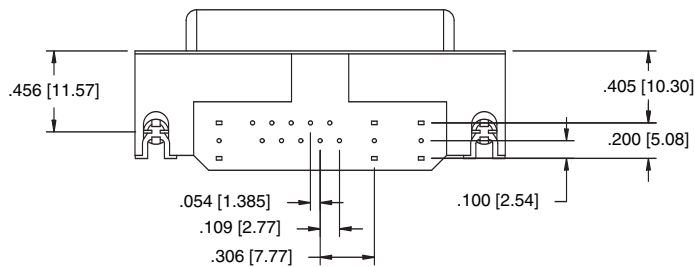

SOCKET - RIGHT ANGLE PCB MOUNT D13W3

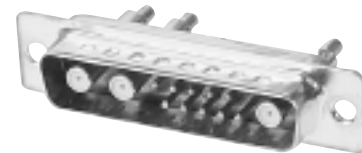
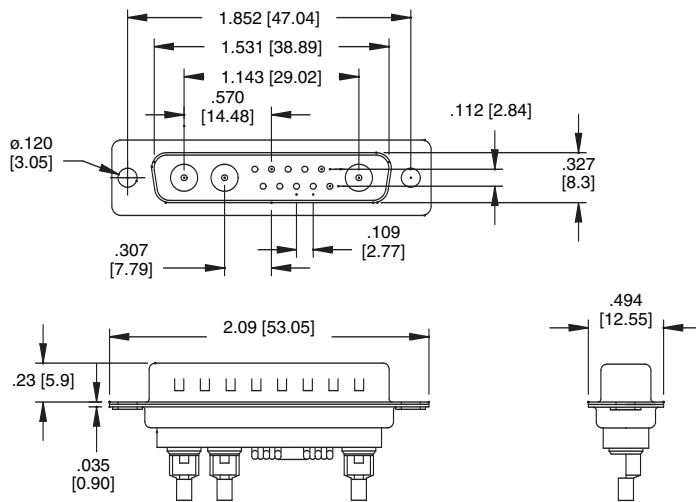

D13W3-PCD

PLUG - SOLDER CUP SIGNAL CONTACTS
WITH CRIMP COAX CONTACTS D13W3

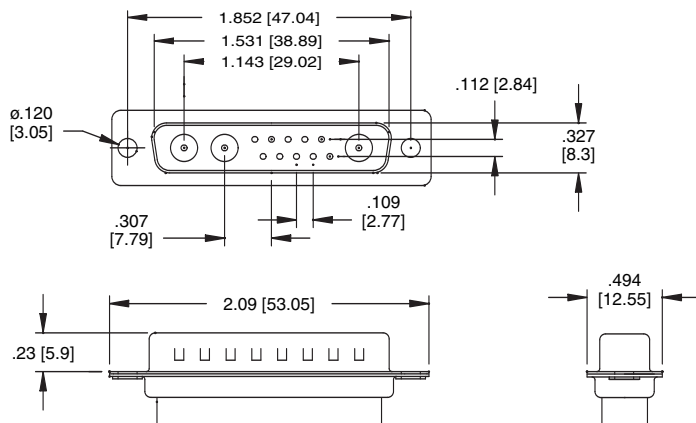

D13W3-PCR

HOUSING FOR CRIMP SIGNAL
AND CRIMP COAX CONTACTS D13W3

COMBINATION D-SUB COAXIAL & SIGNAL CONTACT ARRANGEMENTS

D5W1

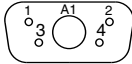

D3W3

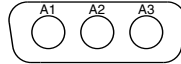

D7W2

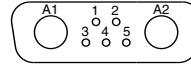

D11W1

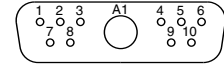

D5W5

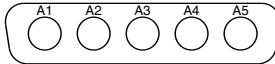

D9W4

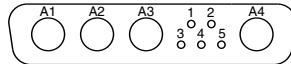

D13W3

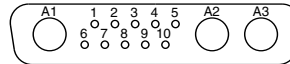

D17W2

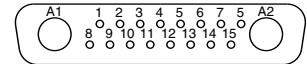

D21W1

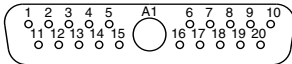

D8W8

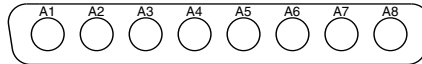

D13W6

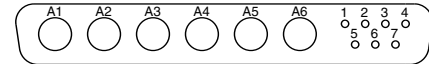

D21W4

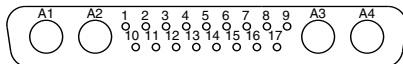

D25W3

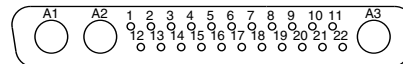

D24W7

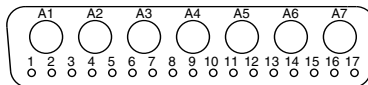

D36W4

