

**ICM**

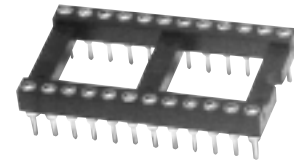

ICM-624-1-GT

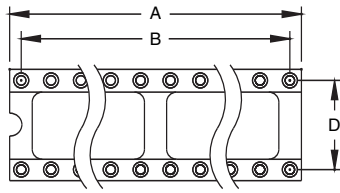
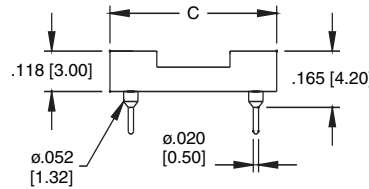
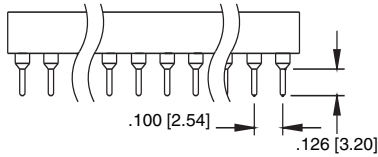

**SMC-1**

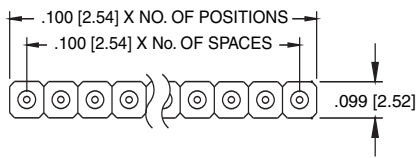

SMC-1-16-1-GT

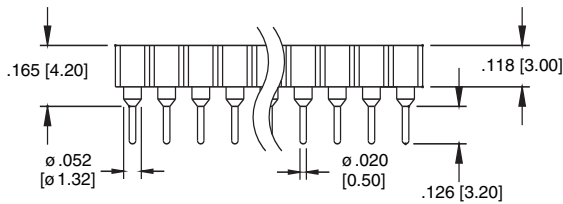

**SMC-2A**

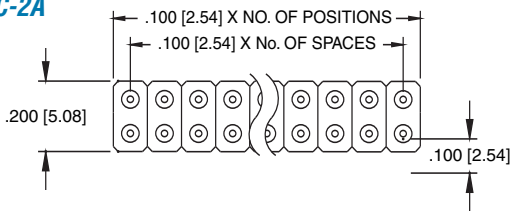

SMC-2A-32-1-GT

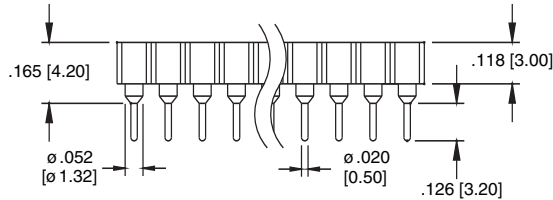

POSITION	Dimensions			
	A	B	C	D
8	.400 [10.16]	.300 [7.62]	.400 [10.16]	.300 [7.62]
14	.700 [17.78]	.600 [15.24]	.400 [10.16]	.300 [7.62]
16	.800 [20.32]	.700 [17.78]	.400 [10.16]	.300 [7.62]
18	.900 [22.86]	.800 [20.32]	.400 [10.16]	.300 [7.62]
20	1.00 [25.40]	.900 [22.86]	.400 [10.16]	.300 [7.62]
24	1.20 [30.48]	1.10 [27.94]	.400 [10.16]	.300 [7.62]
24	1.20 [30.48]	1.10 [27.94]	.700 [17.78]	.600 [15.24]
28	1.40 [35.56]	1.30 [33.02]	.400 [10.16]	.300 [7.62]
28	1.40 [35.56]	1.30 [33.02]	.700 [17.78]	.600 [15.24]
32	1.60 [40.64]	1.50 [38.10]	.700 [17.78]	.600 [15.24]
40	2.00 [50.80]	1.90 [48.26]	.700 [17.78]	.600 [15.24]

**Contact Detail**

