

Rev	AWO #	Description	Date	Appr
-	11365	RELEASED	6/02/11	

APPROVED: _____
 DATE: _____ TITLE: _____

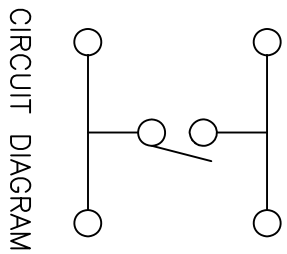
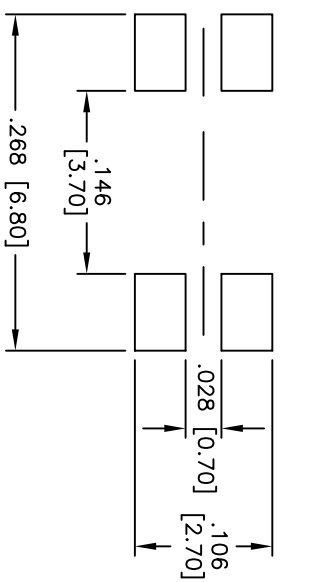
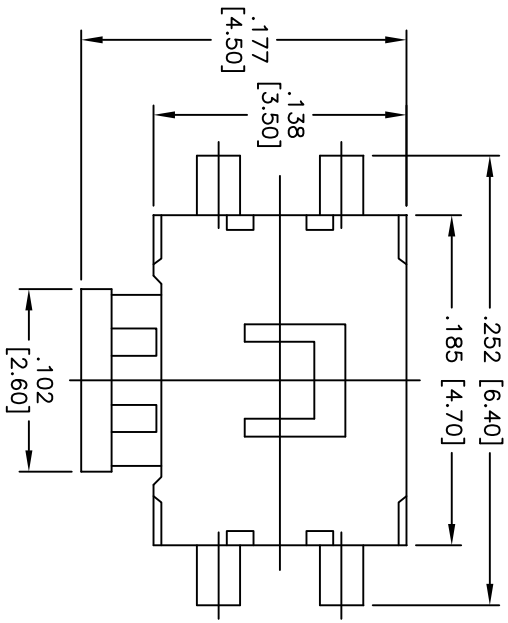
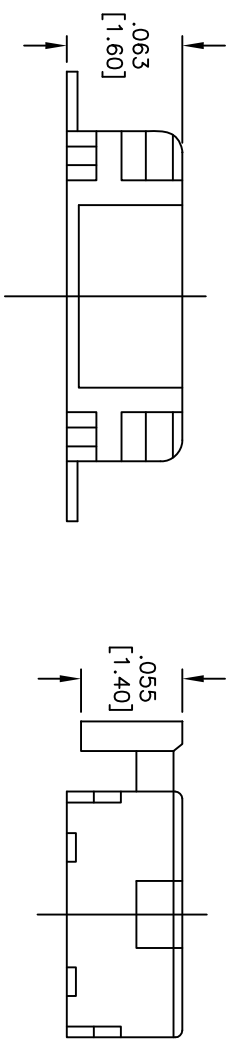

RECOMMENDED PCB LAYOUT

SPECIFICATIONS:

- Material: Terminal: Tin Phosphr Bronze
- Plate layer: Cyanide silver-plating
- Frame: LCP
- Contact: Stainless Steel, Silver plated
- Housing: Stainless Steel
- Stem: PA46
- Tape: Gathers the imide
- Electrical: Range: 0.05A DC12V
- Contact resistance: 100 mohms
- Insulation resistance: 100 Mohms
- Dielectric withstanding voltage: 250 VAC for 1 minute
- Temperature Rating: Operating temperature: -20°C to +70°C
- Environmental: Lead free, ROHS compliant
- Recommended soldering temp: 260°C for 5 seconds

UNLESS OTHERWISE SPECIFIED		ALL DIMENSIONS ARE INCHES [MM]	
TOLERANCES: EXCEPT AS NOTED		INCHES	
.X	± .10	ØX	± .10
.XX	± .020	ØXXX	± .015
.XXX	± .015	ØXXXX	± .010
APPROVALS		DATE	
DRAWN	DY	6/02/11	
CHECKED			
APPROVED			

ADAM TECH
 909 Rahway Avenue, Union, NJ 07083
 Phone: 908-687-5000 Fax: 908-687-5710

TITLE		PART NO.		REV.	
TACT SWITCH		SW-A11365		-	
REF:	S00112T	SCALE:	NTS	SHEET	1 OF 1

