

Rev	AWO #	Description	Date	Appr
-	9740	RELEASED	9/10/09	

APPROVED: _____
 DATE: _____ TITLE: _____

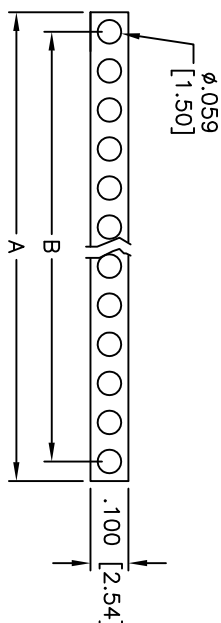

RECOMMENDED PCB LAYOUT

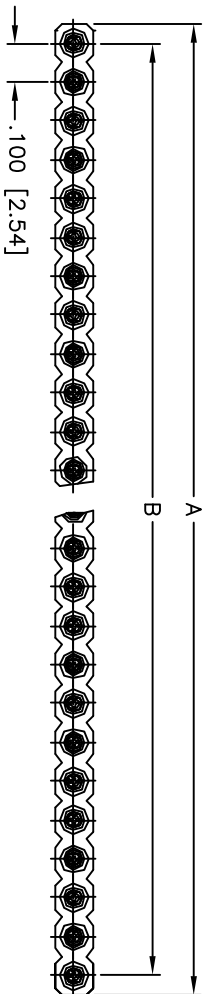
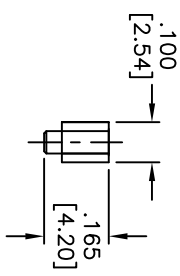
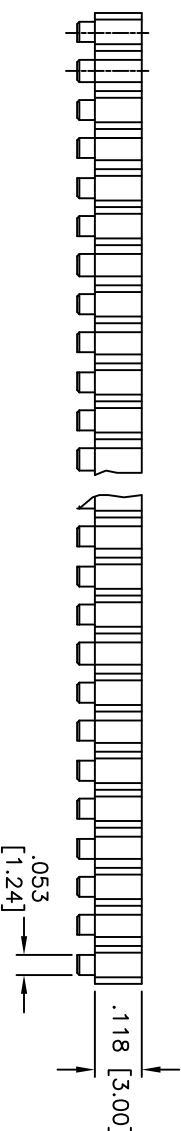

Positions: 1 thru 40
 A = .100 [2.54] x No. of Positions
 B = .100 [2.54] x No. of Spaces

SPECIFICATIONS:

- Material: PPS, Glass reinforced, rated UL 94V-0
- Insulator color: Black
- Contacts: BeCu
- Sleeve: Brass
- Plating:
- Inner contact: Gold flash over Nickel underplate
- Outer sleeve: Tin over Copper underplate overall
- Electrical:
- Operating voltage: 60 VDC/DC
- Current rating: 3 Amp max
- Contact resistance: 4 mohms max initial
- Insulation resistance: 1000 Mohms min @ 100 VDC
- Temperature Rating:
- Operating temperature: -40°C to +105°C
- Environmental:
- Lead free, RoHS compliant
- Recommended soldering temp: 260°C for 5 seconds

ADAM TECH

909 Railway Avenue, Union, NJ 07083
 Phone: 908-687-5000 Fax: 908-687-5710

TITLE: **SCREW MACHINE CONTACT SOCKET, SMT, .100" SPACING, GOLD/TIN PLATED**

UNLESS OTHERWISE SPECIFIED ALL DIMENSIONS ARE INCHES [MM]	
TOLERANCES: EXCEPT AS NOTED	
INCHES	HOLDS
.X ± .10	ØX ± .10
.XX ± .020	ØXX ± .015
.XXX ± .015	ØXXX ± .010
APPROVALS	DATE
DRAWN	DY
CHECKED	9/10/09
APPROVED	

SIZE	PART NO.	REV.
X	SMC-1-XX-GT-SMT	-
REF:	S00007T	SHEET 1 OF 1

