

Rev	AWO #	Description	Date	Appr
-		RELEASED	6/28/07	

APPROVED: _____
 DATE: _____ TITLE: _____

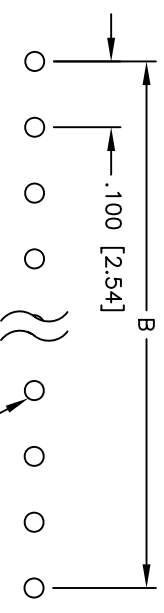
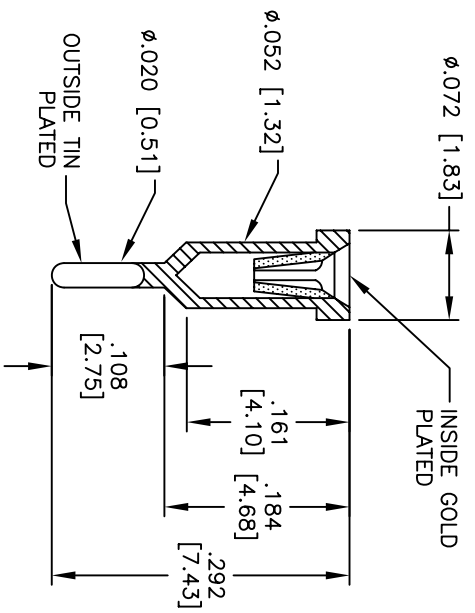
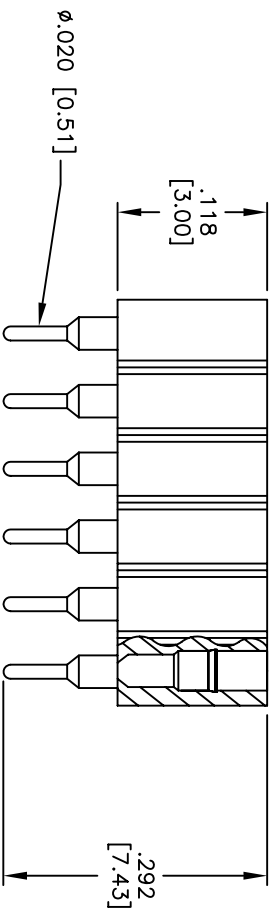
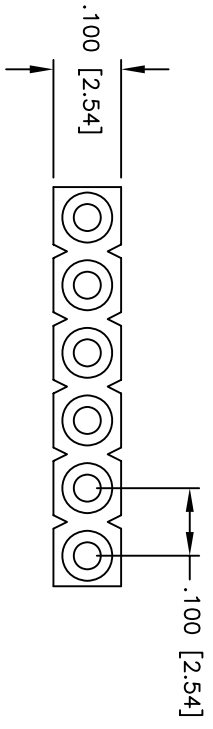

PCB LAYOUT

Positions: 1 thru 40
 A = .100 [2.54] x No. of Positions
 B = .100 [2.54] x No. of Positions - 1

SPECIFICATIONS:

- Material: Insulator: PPS, Glass reinforced, rated UL 94V-0
- Insulator color: Black
- Contacts: Phosphor Bronze
- Sleeve: Brass
- Plating: Inner contact: Tin over Copper underplate
Outer sleeve: Tin over Copper underplate overall
- Electrical: Operating voltage: 250 VAC max
Current rating: 3 Amp max
Contact resistance: 10 mohms max initial
Insulation resistance: 5,000 Mohms min
Dielectric withstanding voltage: 1000 VAC for 1 minute
- Temperature Rating: Operating temperature: -40°C to +105°C
- Environmental: Lead free, RoHS compliant
Recommended soldering temp: 235°C for 5 seconds

A

B

C

D

6

5

4

3

2

1

A

B

C

D

6

5

4

3

2

1

UNLESS OTHERWISE SPECIFIED ALL DIMENSIONS ARE INCHES [MM]	
TOLERANCES: EXCEPT AS NOTED	
INCHES	HOLES
.X ± .10	ØX ± .10
.XX ± .020	ØXX ± .015
.XXX ± .015	ØXXX ± .010
APPROVALS	DATE
DRAWN	SS
CHECKED	
APPROVED	

ADAM TECH
 909 Rahway Avenue, Union, NJ 07083
 Phone: 908-687-5000 Fax: 908-687-5710

SCREW MACHINE CONTACT SOCKET
 .100" SPACING, GOLD/TIN PLATED

SIZE	PART NO.	REV.
X	SMC-1-XX-1-TT	-
REF:	SCALE: NTS	SHEET 1 OF 1

