

Rev	AWO #	Description	Date	Appr
-		RELEASED	5/19/11	

APPROVED: _____
 DATE: _____ TITLE: _____

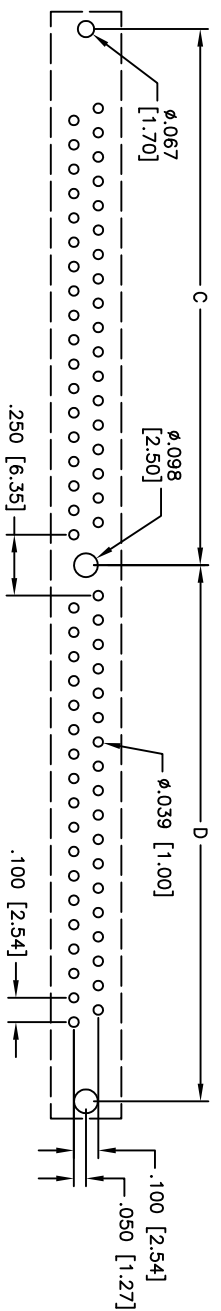
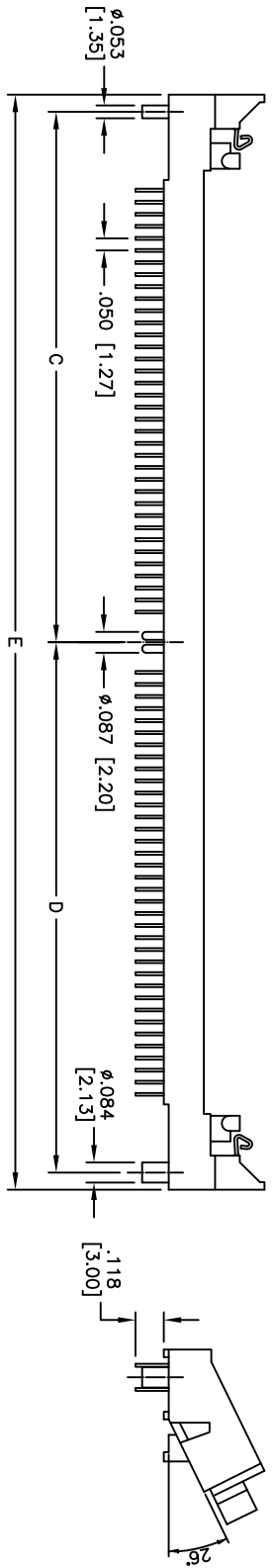
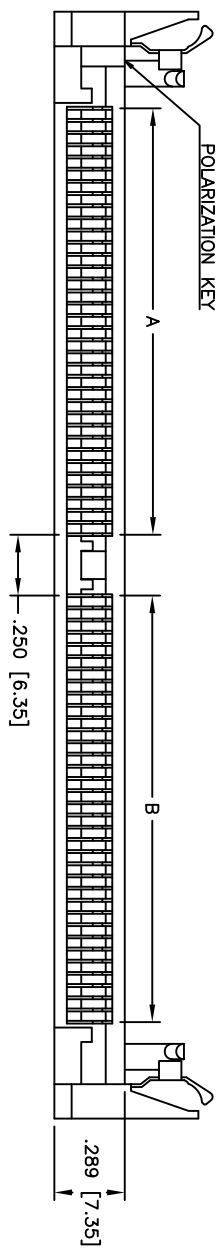

RECOMMENDED PCB LAYOUT (TOP VIEW)

PINS	A	B	C	D	E
64	1.549 [39.35]	1.549 [39.35]	2.005 [50.92]	2.005 [50.92]	4.157 [105.59]
68	1.649 [41.89]	1.649 [41.89]	2.105 [53.46]	2.105 [53.46]	4.357 [110.67]
72	1.750 [44.45]	1.750 [44.45]	2.205 [56.00]	2.205 [56.00]	4.557 [115.75]
80	1.950 [49.53]	1.950 [49.53]	2.412 [61.26]	2.412 [61.26]	4.959 [125.96]

ADAM TECH

909 Rahway Avenue, Union, NJ 07083
 Phone: 908-687-5000 Fax: 908-687-5710

TITLE: SIMM SOCKET, PITCH 1.27MM, PLASTIC POST
 26 DEGREE ANGLE

UNLESS OTHERWISE SPECIFIED ALL DIMENSIONS ARE MM [INCHES]	
TOLERANCES: EXCEPT AS NOTED	
INCHES	HOLDS
.X ± .10	ØX ± .10
.XX ± .020	ØXX ± .015
.XXX ± .015	ØXXX ± .010
APPROVALS	DATE
DRAWN	5/19/11
CHECKED	
APPROVED	



SPECIFICATIONS:
Material:
 Insulator: LCP, rated UL 94V-0
 Insulator color: Ivory
 Contacts: Copper Alloy
 Plating:
 Tin plated over Nickel underplate overall.
Electrical:
 Current rating: 1A
 Contact resistance: 30 mohms max
 Insulation resistance: 1,000 Mohms min
 Dielectric withstanding voltage: 500 VAC for 1 minute
Environmental:
 Temperature Rating:
 Operating temperature: -55°C to +100°C
 Lead free, RoHS compliant
 Recommended soldering temp: 260°C. for 5 seconds