

6

5

4

3

2

1

Rev	AWO #	Description	Date	Appr
-		RELEASED	8/12/10	

APPROVED: _____

DATE: _____ TITLE: _____

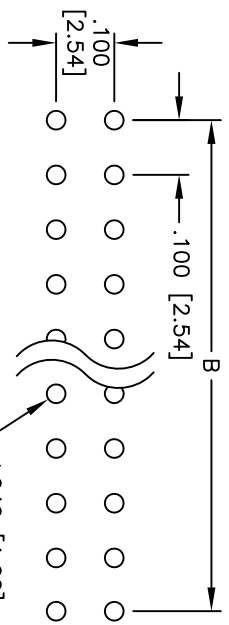
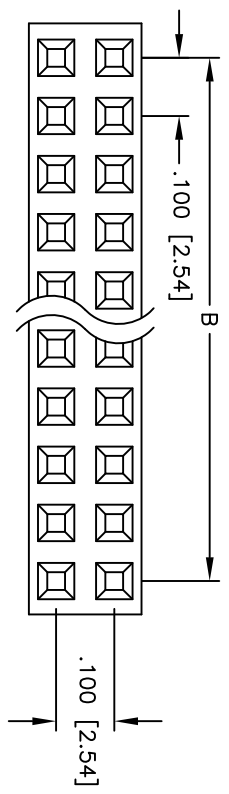

RECOMMENDED
PCB LAYOUT

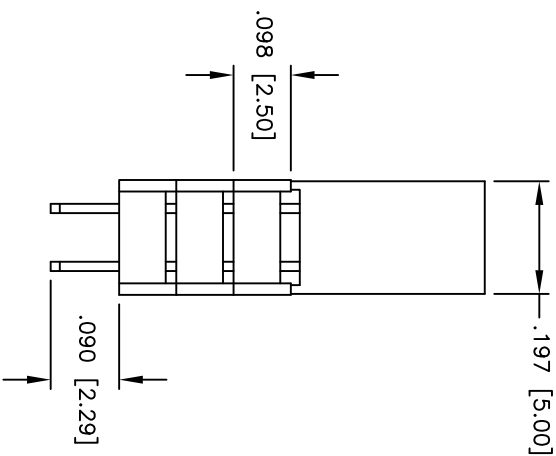
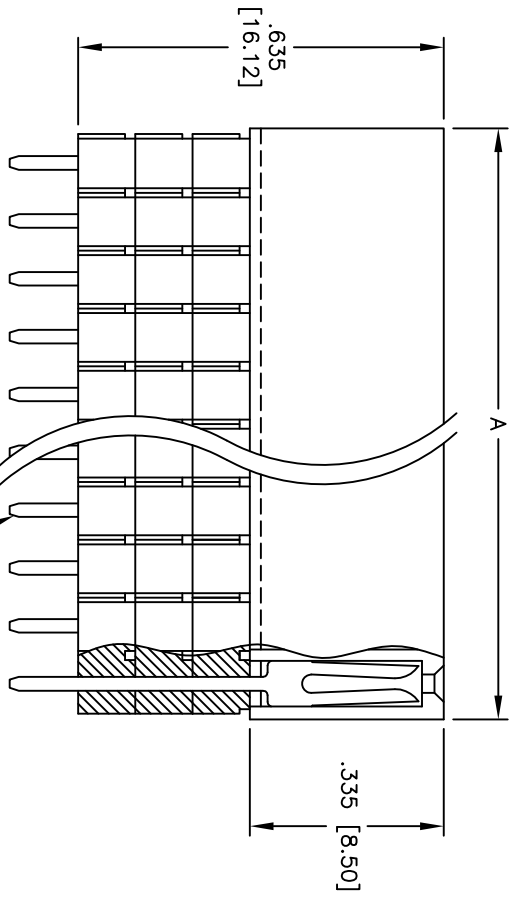

SPECIFICATIONS:

Material: Insulator: PBT, glass reinforced, rated UL 94V-0
 Insulator color: Black
 Contacts: Brass
 Plating: Tin over Copper underplate overall

Electrical: Operating voltage: 250 VAC max.
 Current rating: 3 Amps max.

Operating resistance: 20 mohms max. initial
 Insulation resistance: 5,000 Mohms min.
 Dielectric withstanding voltage: 1,000 VAC for 1 minute

Temperature Rating: Operating temperature: -40°C to +105°C
 Environmental: Lead free, RoHS compliant

Recommended soldering temp: 235°C for 5 seconds

Positions: 02 thru 80
 A = .100 [2.54] x No. of Positions per Row + .020 [0.50]
 B = .100 [2.54] x No. of Spaces

ADAM TECH

909 Railway Avenue, Union, NJ 07083
 Phone: 908-687-5000 Fax: 908-687-5710

TITLE: .100 x .100 DUAL ROW RECEPTACLE STRIP
 ELEVATED SOCKET, 3 INSULATORS

UNLESS OTHERWISE SPECIFIED ALL DIMENSIONS ARE INCHES [MM]		TOLERANCES: EXCEPT AS NOTED	
INCHES		HOLE SIZE	
.X	± .10	ØXX	± .10
.XX	± .020	ØXXX	± .015
.XXX	± .015	ØXXXX	± .010
APPROVALS		DATE	
DRAWN	DY	8/12/10	
CHECKED			
APPROVED			
SIZE	PART NO.	REF:	SCALE:
X	RSE2-3-XX-T-.090	S0009T	NIS
REV.		SHEET	1 OF 1



6

5

4

3

2

1