

6

5

4

3

2

1

| Rev | AWO # | Description | Date | Appr |
|-----|-------|-------------|----------|------|
| - | | RELEASED | 11/11/10 | |

APPROVED: _____

DATE: _____ TITLE: _____

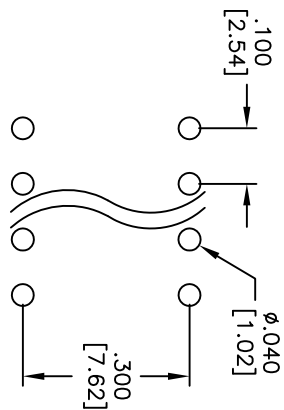
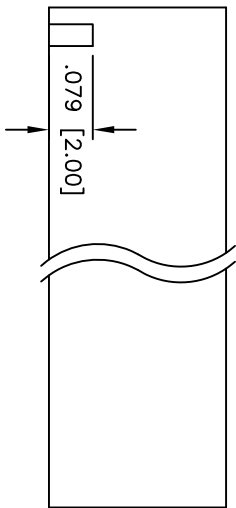

RECOMMENDED PCB LAYOUT

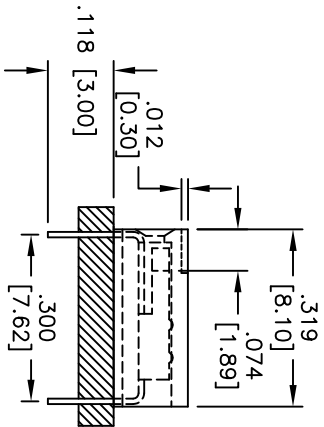
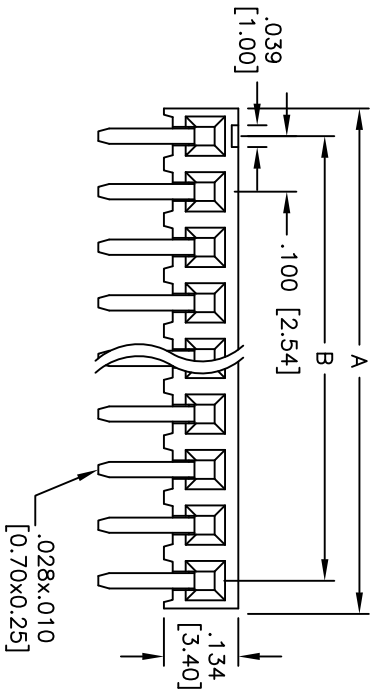

A = .100 [2.54] x No. of Positions per row
 B = .100 [2.54] x No. of Spaces

SPECIFICATIONS:

- Material: PBT, rated UL 94V-0
- Insulator color: Black
- Contacts: Phosphor Bronze
- Plating: Gold flash over Nickel underplate overall.
- Electrical:
 - Operating voltage: 250 VAC max
 - Current rating: 3 Amps max
 - Contact Resistance: 20 mOhms Max.
 - Insulation resistance: 1,000 Mohms min @ 500 VDC
 - Dielectric withstanding voltage: 600 VAC for 1 minute
- Temperature Rating:
 - Operating temperature: -40°C to +105°C
- Environmental:
 - Lead free, RoHS Compliant
 - Recommended soldering temp: 260°C for 5 seconds

ADAM TECH

909 Rahway Avenue, Union, NJ 07083
 Phone: 908-687-5000 Fax: 908-687-5710

**RECEPTACLE STRIP, .100 SINGLE ROW
 SIDE ENTRY, DIP TYPE, GOLD PLATED**



UNLESS OTHERWISE SPECIFIED
 ALL DIMENSIONS ARE INCHES [MM]
 TOLERANCES: EXCEPT AS NOTED
 INCHES HOLEES

| | | | |
|------|--------|-------|--------|
| .X | ± .10 | ØXX | ± .10 |
| .XX | ± .020 | ØXXX | ± .015 |
| .XXX | ± .015 | ØXXXX | ± .010 |

APPROVALS: _____ DATE: _____

DRAWN: DY 11/11/10

CHECKED: _____

APPROVED: _____

| | | |
|--------------|-------------|--------------|
| SIZE | PART NO. | REV. |
| X | RS1BRA-XX-G | - |
| REF: S00032T | SCALE: NTS | SHEET 1 OF 1 |

A

B

C

D

A

B

C

D

6

5

4

3

2

1