

Rev	AWO #	Description	Date	Appr
-		RELEASED	6/28/10	

APPROVED: _____ TITLE: _____
 DATE: _____

RECOMMENDED MOUNTING HOLES

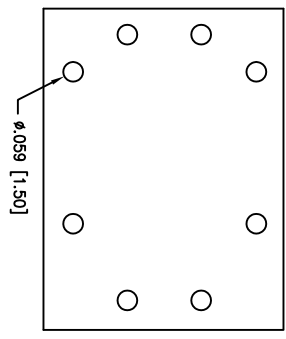

WIRING DIAGRAM
(Bottom View)

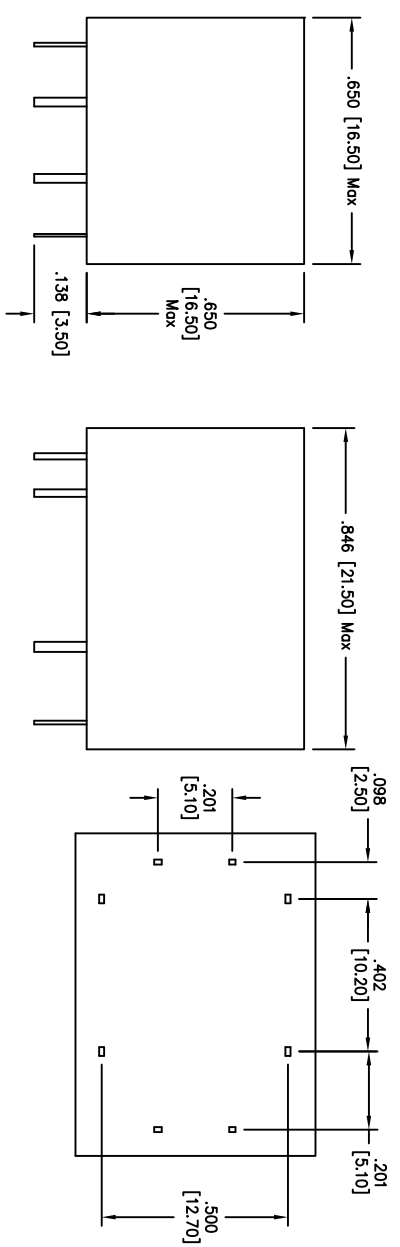
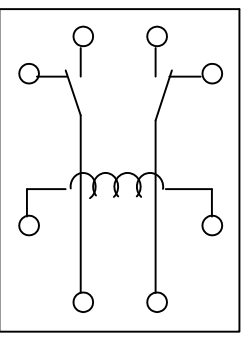

PART NO.	RPE-5A-P-24-S
Rated Voltage (V DC)	24VDC
Power consumption (W)	0.5W
Maximum voltage	150 Max.
Must Drop-out Voltage	10 Min.
Must Operate Voltage	75 Max.
Coil Resistance	1152Ω
Rated Current	20.8mA

SPECIFICATIONS:
Electrical:
 Contact arrangement: DPDT (2 Form C)
 Contact material: Silver Alloy
 Contact Rating (Resistive load): 5A 125VAC/28VDC
 Switching Voltage: AC380V / DC50V Max.
 Contact resistance: 50 mΩ max. Initial
 Insulation resistance: 100 MΩ min. @ 500V DC
 Dielectric Strength:
 Between open contact: 750VAC (50Hz/min)
 Between Coil & Contact: 1000VAC (50Hz/min)
 Operating time: 10ms max. Release time: 5ms max.
 Electrical Life: 100,000
Mechanical:
 Vibration resistance (Endurance): 1.5mm D.A. 10-55HZ
 Shock resistance: 10g Approx.
 Mechanical Life: 10,000,000
 Temperature Rating: Ambient temperature: -40°C to +70°C
Environmental:
 Lead free, RoHS compliant
 Recommended soldering temp: 235°C for 5 sec.
 Packaging: Anti-ESD plastic trays
 Safety Agency Approvals: cUL Recognized File No. E305638

UNLESS OTHERWISE SPECIFIED
 ALL DIMENSIONS ARE INCHES [MM]
 TOLERANCES: EXCEPT AS NOTED
 INCHES: .X ±.10 ØXX ±.015
 .XX ±.020 ØXXX ±.010
 .XXX ±.015

ADAM TECH

909 Rahway Avenue, Union, NJ 07083
 Phone: 908-687-5000 Fax: 908-687-5710

POWER RELAY, 5A, 24VDC, SEALED

APPROVALS	DATE	TITLE	SIZE	PART NO.	REV.
DRAWN	DY	6/28/10	X	RPE-5A-P-24-S	-
CHECKED					
APPROVED					

REF: S00027C SCALE: NTS SHEET 1 OF 1

