

Rev	AWO #	Description	Date	Appr
-		RELEASED	11/05/09	

APPROVED: \_\_\_\_\_  
 DATE: \_\_\_\_\_ TITLE: \_\_\_\_\_

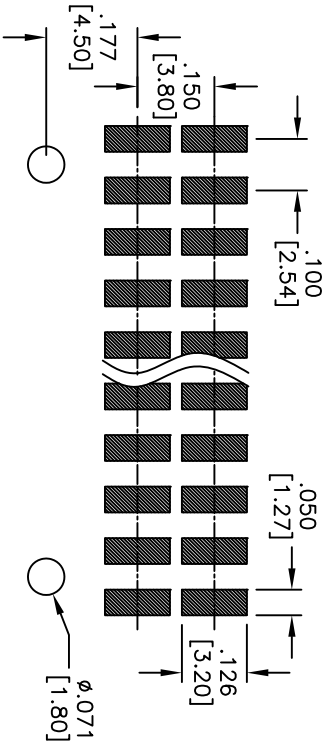

RECOMMENDED PCB LAYOUT

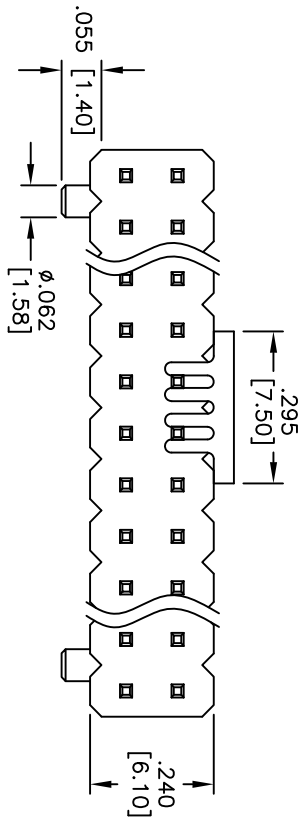
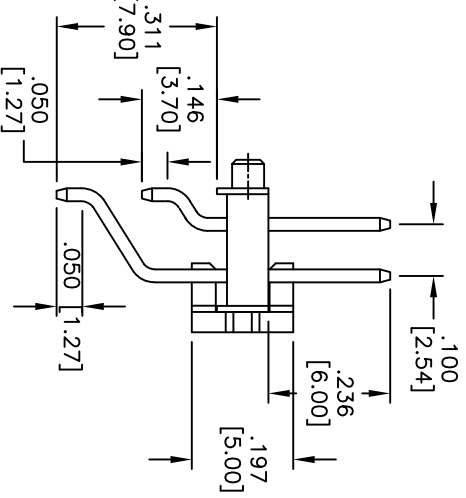
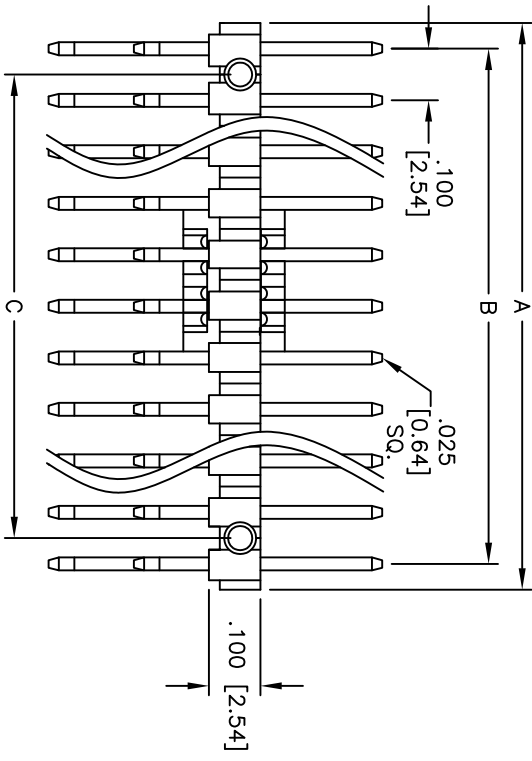

**SPECIFICATIONS:**

**Material:** Nylon 6T, glass reinforced, rated UL 94V-0  
**Insulator color:** Black  
**Contacts:** Brass

**Plating:** Tin over Copper underplate overall.

**Electrical:**  
**Current rating:** 3 Amp max  
**Contact resistance:** 20 mohms max  
**Insulation resistance:** 1,000 Mohms min  
**Dielectric withstanding voltage:** 600 VAC for 1 minute  
**Temperature Rating:**  
**Operating temperature:** -40°C to +105°C

**Environmental:**  
**Lead free, RoHS compliant**  
**Recommended soldering temp:** 260°C for 5 seconds

**Positions:** 6 thru 60  
 A = .100 [2.54] x No. of Positions per row  
 B = .100 [2.54] x No. of Spaces  
 C = .100 [2.54] x No. of Spaces - .100 [2.54]

**ADAM TECH**

909 Rahway Avenue, Union, NJ 07083  
 Phone: 908-687-5000 Fax: 908-687-5710

**.100 [2.54] DUAL ROW PIN HEADER**  
**RIGHT ANGLE, SMT, TIN PLATED**

UNLESS OTHERWISE SPECIFIED ALL DIMENSIONS ARE IN INCHES [MM]		TITLE RIGHT ANGLE, SMT, TIN PLATED	
TOLERANCES: EXCEPT AS NOTED		PART NO. PH2RA-XX-TA-SMT-P-PP	
INCHES		SIZE X	
HOLDS		REF: S0002T	
.X ± .10	ØXX ± .10	SCALE: NTS	
.XX ± .020	ØXXX ± .015	SHEET 1 OF 1	
.XXX ± .015	ØXXXX ± .010		
APPROVALS	DATE		
DRAWN DY	11/05/09		
CHECKED			
APPROVED			

