

Rev	AWO #	Description	Date	Appr
-		RELEASED	10/18/10	

APPROVED: _____
 DATE: _____ TITLE: _____

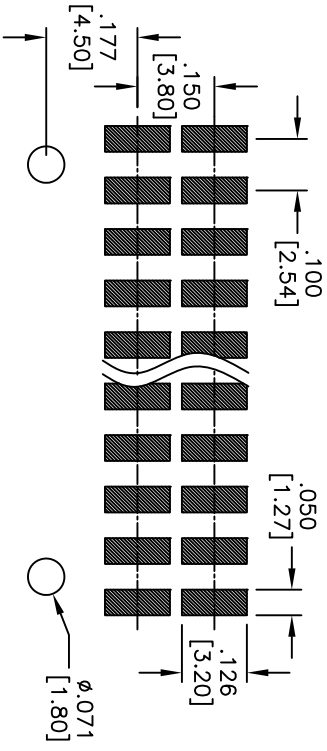

RECOMMENDED PCB LAYOUT

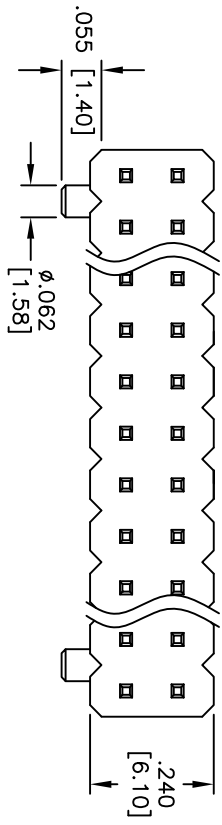
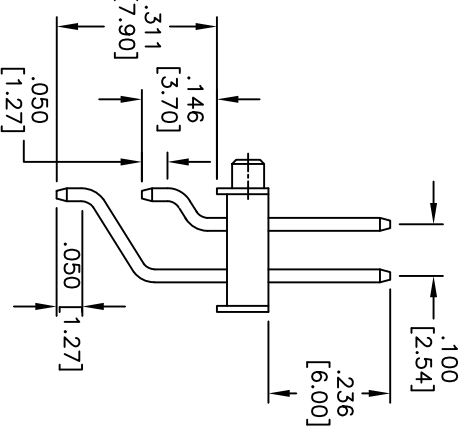
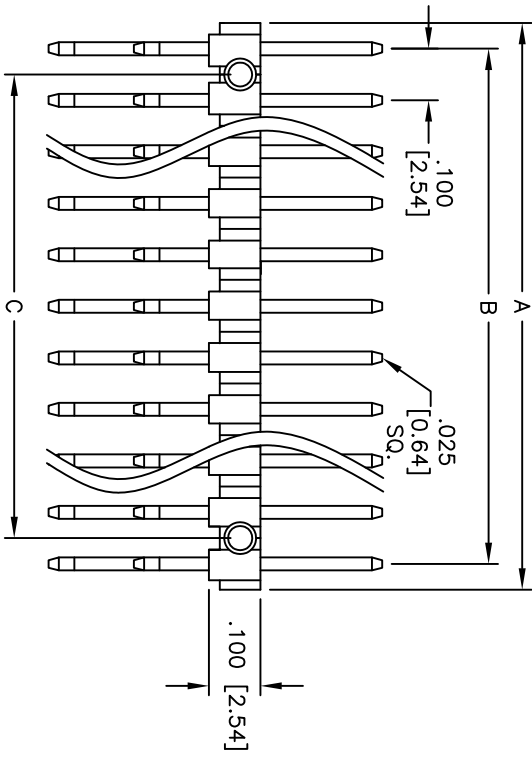

SPECIFICATIONS:

Material: Nylon 6T, glass reinforced, rated UL 94V-0
 Insulator color: Black
 Contacts: Brass

Plating: Tin over Copper underplate overall.

Electrical:
 Current rating: 3 Amp max
 Contact resistance: 20 mohms max
 Insulation resistance: 1,000 Mohms min
 Dielectric withstanding voltage: 600 VAC for 1 minute
 Temperature Rating:
 Operating temperature: -40°C to +105°C

Environmental:
 Lead free, RoHS compliant
 Recommended soldering temp: 260°C for 5 seconds



Positions: 6 thru 60
 A = .100 [2.54] x No. of Positions per row
 B = .100 [2.54] x No. of Spaces
 C = .100 [2.54] x No. of Spaces - .100 [2.54]

ADAM TECH

909 Rahway Avenue, Union, NJ 07083
 Phone: 908-687-5000 Fax: 908-687-5710

1.00 [2.54] DUAL ROW PIN HEADER
 RIGHT ANGLE, SMT, TIN PLATED

UNLESS OTHERWISE SPECIFIED ALL DIMENSIONS ARE IN INCHES [MM]	
TOLERANCES: EXCEPT AS NOTED	
INCHES	HOLES
.X ± .10	ØX ± .10
.XX ± .020	ØXX ± .015
.XXX ± .015	ØXXX ± .010
APPROVALS	DATE
DRAWN AY	10/18/10
CHECKED AW	10/18/10
APPROVED	

SIZE	PART NO.	REV.
X	PH2RA-XX-T-SMT-P	-
REF: S0002T	SCALE: NTS	SHEET 1 OF 1