

Rev	AWO #	Description	Date	Appr
-		RELEASED	9/24/09	

APPROVED: _____
 DATE: _____ TITLE: _____

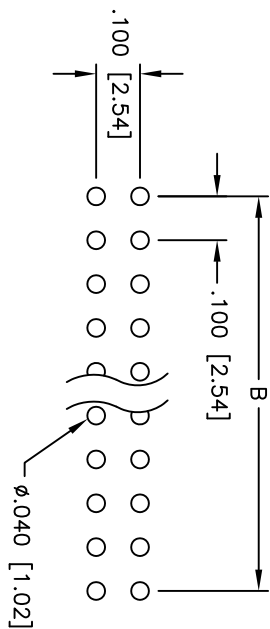

RECOMMENDED PCB LAYOUT

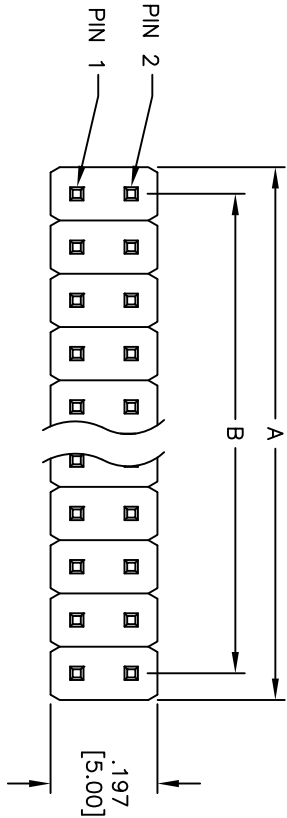
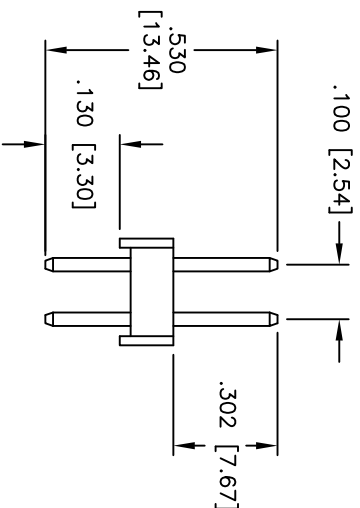
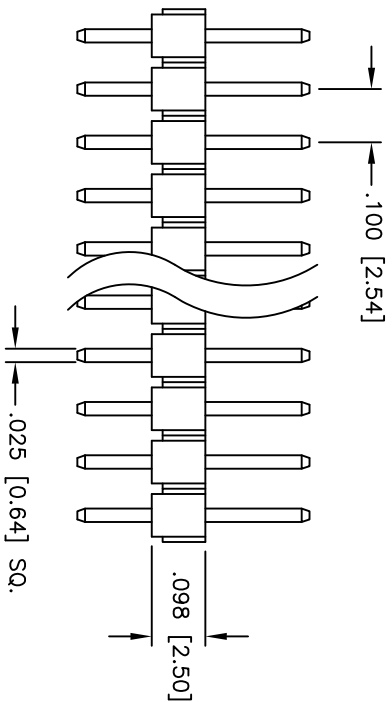

SPECIFICATIONS:

- Material: Insulator: PBT, glass reinforced, rated UL 94V-0
- Insulator color: Black
- Contacts: Brass
- Plating: Tin over Copper underplate overall
- Electrical: Current rating: 3 Amps max
- Contact resistance: 20 mohms max
- Insulation resistance: 5,000 Mohms min @ 500 VDC
- Dielectric withstanding voltage: 500 VAC for 1 minute
- Temperature Rating: Operating temperature: -40°C to +105°C
- Environmental: Lead free, RoHS compliant
- Recommended soldering temp: 235°C for 5 seconds

Positions: 2 thru 80
 A = .100 [2.54] x No. of Positions per Row
 B = .100 [2.54] x No. of Spaces

ADAM TECH

909 Rahway Avenue, Union, NJ 07083
 Phone: 908-687-5000 Fax: 908-687-5710

TIN PLATED
 .100 [2.54] DUAL ROW PIN HEADER

UNLESS OTHERWISE SPECIFIED ALL DIMENSIONS ARE INCHES [MM]		TITLE	
TOLERANCES: EXCEPT AS NOTED		.100 [2.54] DUAL ROW PIN HEADER	
INCHES		TIN PLATED	
.X ± .10	ØX ± .10	SIZE	PART NO.
.XX ± .020	ØXX ± .015	X	PH2-XX-T-130/.530
.XXX ± .015	ØXXX ± .010	REF:	S00059T
APPROVALS	DATE	SCALE:	NTS
DRAWN	DY	9/24/09	
CHECKED			
APPROVED			
REV.		SHEET 1 OF 1	

