

Rev	AWO #	Description	Date	Appr
-		RELEASED	9/01/10	

APPROVED: _____
 DATE: _____ TITLE: _____

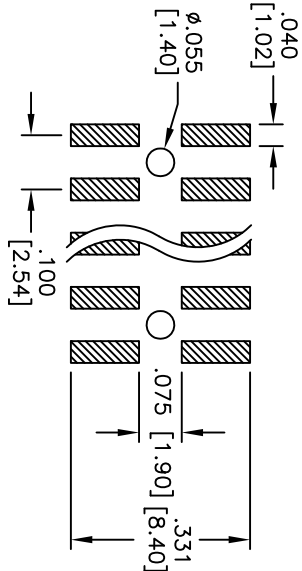

RECOMMENDED PCB LAYOUT

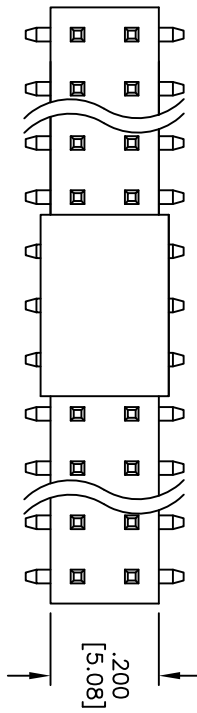
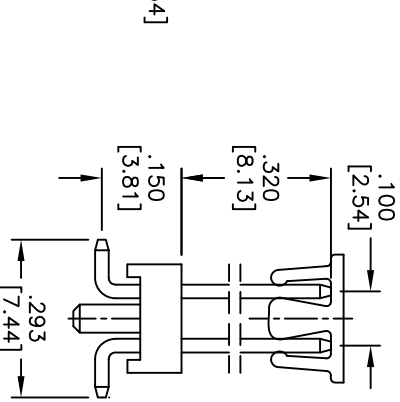
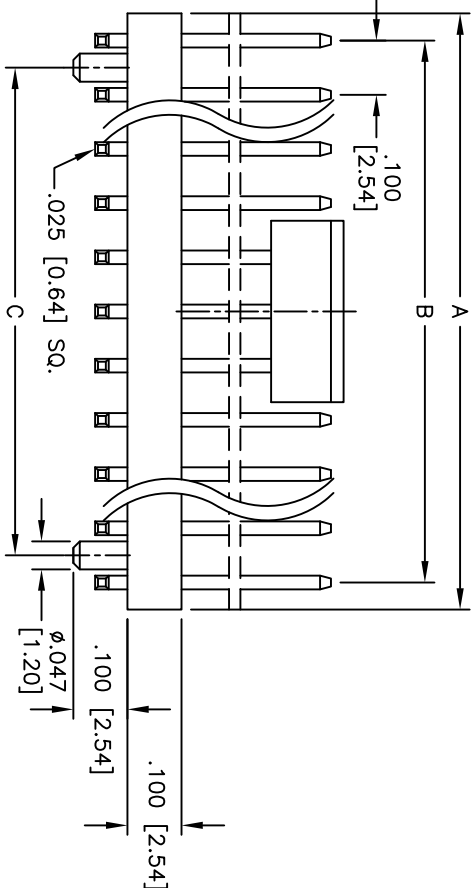

PACKAGED ON TAPE & REEL

Positions: 6 thru 80
 A = .100 [2.54] x No. of Positions per row
 B = .100 [2.54] x No. of Spaces
 C = .100 [2.54] x No. of Positions per row -.200 [5.08]

ADAM TECH

909 Rahway Avenue, Union, NJ 07083
 Phone: 908-687-5000 Fax: 908-687-5710

100 [2.54] DUAL ROW PIN HEADER
 SMT TYPE, SEL GOLD PLATED

SPECIFICATIONS:
 Material: Hi-temp thermoplastic, rated UL 94V-0
 Insulator color: Black
 Contacts: Copper Alloy
 Plating: Gold flash over Nickel underplate on contact area, Tin over Copper underplate on tails.
 Electrical:
 Current rating: 3 Amp max
 Contact resistance: 20 mohms max
 Insulation resistance: 1,000 Mohms min
 Dielectric withstanding voltage: 600 VAC for 1 minute
 Temperature Rating: Operating temperature: -40°C to +105°C
 Environmental:
 Lead free, RoHS compliant
 Recommended soldering temp: 260°C for 5 seconds



UNLESS OTHERWISE SPECIFIED ALL DIMENSIONS ARE INCHES [MM]	
.X	± .10
.XX	± .020
.XXX	± .015
.XXX	± .010
APPROVALS	
DRAWN	DY
CHECKED	
APPROVED	

TITLE		PART NO.	
100 [2.54] DUAL ROW PIN HEADER		PH2-XX-SG-SMT-.320/.150-P-PP-T/R	
SMT TYPE, SEL GOLD PLATED			
REF:	S00032T	SCALE:	NIS
SHEET	1 OF 1	REV.	-