

Rev	AWO #	Description	Date	Appr
-		RELEASED	1/19/11	

APPROVED: _____
 DATE: _____ TITLE: _____

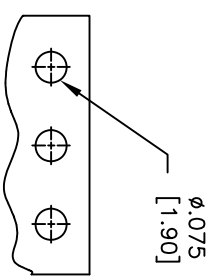
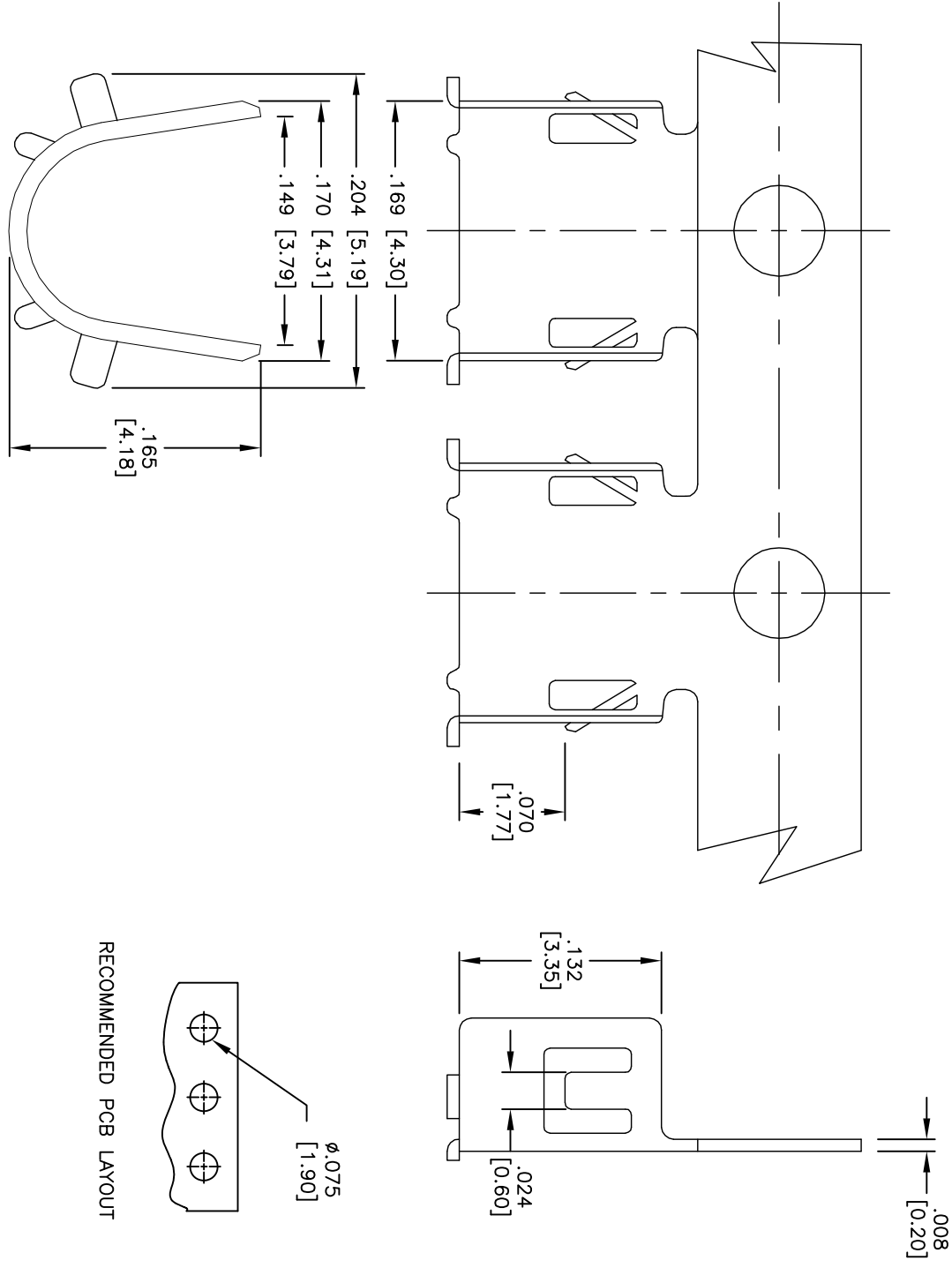

RECOMMENDED PCB LAYOUT

SPECIFICATIONS:

Material: Brass bronze
 Plating: Matte tin Plated
 Insulation O.D.: 4.0 ~ 5.1MM
 Wire Range: AWG#10~#12
 Environmental:
 Lead free, RoHS compliant.



UNLESS OTHERWISE SPECIFIED
 ALL DIMENSIONS ARE INCHES [MM]
 TOLERANCES: EXCEPT AS NOTED

INCHES	HOLES
.X ± .10	ØX ± .10
.XX ± .020	ØXXX ± .015
.XXX ± .015	ØXXX ± .010

APPROVALS

DATE	DATE
AY	1/19/11

DRAWN: JL
 CHECKED: JL
 APPROVED:

ADAM TECH
 909 Rahway Avenue, Union, NJ 07083
 Phone: 908-687-5000 Fax: 908-687-5710

TITLE	PCB CRIMP TERMINAL, MATTE TIN PLATED		
SIZE	PART NO.	SCALE	REV.
X	PCT-015-MT	NTS	-
REF: S0063T			SHEET 1 OF 1