

Rev	AWO #	Description	Date	Appr
-		RELEASED	02/21/05	

APPROVED: _____
 DATE: _____ TITLE: _____

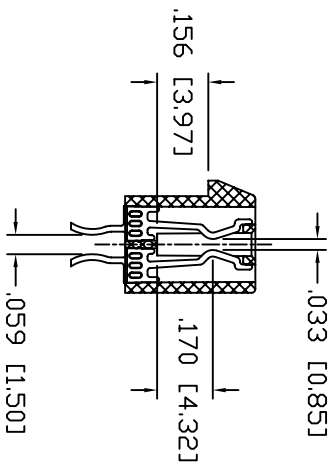
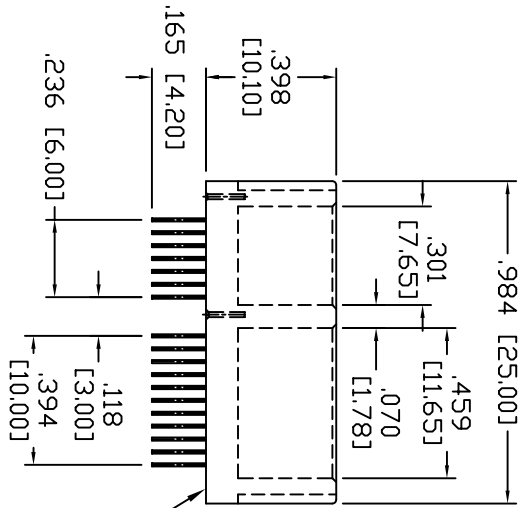
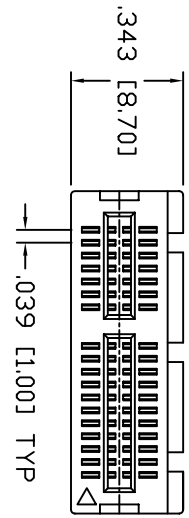

CAV. NO.
A~H

SPECIFICATIONS:

- Material: Insulator: Nylon 66, 30% glass reinforced, rated UL 94V-0
- Insulator color: Black
- Contacts: Brass or Phosphor Bronze
- Plating: Gold Flash over Nickel underplate on contact area, Tin over Copper underplate on tails
- Electrical: Operating voltage: 125 VAC max
Current rating: 1.1 Amps max
Contact Resistance: 30 mohms max
Insulation resistance: 1000 Mohms min @ 500V AC
Dielectric withstanding voltage: 500 VAC for 1 minute
- Mechanical: Insertion force: 1.15N max per contact pair
Withdrawal force: 0.15N min per contact pair
Contact retention force: 4.9N min per contact
Temperature Rating: Operating temperature: -55°C to +105°C

ADAM TECH

909 Rahway Avenue, Union, NJ 07083
 Phone: 908-687-5000 Fax: 908-687-5710

PCI EXPRESS CARD CONNECTOR, 36 PIN,
 STRADDLE MOUNT, GOLD FLASH

UNLESS OTHERWISE SPECIFIED ALL DIMENSIONS ARE INCHES [MM]	
TOLERANCES: EXCEPT AS NOTED	
INCHES	HOLES
.X ± .10	ØXX ± .10
.XX ± .020	ØXXX ± .015
.XXX ± .015	ØXXXX ± .010
APPROVALS	DATE
DRAWN SS	02/21/05
CHECKED	
APPROVED	

TITLE	PCI EXPRESS CARD CONNECTOR, 36 PIN, STRADDLE MOUNT, GOLD FLASH
SIZE	X
PART NO.	PCI-E-36-U-SM-HT
SCALE:	NTS
SHEET	1 OF 2

6 5 4 3 2 1