

Rev	AWO #	Description	Date	Appr
-		RELEASED	02/21/05	

APPROVED: _____
 DATE: _____ TITLE: _____

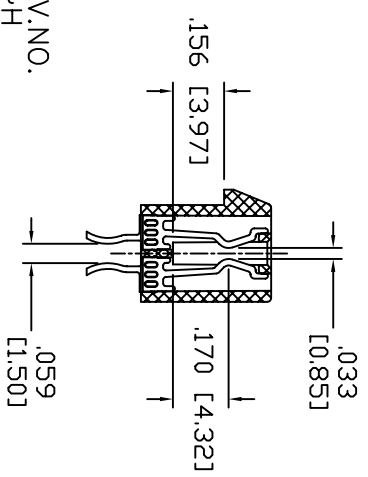
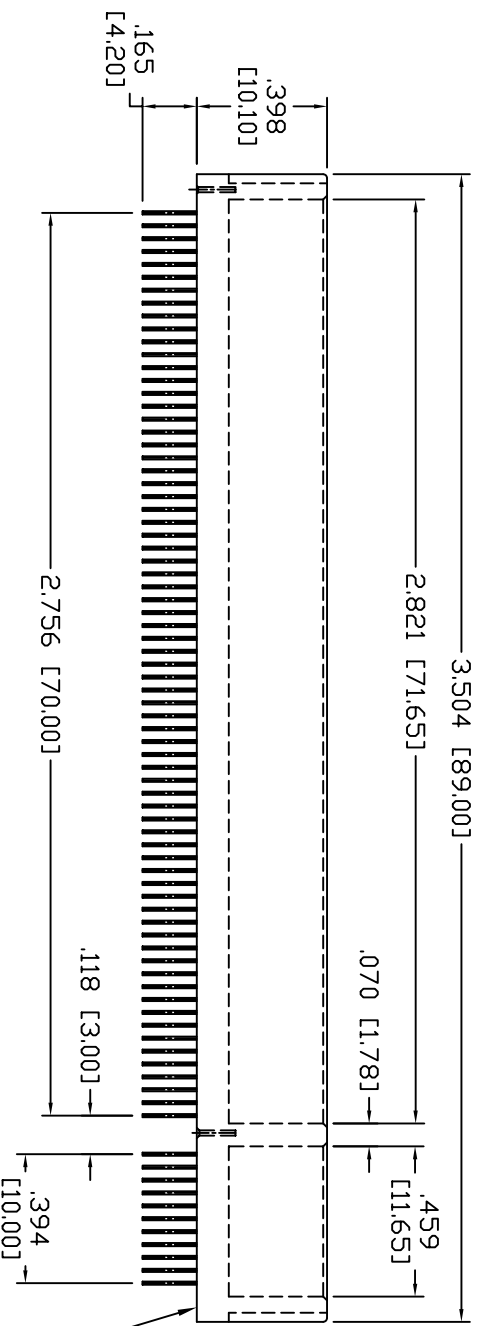
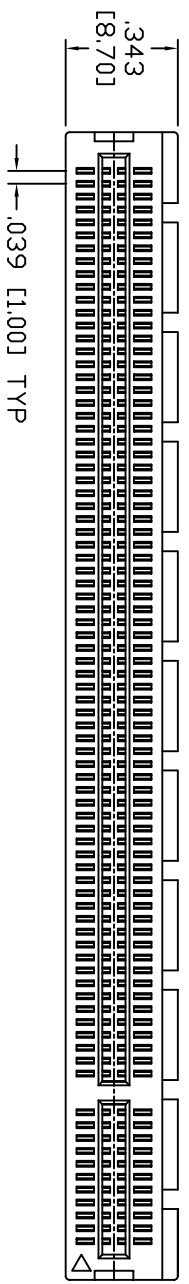

SPECIFICATIONS:
 Material:
 Insulator: PBT, 30% glass reinforced, rated UL 94V-0
 Insulator color: Black
 Contacts: Brass or Phosphor Bronze
 Plating:
 Gold Flash over Nickel underplate on contact area,
 Tin over Copper underplate on tails
 Electrical:
 Operating voltage: 125 VAC max
 Current rating: 1.1 Amps max
 Contact Resistance: 30 mohms max
 Insulation resistance: 1000 Mohms min @ 500V AC
 Dielectric withstanding voltage: 500 VAC for 1 minute
 Mechanical:
 Insertion force: 1.15N max per contact pair
 Withdrawal force: 0.15N min per contact pair
 Contact retention force: 4.9N min per contact
 Temperature Rating:
 Operating temperature: -55°C to +105°C

ADAM TECH

909 Rahway Avenue, Union, NJ 07083
 Phone: 908-687-5000 Fax: 908-687-5710

TITLE: PCI EXPRESS CARD CONNECTOR, 164 PIN,
 STRADDLE MOUNT, GOLD FLASH

UNLESS OTHERWISE SPECIFIED ALL DIMENSIONS ARE INCHES [MM]	
TOLERANCES: EXCEPT AS NOTED	
INCHES	HOLES
.X ±.10	ØX ±.10
.XX ±.020	ØXX ±.015
.XXX ±.015	ØXXX ±.010
APPROVALS	DATE
DRAWN SS	02/21/05
CHECKED	
APPROVED	

SIZE	PART NO.	REV.
X	PCI-E-164-U-SM	-
REF:	SCALE: NTS	SHEET 1 OF 2