

Rev	AWO #	Description	Date	Appr
-		RELEASED	1/15/10	

APPROVED: \_\_\_\_\_  
 DATE: \_\_\_\_\_ TITLE: \_\_\_\_\_

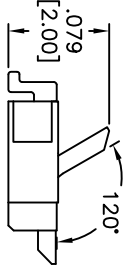
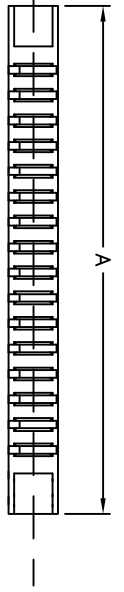
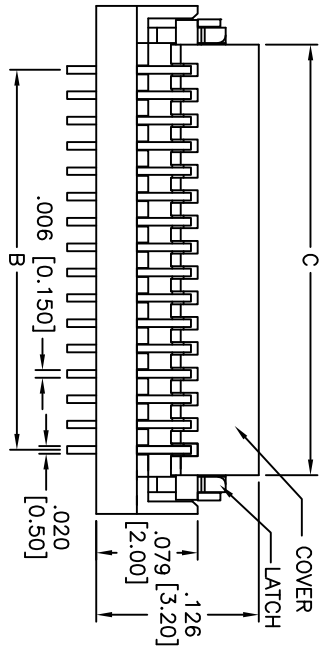

Positions: 4 thru 40  
 A = B + .098 [2.50]  
 B = .020 [0.50] x No. of Spaces  
 C = B + .039 [1.00]  
 D = B + .073 [1.85]  
 E = B + .039 [1.00]

SPECIFICATIONS:  
 Material: Housing: LCP, rated UL 94V-0, color Natural  
 Cover: PPS, color Black  
 Contact: Phosphor Bronze  
 Latch: Phosphor Bronze  
 Plating: Tin over Copper underplate overall  
 Electrical: Operating voltage: 50 VAC max  
 Current rating: 0.4 Amps max  
 Temperature Rating: Operating temperature: -55°C to +85°C  
 Environmental: Lead free, RoHS compliant.  
 Recommended soldering temp: 260°C for 5 sec.

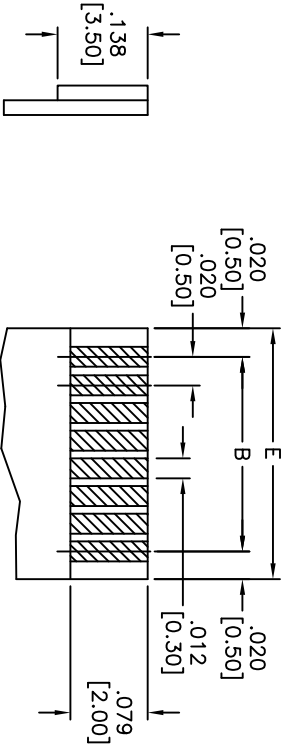
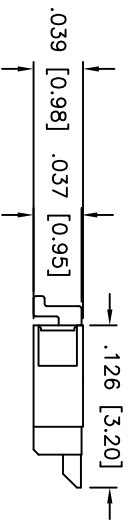
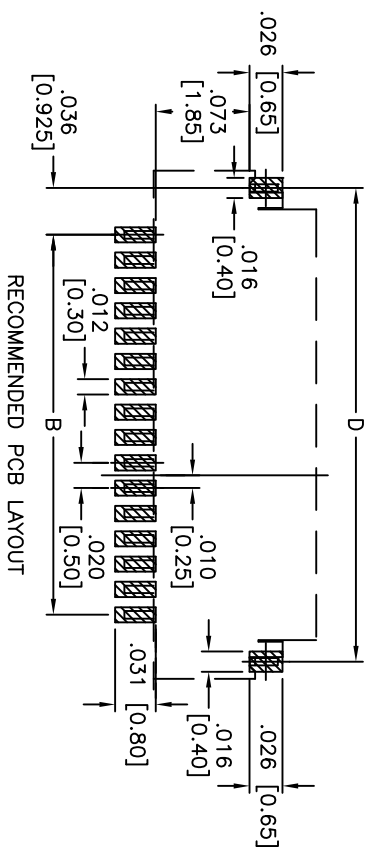

FFC/FPC DIMENSION

A

B

C

D

**ADAM TECH**  
 909 Rahway Avenue, Union, NJ 07083  
 Phone: 908-687-5000 Fax: 908-687-5710

TITLE: ZIF FLEX CIRCUIT CONNECTOR, 0.50 MM PITCH  
 EASY-ON TYPE, SMT, BOTTOM CONTACT

UNLESS OTHERWISE SPECIFIED ALL DIMENSIONS ARE IN INCHES [MM]	
TOLERANCES: EXCEPT AS NOTED	HOLDS
.X ± .10	ØXX ± .10
.XX ± .020	ØXXX ± .015
.XXX ± .015	ØXXXX ± .010
APPROVALS	DATE
DRAWN	DY
CHECKED	
APPROVED	

SIZE: X  
 PART NO.: PCA-6E-XX-HL-3  
 REF: S00030T  
 SCALE: NTS  
 SHEET 1 OF 1

A

B

C

D

6 5 4 3 2 1

