

Rev	AWO #	Description	Date	Appr
-		RELEASED	5/18/05	

APPROVED: \_\_\_\_\_ TITLE: \_\_\_\_\_  
 DATE: \_\_\_\_\_

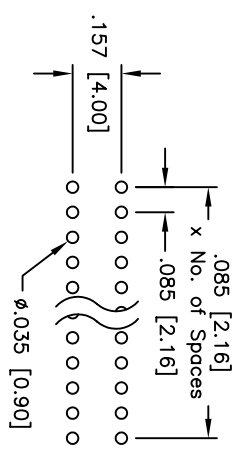

RECOMMENDED  
PCB LAYOUT

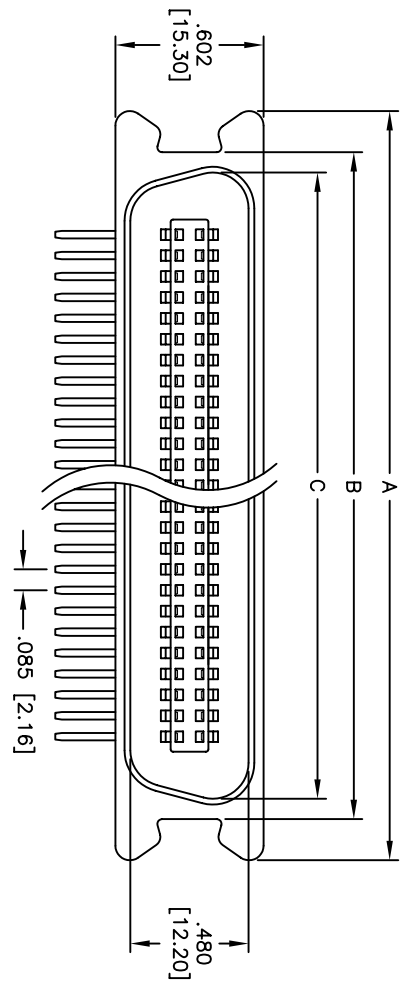
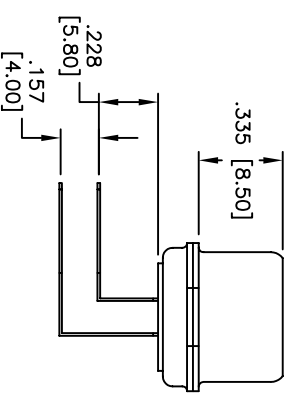
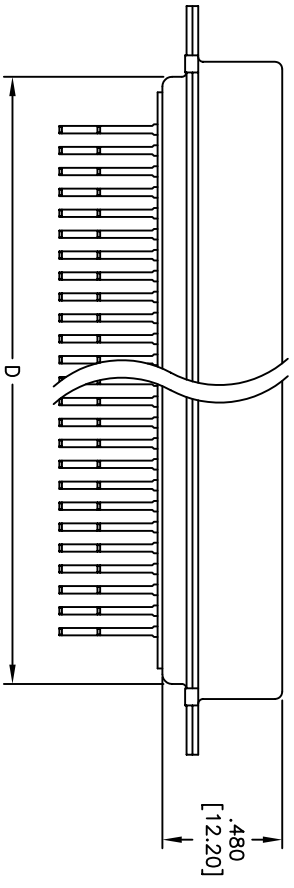

MRXX	NO. OF CONTACTS	DIMENSIONS			
		A	B	C	D
MR14	14	1.516 [38.50]	1.157 [29.40]	1.00 [25.50]	.893 [22.70]
MR24	24	1.941 [49.30]	1.583 [40.20]	1.430 [36.30]	1.318 [33.50]
MR36	36	2.441 [62.00]	2.106 [53.50]	1.941 [49.30]	1.834 [46.60]
MR50	50	3.047 [77.40]	2.689 [68.30]	2.535 [64.40]	2.437 [61.90]

**SPECIFICATIONS:**

Material: Insulator: PBT, glass reinforced, rated UL 94V-0  
 Insulator color: Blue  
 Contacts: Brass/Phosphor Bronze  
 Shell: Steel, Nickel plated  
 Plating: Gold flash over Nickel underplate on mating area, Tin over Copper underplate on tails  
 Electrical: Operating voltage: 250 VAC max  
 Current rating: 5 Amps max  
 Contact resistance: 35 Mohms max  
 Insulation resistance: 1,000 Mohms min  
 Dielectric withstanding voltage: 1,000 VAC for 1 minute  
 Temperature Rating: Operating temperature: -55°C to +105°C  
 Environmental: Lead free, RoHS compliant  
 Recommended soldering temp: 230°C for 5 seconds



**ADAM TECH**

909 Railway Avenue, Union, NJ 07083  
 Phone: 908-687-5000 Fax: 908-687-5710

MINIATURE RIBBON PLUG  
 RIGHT ANGLE PCB, NOTCH EARS

UNLESS OTHERWISE SPECIFIED ALL DIMENSIONS ARE INCHES [MM] TOLERANCES: EXCEPT AS NOTED		TITLE	
INCHES	HOLES	MINIATURE RIBBON PLUG	
.X ± .10	ØXX ± .10	RIGHT ANGLE PCB, NOTCH EARS	
.XX ± .020	ØXXX ± .015	SIZE	PART NO.
.XXX ± .015	ØXXXX ± .010	X	MRXX-PD-2
APPROVALS	DATE	REF:	SCALE: NTS
DRAWN	SS	5/18/05	
CHECKED			
APPROVED			