

Rev	AWO #	Description	Date	Appr
-		RELEASED	2/08/10	

APPROVED: _____
 DATE: _____ TITLE: _____

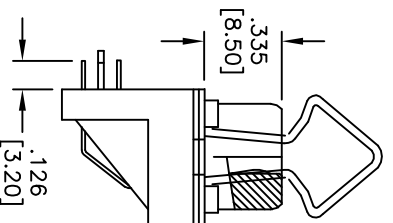
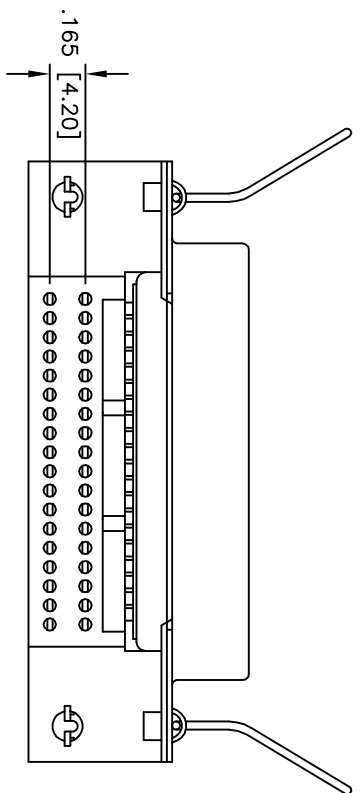
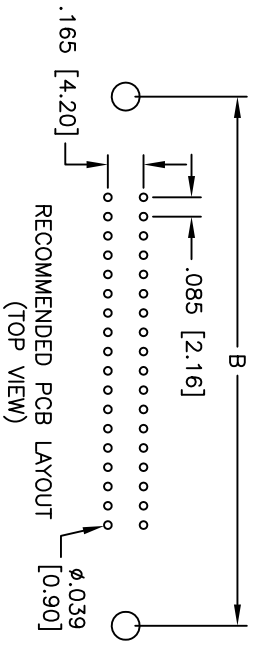
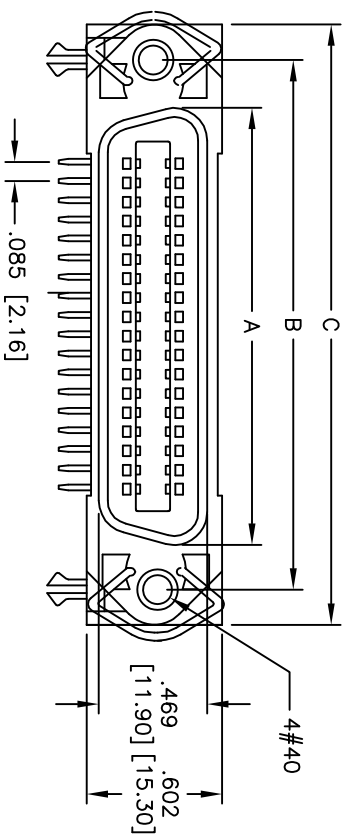

SPECIFICATIONS:

Material: Insulator: PBT, glass reinforced, rated UL 94V-0
 Insulator color: Black
Contacts: Copper Alloy
 Shell: Steel, Nickel plated
 Hood: Steel, Nickel plated
Plating: Gold flash over Nickel underplate on mating area, Tin over Copper underplate on tails
Electrical: Current rating: 5 Amp max
 Contact resistance: 25 mohms max
 Insulation resistance: 1,000 Mohms min
 Dielectric withstanding voltage: 1,000 VAC for 1 minute
Temperature Rating: Operating temperature: -55°C to +105°C
Environmental: Lead free, RoHS compliant
 Recommended soldering temp: 235°C for 5 seconds

PART NO.	A	B	C
MR14-SD-14-F-BK-LI-15	.992 [25.20]	1.417 [36.00]	1.728 [43.90]
MR24-SD-14-F-BK-LI-15	1.417 [36.00]	1.843 [46.80]	2.154 [54.70]
MR36-SD-14-F-BK-LI-15	1.925 [48.90]	2.350 [59.70]	2.665 [67.70]
MR50-SD-14-F-BK-LI-15	2.524 [64.10]	2.949 [74.90]	3.260 [82.80]

UNLESS OTHERWISE SPECIFIED
 ALL DIMENSIONS ARE INCHES [MM]
 TOLERANCES: EXCEPT AS NOTED
 INCHES: .X ± .10 ØXX ± .10
 .XX ± .020 ØXXX ± .015
 .XXX ± .015 ØXXXX ± .010
 APPROVALS: _____ DATE: _____
 DRAWN: DY 2/08/10
 CHECKED: _____
 APPROVED: _____

ADAM TECH

909 Rahway Avenue, Union, NJ 07083
 Phone: 908-687-5000 Fax: 908-687-5710

TITLE: MINIATURE RIBBON SOCKET, RIGHT ANGLE
 SPRING LATCHES WITH 4-40 CLINCH NUT

SIZE	PART NO.	REV.
X	MRXX-SD-14-F-BK-LI	-
REF: S00033T	SCALE: NTS	SHEET 1 OF 1

