

Rev	AWO #	Description	Date	Appr
-		RELEASED	9/16/04	

APPROVED: \_\_\_\_\_  
 DATE: \_\_\_\_\_ TITLE: \_\_\_\_\_

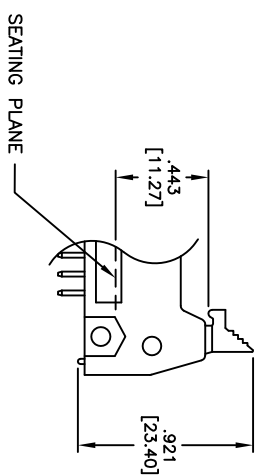
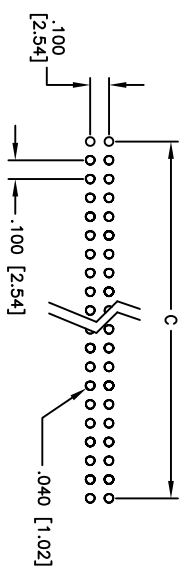
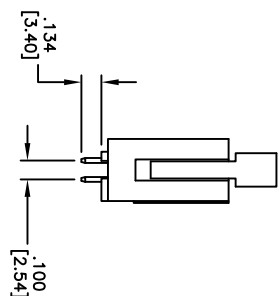
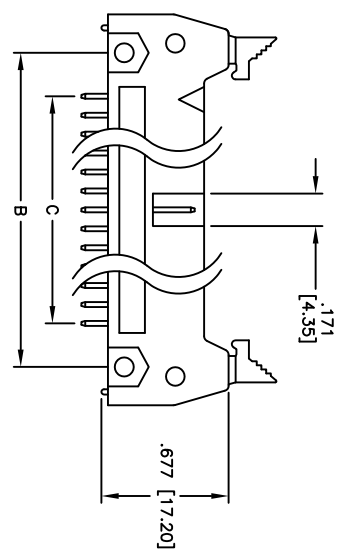
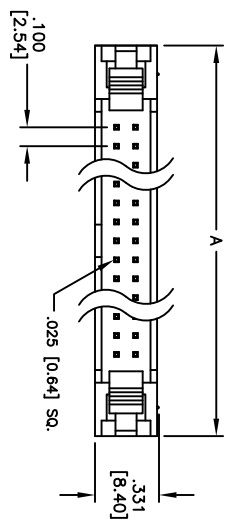

Positions: 10, 14, 16, 20, 24, 26, 30, 34, 40, 50, 60, 64  
 A = .100 [2.54] x No. of Spaces + .860 [21.84]  
 B = .100 [2.54] x No. of Spaces + .460 [11.68]  
 C = .100 [2.54] x No. of Spaces

**SPECIFICATIONS:**

- Material: PBT, glass reinforced, rated UL 94V-0, color black
- Insulator: Brass
- Contacts: Tin over Copper underplate overall.
- Electrical:
  - Operating voltage: 250 VAC max
  - Current rating: 3 Amps max
  - Contact Resistance: 20 mohm max
  - Insulation resistance: 5000 Mohm min
  - Dielectric withstanding voltage: 1000 VAC
- Mechanical:
  - Mating durability: 500 cycles min
  - Temperature Rating: -55°C to +105°C
  - Operating temperature: -55°C to +105°C
  - Environmental: Lead free, ROHS compliant.
  - Recommended soldering temp: 235°C for 5 sec.



UNLESS OTHERWISE SPECIFIED ALL DIMENSIONS ARE MM [INCHES]	
TOLERANCES: EXCEPT AS NOTED	
INCHES	HOLDS
.X ± .10	ØX ± .10
.XX ± .020	ØXX ± .015
.XXX ± .015	ØXXX ± .010
APPROVALS	DATE
DRAWN SS	9/16/04
CHECKED	
APPROVED	

**ADAM TECH**  
 909 Rahway Avenue, Union, NJ 07083  
 Phone: 908-687-5000 Fax: 908-687-5710

TITLE: LATCH BOX HEADER, STRAIGHT  
 PCB TYPE, TIN PLATED

SIZE	PART NO.	MHR-XX-VTAS	REV:Y
X			
REF: S00089T	SCALE: NTS	SHEET 1 OF 1	