

Rev	AWO #	Description	Date	Appr
-		RELEASED	1/03/10	

APPROVED: _____
 DATE: _____ TITLE: _____

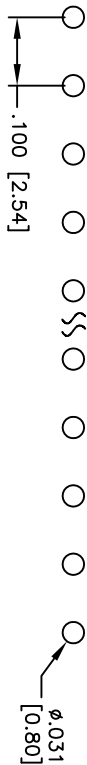

RECOMMENDED PCB LAYOUT

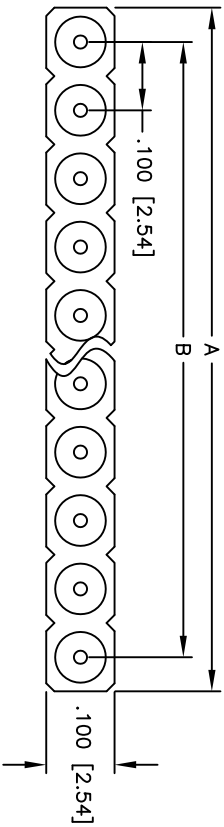
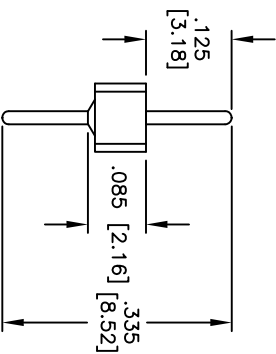
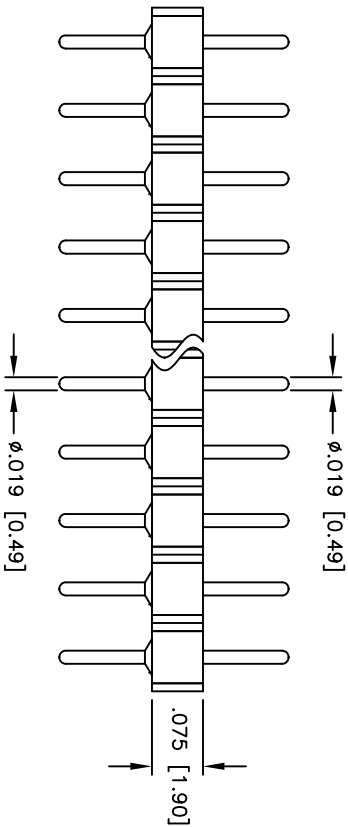

Positions: 1 thru 40
 A = .100 [2.54] x No. of Positions
 B = .100 [2.54] x No. of Spaces

SPECIFICATIONS:
 Material: PPS, Glass reinforced, rated UL 94V-0
 Insulator: Brass
 Contacts: Brass
 Plating: Gold over Nickel underplate overall
 Electrical: Gold over Nickel underplate overall
 Current rating: 3 Amp max
 Contact resistance: 10 mohms Max
 Dielectric Strength: Min 1000V/RMS
 Temperature Rating: Operating temperature: -40°C to +105°C
 Environmental: Lead free, RoHS compliant
 Recommended soldering temp: 235°C for 5 seconds



UNLESS OTHERWISE SPECIFIED ALL DIMENSIONS ARE IN INCHES [MM]	
TOLERANCES: EXCEPT AS NOTED	
INCHES	HOLE
.X ± .10	ØXX ± .10
.XX ± .020	ØXXX ± .015
.XXX ± .015	ØXXX ± .010
APPROVALS	DATE
DRAWN	DY
CHECKED	
APPROVED	

ADAM TECH
 909 Rahway Avenue, Union, NJ 07083
 Phone: 908-687-5000 Fax: 908-687-5710
 TITLE: SCREW MACHINE TERMINAL STRIP, SINGLE ROW
 STRAIGHT, .100" SPACING, GOLD PLATED

SIZE	PART NO.	REV.
X	MCT-1-XX-.125/.335-G-L	-
REF:	S00007T	SHEET 1 OF 1
SCALE:	NTS	