

Rev	AWO #	Description	Date	Appr
-		RELEASED	1/20/10	

APPROVED: _____
 DATE: _____ TITLE: _____

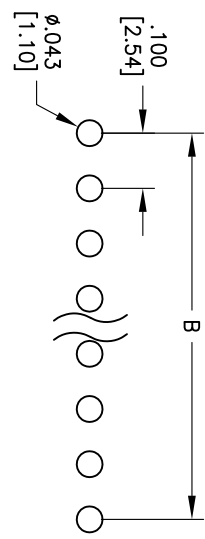

Recommended PCB Layout

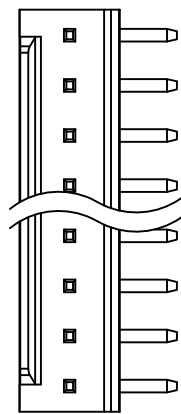
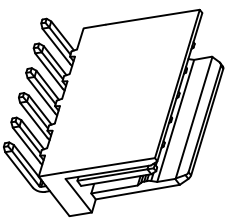
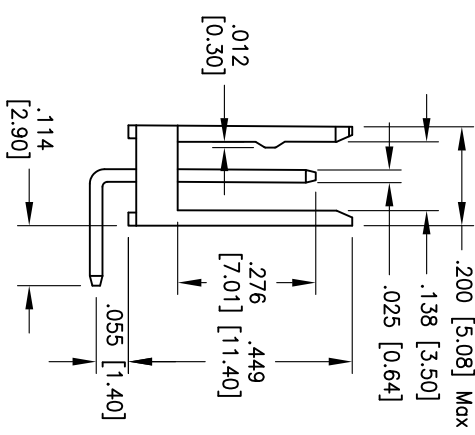
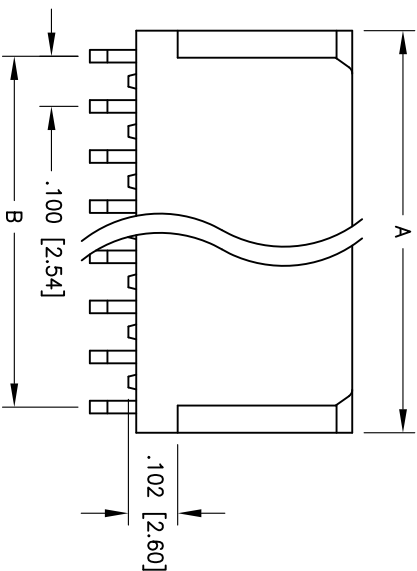

SPECIFICATIONS:

Material: Nylon 66, rated UL 94V-0
 Insulator color: Black
 Contacts: Copper Alloy
 Plating:
 Tin over Copper underplate overall.

Electrical:
 Operating voltage: 250 VAC max
 Current rating: 3 Amps max
 Contact resistance: 20 mohms max
 Insulation resistance: 1,000 Mohms min
 Dielectric withstanding voltage: 1,000 VAC for 1 minute
 Temperature Rating:
 Operating temperature: -25°C to +105°C

Environmental:
 Lead free, RoHS compliant
 Recommended soldering temp: 235°C for 5 seconds

Positions: 2 thru 20
 A = .100 [2.54] x No. of Positions
 B = .100 [2.54] x No. of Spaces

ADAM TECH

909 Rahway Avenue, Union, NJ 07083
 Phone: 908-687-5000 Fax: 908-687-5710

.100 [2.54] LOCKING HEADER, LONG BACK,
 RIGHT ANGLE, TIN PLATED, PCB

UNLESS OTHERWISE SPECIFIED ALL DIMENSIONS ARE INCHES [MM] TOLERANCES: EXCEPT AS NOTED		INCHES		HOLES	
X	± .10	Ø X	± .10	Ø XXX	± .015
.XX	± .020	Ø .XX	± .015	Ø .XXX	± .010
.XXX	± .015	Ø .XXX	± .010		
APPROVALS		DATE			
DRAWN	DY	1/20/10			
CHECKED					
APPROVED					
TITLE		SIZE		PART NO.	
.100 [2.54] LOCKING HEADER, LONG BACK, RIGHT ANGLE, TIN PLATED, PCB		X		LHA-D-XX-TRA-V0	
REF: S00056T		SCALE: NTS		SHEET 1 OF 1	

