

Rev	AWO #	Description	Date	Appr
-		RELEASED	1/10/09	

APPROVED: _____ TITLE: _____
 DATE: _____

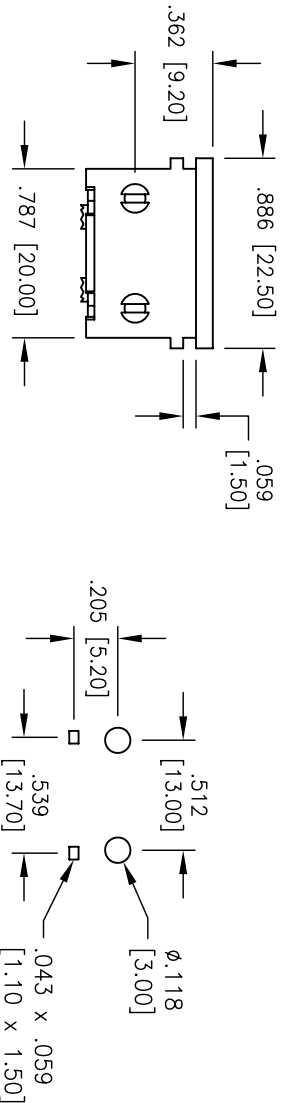

RECOMMENDED
PCB LAYOUT

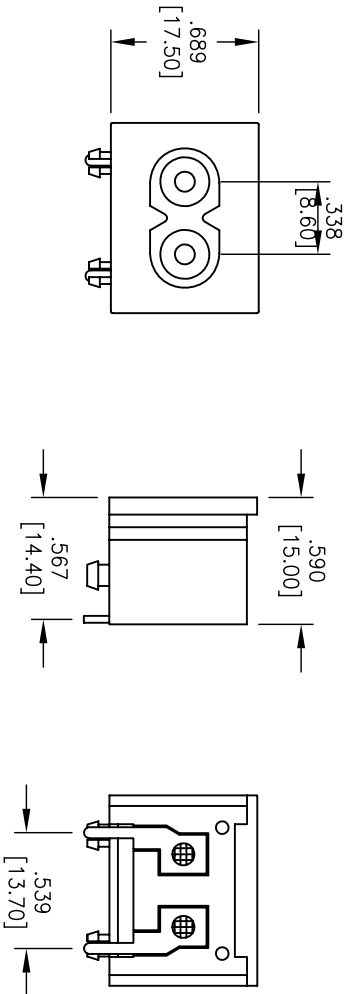
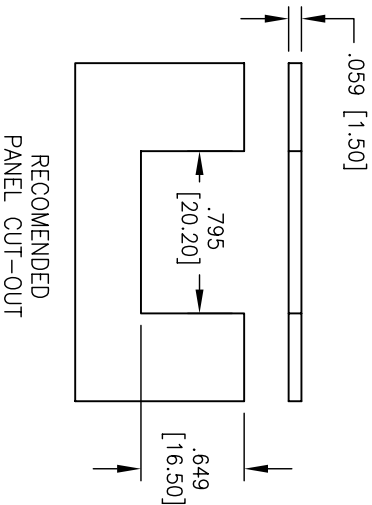

RECOMMENDED
PANEL CUT-OUT

SPECIFICATIONS:

Material: Insulator: Nylon 66, rated UL 94V-0
 Insulator color: Black
 Contacts: Phosphor Bronze, Tin Plated
 Electrical: Operation voltage: 250 VAC max
 Current rating: 2.5 Amps max
 Insulation resistance: 100 Mohms min @ 500 VDC
 Dielectric withstanding voltage: 2000 VAC for 1 minute
 Environmental: Lead free, RoHS Compliant

ADAM TECH

909 Rahway Avenue, Union, NJ 07083
 Phone: 908-687-5000 Fax: 908-687-5710

TITLE: IEC 60320, C8, RIGHT ANGLE,
 PC MOUNT, 1.5mm PANEL MOUNT

UNLESS OTHERWISE SPECIFIED ALL DIMENSIONS ARE MM [INCHES] TOLERANCES: EXCEPT AS NOTED		HOLE SIZE		DATE	
X	± .10	Ø X	± .10		
.XX	± .020	Ø.XX	± .015		
.XXX	± .015	Ø.XXX	± .010		
APPROVALS		DATE			
DRAWN	SS	5/4/04			
CHECKED					
APPROVED					
SIZE	PART NO.	REV.			
X	IEC-NBA-4	-			
REF:	SCALE: NTS	SHEET	1 OF 1		