

Rev	AWO #	Description	Date	Appr
-		RELEASED	6/7/05	

APPROVED: _____
 DATE: _____ TITLE: _____

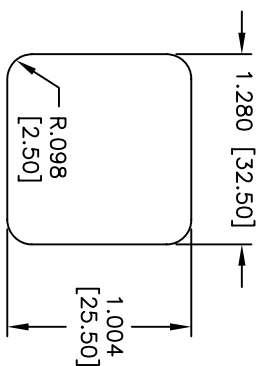
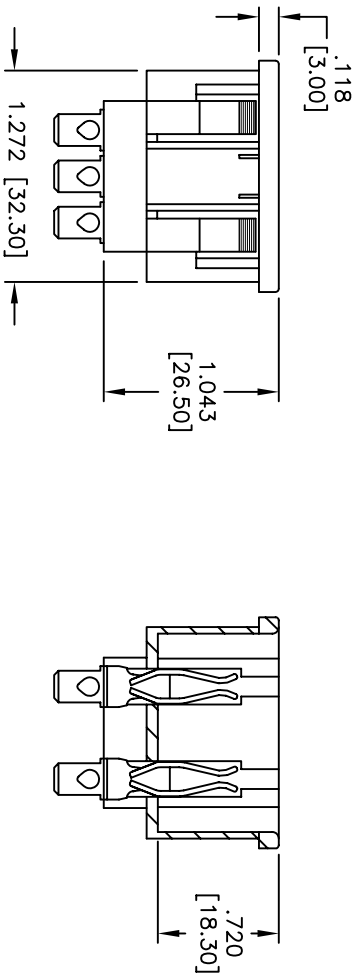
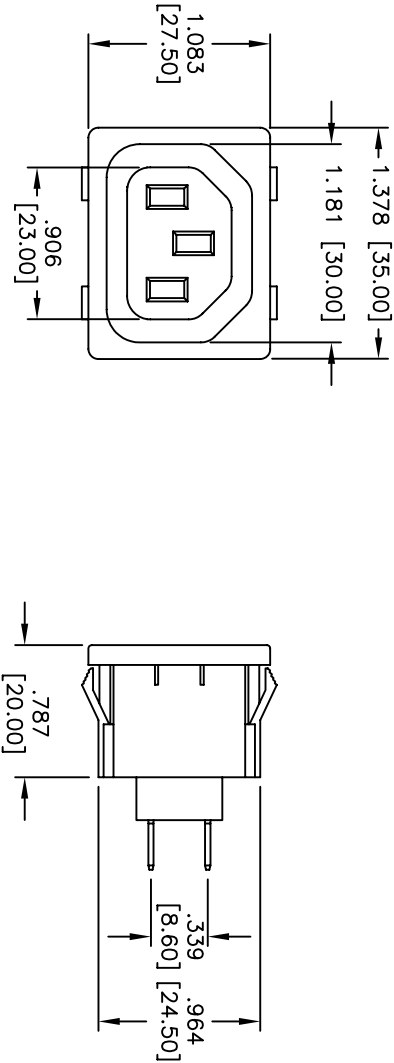

RECOMMENDED PANEL CUT-OUT
 THICKNESS: 0.8mm-1.8mm

TERMINAL OPTIONS		
-1	-2	-3

SPECIFICATIONS:

Material: Nylon 66, glass reinforced, rated UL 94V-0

Insulator color: Black

Contacts: Brass

Plating:

Tin over Copper underplate overall

Electrical:

Operating voltage: 250 VAC

Current rating: UL & CSA: 15 Amps max

VDE: 10 Amps max

Insulation resistance: 100 Mohms min @ 500 VDC

Dielectric withstanding voltage: 2,000 VAC for 1 minute

Temperature Rating:

Operating temperature: -25°C to +70°C

Environmental:

Lead free, RoHS compliant

Recommended soldering temp: 230°C for 5 seconds



ADAM TECH

909 Rahway Avenue, Union, NJ 07083
 Phone: 908-687-5000 Fax: 908-687-5710

TITLE: IEC FEMALE OUTLET
 SNAP-IN PANEL MOUNT

UNLESS OTHERWISE SPECIFIED ALL DIMENSIONS ARE IN INCHES [MM]	
TOLERANCES: EXCEPT AS NOTED	HOLDS
.X ± .10	ØX ± .10
.XX ± .020	ØXX ± .015
.XXX ± .015	ØXXX ± .010
APPROVALS	DATE
DRAWN SS	6/17/05
CHECKED	
APPROVED	

SIZE	PART NO.	REV.
X	IEC-D-X	-
REF:	SCALE: NTS	SHEET 1 OF 1

6 5 4 3 2 1