

Rev	AWO #	Description	Date	Appr
-		RELEASED	8/1/04	

APPROVED: _____

DATE: _____ TITLE: _____

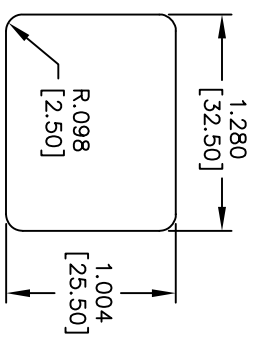
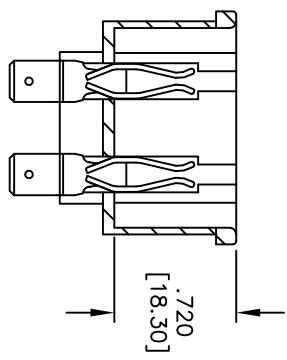
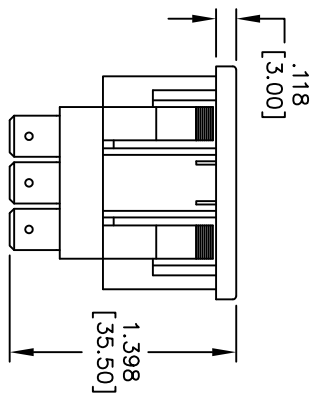
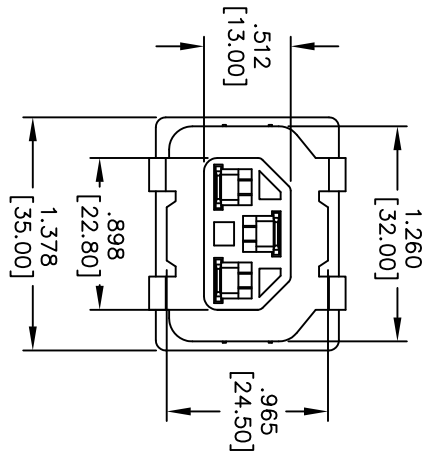
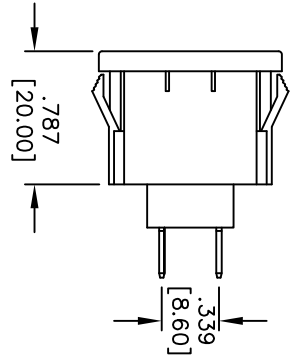
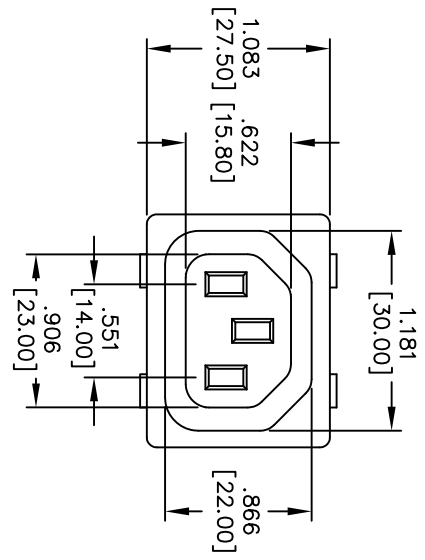

RECOMMENDED PANEL CUT-OUT THICKNESS: 0.80mm - 1.8mm

SPECIFICATIONS:

- Material: Nylon 66, glass reinforced, rated UL 94V-0
- Insulator color: Black
- Contacts: Brass
- Plating: Tin over Copper underplate overall
- Electrical: Operating voltage: 250 VAC
- Current rating: UL & CSA: 15 Amps max
- VDE: 10 Amps max
- Insulation resistance: 100 Mohms min @ 500 VDC
- Dielectric withstanding voltage: 2,000 VAC for 1 minute
- Temperature Rating: Operating temperature: -25°C to +70°C
- Environmental: Lead free, RoHS compliant



UNLESS OTHERWISE SPECIFIED ALL DIMENSIONS ARE MM [INCHES]	
TOLERANCES: EXCEPT AS NOTED	
INCHES	
.X ± .10	ØX ± .10
.XX ± .020	ØXX ± .015
.XXX ± .015	ØXXX ± .010
APPROVALS	DATE
SS	8/1/04

ADAM TECH

909 Railway Avenue, Union, NJ 07083
 Phone: 908-687-5000 Fax: 908-687-5710

TITLE: IEC C13 CONNECTOR, 250 QC
 TERMINALS, UNIVERSAL SNAP

DRAWN	SS	8/1/04	SIZE	PART NO.	REV.
CHECKED			X	IEC-D-2	
APPROVED			REF:	SCALE: NTS	SHEET 1 OF 1