

Rev	AWO #	Description	Date	Appr
-		RELEASED	12/01/10	

6

5

4

3

2

1

APPROVED: \_\_\_\_\_

DATE: \_\_\_\_\_ TITLE: \_\_\_\_\_

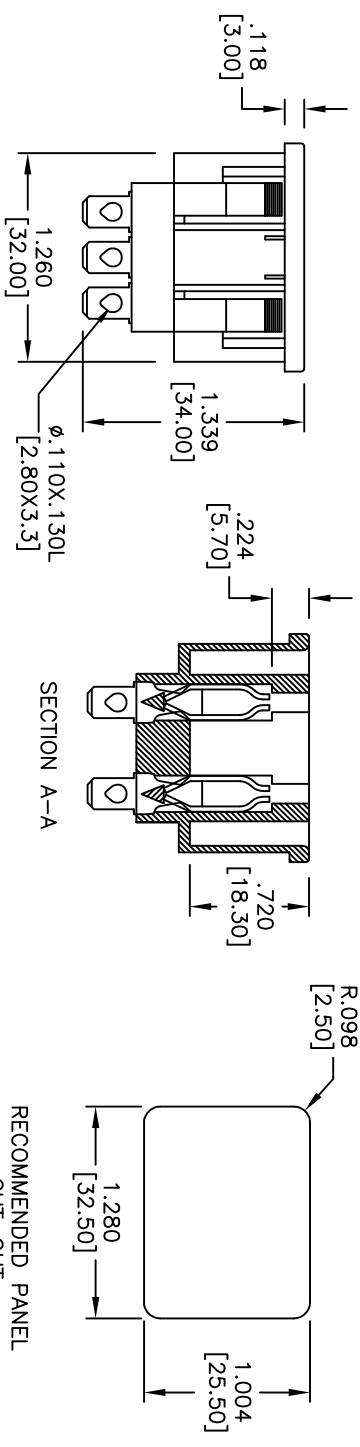
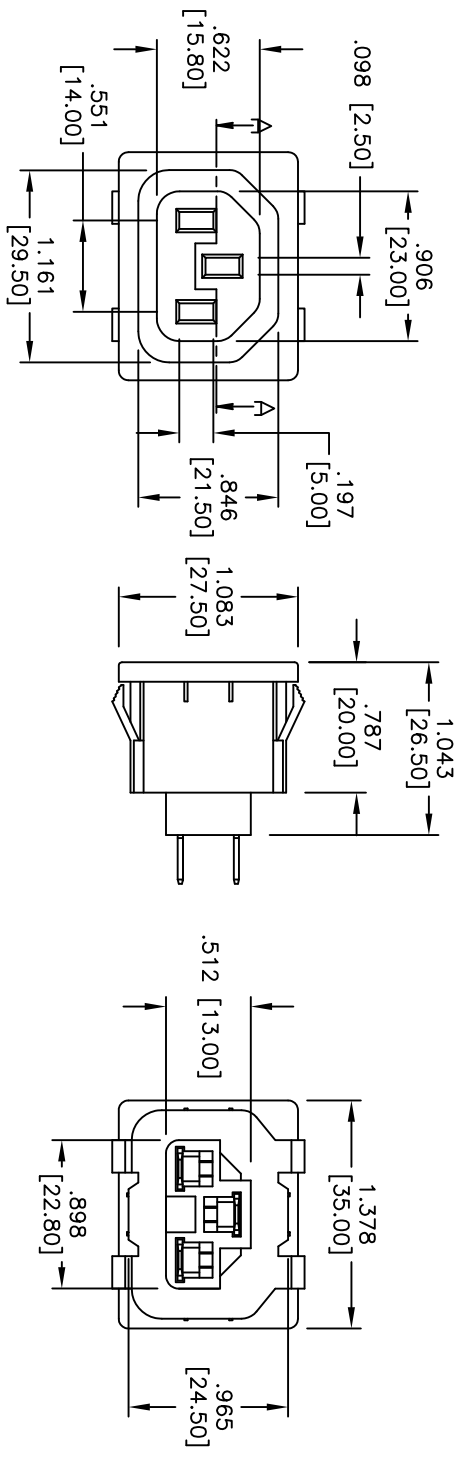

RECOMMENDED PANEL CUT-OUT

**SPECIFICATIONS:**

- Material: Insulator: Nylon 66, glass reinforced, rated UL 94V-0
- Insulator color: Black
- Contacts: Brass , Nickel plated
- Plating: Tin over Copper underplate overall
- Electrical: Operating voltage: 250 VAC
- Current rating: UL & CSA: 15 Amps max
- VDE: 10 Amps max
- Insulation resistance: 100 Mohms min @ 500 VDC
- Dielectric withstanding voltage: 2,000 VAC for 1 minute
- Temperature Rating: Operating temperature: -25°C to +70°C
- Environmental: Lead free, RoHS compliant

A

A

B

B

C

C

D

D

UNLESS OTHERWISE SPECIFIED ALL DIMENSIONS ARE INCHES [MM]	
TOLERANCES: EXCEPT AS NOTED	HOLDS
.X ± .10	ØX ± .10
.XX ± .020	ØXX ± .015
.XXX ± .015	ØXXX ± .010
APPROVALS	DATE
DRAWN DY	12/01/10
CHECKED	
APPROVED	

**ADAM TECH**  
909 Railway Avenue, Union, NJ 07083  
Phone: 908-687-5000 Fax: 908-687-5710

TITLE: IEC FEMALE OUTLET, SNAP-IN PANEL MOUNT, SPECIAL CONTACT

SIZE	PART NO.	REV.
X	IEC-D-1-EF-C2	-
REF: S00037T	SCALE: NTS	SHEET 1 OF 1

6

5

4

3

2

1