

Rev	AWO #	Description	Date	Appr
-		RELEASED	6/05/09	

APPROVED: _____
 DATE: _____ TITLE: _____

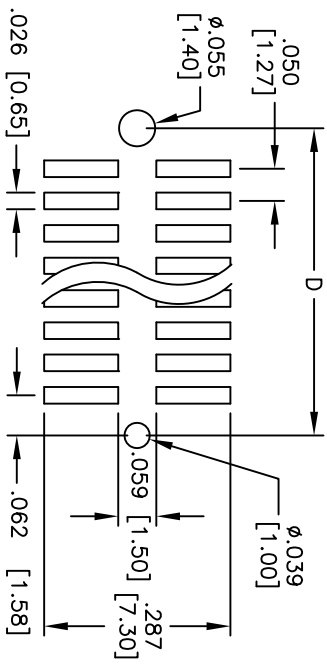

RECOMMENDED PCB LAYOUT

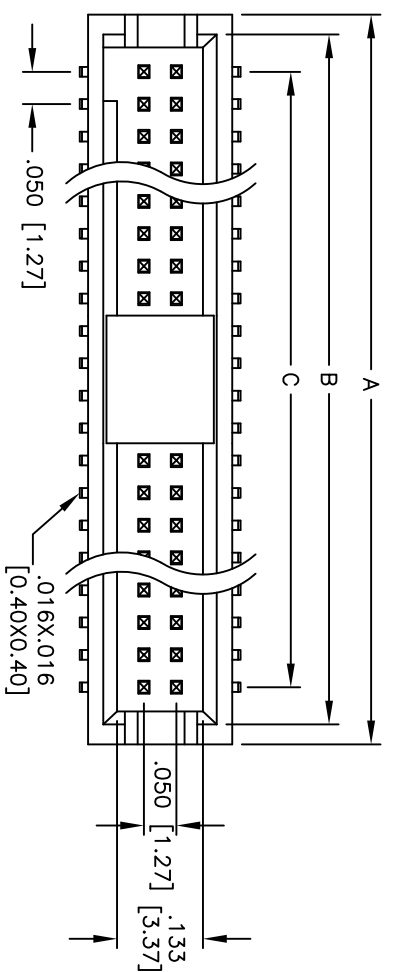
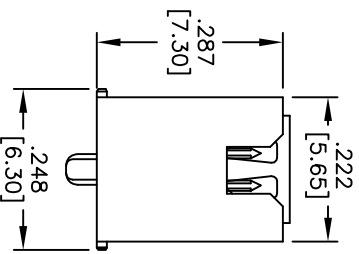
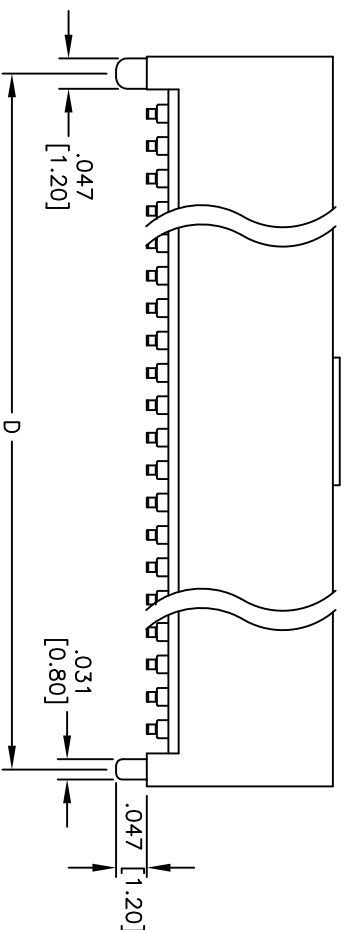

PACKAGED ON TAPE & REEL

Positions: 10 thru 120
 A = .050 [1.27] x No. of Positions per row + .126 [3.20]
 B = .050 [1.27] x No. of Positions per row + .024 [0.60]
 C = .050 [1.27] x No. of Spaces
 D = .050 [1.27] x No. of Positions per row + .074 [1.88]

ADAM TECH

909 Rahway Avenue, Union, NJ 07083
 Phone: 908-687-5000 Fax: 908-687-5710

TITLE: .050 [1.27] SHROUDED HEADER, DUAL ROW, SMT

SPECIFICATIONS:
 Material: Nylon 6T, rated UL 94V-0
 Insulator color: Black
 Contacts: Phosphor Bronze
 Plating:
 Gold flash over Nickel underplate on mating area,
 Tin over Copper underplate on SMT tails
 Electrical:
 Current rating: 1 Amp max.
 Contact resistance: 20 mohms max. initial
 Insulation resistance: 1,000 Mohms min.
 Dielectric withstanding voltage: 300 VAC for 1 minute
 Temperature Rating:
 Operating temperature: -40°C to +105°C
 Environmental:
 Lead free, RoHS compliant.
 Recommended soldering temp: 260°C for 5 seconds



UNLESS OTHERWISE SPECIFIED ALL DIMENSIONS ARE INCHES [MM]	
.X	± .10
.XX	± .020
.XXX	± .015
.XXX	± .015
TOLERANCES: EXCEPT AS NOTED	
INCHES	
ØX	± .10
ØXXX	± .015
ØXXX	± .010
APPROVALS	
DRAWN	DY
CHECKED	
APPROVED	
DATE	6/05/09

SIZE	PART NO.	REV.
X	HSHT-XX-SG-SMT-PP-T/R	-
REF: S00032T	SCALE: NTS	SHEET 1 OF 1