

Rev	AWO #	Description	Date	Appr
-		RELEASED	1/10/05	

APPROVED: \_\_\_\_\_  
 DATE: \_\_\_\_\_ TITLE: \_\_\_\_\_

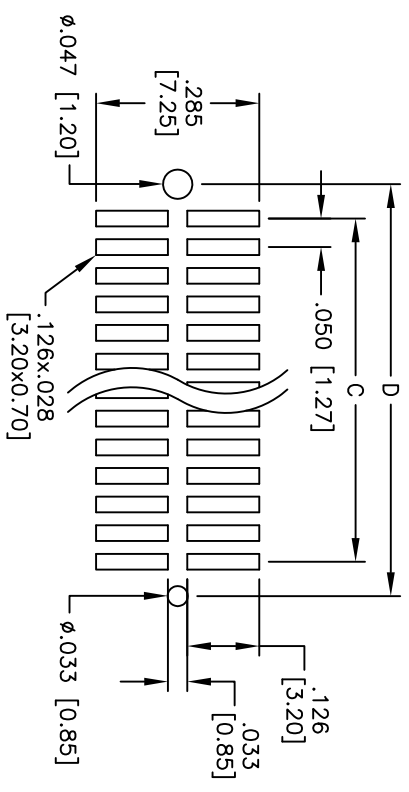

PCB LAYOUT

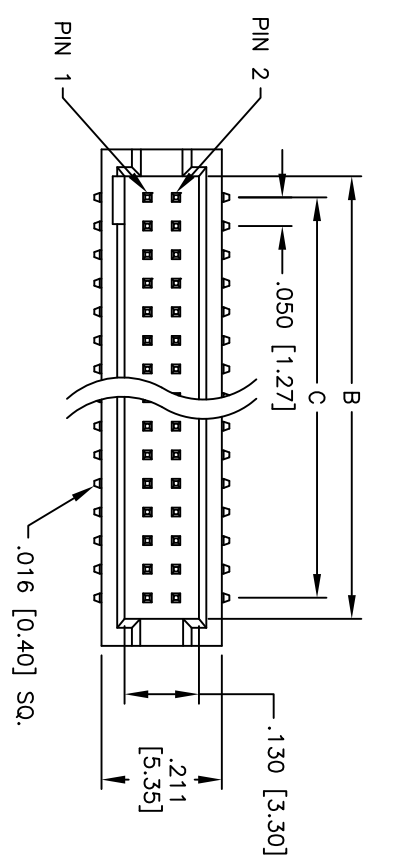
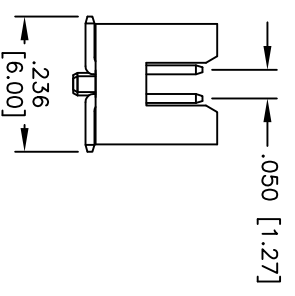
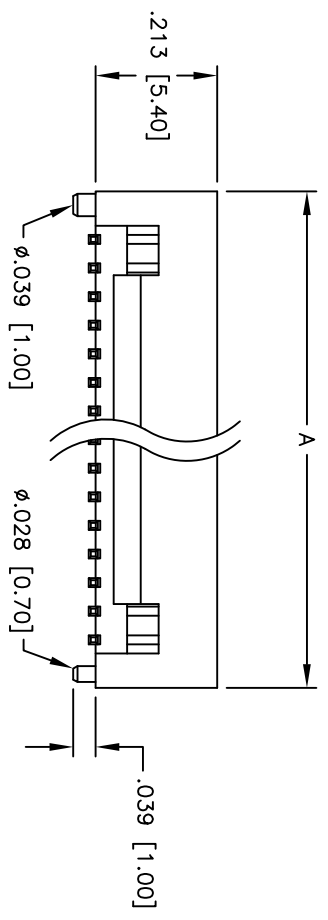

**SPECIFICATIONS:**

Material: Hi-temp thermoplastic, rated UL 94V-0  
 Insulator color: Black  
 Contacts: Brass  
 Plating: Tin over Copper underplate overall

Electrical:  
 Operating voltage: 250 VAC max.  
 Current rating: 1 Amp max.  
 Contact resistance: 20 mohms max. initial  
 Insulation resistance: 5,000 Mohms min.  
 Dielectric withstanding voltage: 1,000 VAC for 1 minute  
 Temperature Rating:  
 Operating temperature: -40°C to +105°C

Environmental:  
 Lead free, RoHS compliant.  
 Recommended soldering temp: 260°C for 5 sec.



Positions: 10 thru 100  
 A = .050 [1.27] x No. of Spaces + .168 [4.27]  
 B = .050 [1.27] x No. of Spaces + .074 [1.87]  
 C = .050 [1.27] x No. of Spaces  
 D = .050 [1.27] x No. of Spaces + .120 [3.05]

UNLESS OTHERWISE SPECIFIED  
 ALL DIMENSIONS ARE INCHES [MM]  
 TOLERANCES: EXCEPT AS NOTED  
 INCHES HOLE SIZES  
 .X ± .10 ØXX ± .10  
 .XX ± .020 ØXXX ± .015  
 .XXX ± .015 ØXXXX ± .010

**ADAM TECH**  
 909 Railway Avenue, Union, NJ 07083  
 Phone: 908-687-5000 Fax: 908-687-5710  
 TITLE: .050 [1.27] SHROUDED HEADER, SMT  
 VERTICAL

APPROVALS	DATE	SIZE	PART NO.	REV.
DRAWN	SS	1/10/05	HSH-XX-T-SMT	-
CHECKED	AY	7/28/10		
APPROVED				