

APPROVED: _____
 DATE: _____ TITLE: _____

Rev	AWO #	Description	Date	Appr
-		RELEASED	7/22/10	

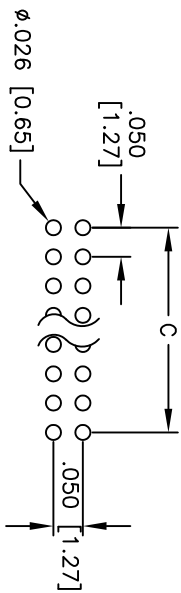
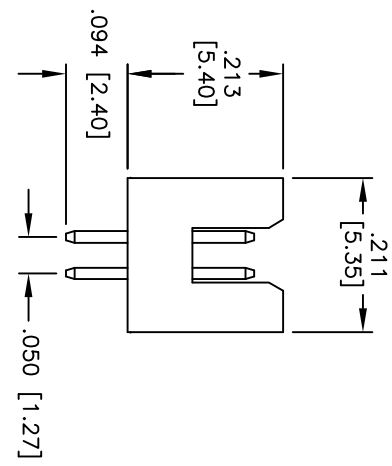
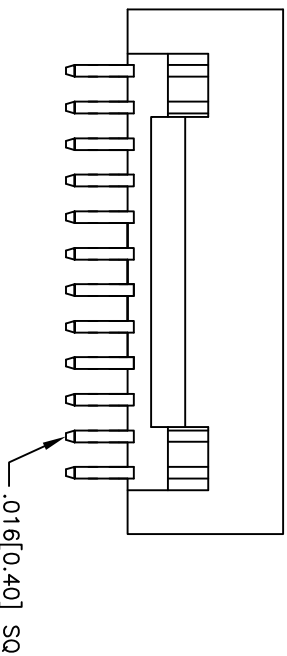
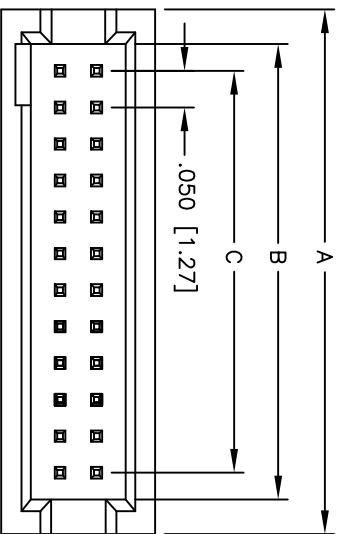

Recommended PCB Layout

PACKAGED ON TAPE & REEL

A = .050 [1.27] x No. of Positions Per Row + .126 [3.20]
 B = .050 [1.27] x No. of Positions Per Row + .024 [0.60]
 C = .050 [1.27] x No. of Spaces Per Row

ADAM TECH

909 Rahway Avenue, Union, NJ 07083
 Phone: 908-687-5000 Fax: 908-687-5710

TITLE: .050 [1.27] PITCH SHROUDED MALE HEADER
 DUAL ROW DIP TYPE, 10U" SEL GOLD PLATED

SPECIFICATIONS:
 Material: Insulator: Nylon 6T, rated UL 94V-0
 Insulator color: Black
 Contacts: Copper Alloy
 Plating: 10u" Gold flash over Nickel underplate on contact area, Tin over Copper underplate on tails.
 Electrical: Current rating: 1 Amp max.
 Contact resistance: 20 mohms max. initial
 Insulation resistance: 1,000 Mohms min.
 Dielectric withstanding voltage: 300 VAC for 1 minute
 Temperature Rating: Operating temperature: -40°C to +105°C
 Environmental: Lead free, RoHS compliant.
 Recommended soldering temp: 235°C for 5 seconds



UNLESS OTHERWISE SPECIFIED	
ALL DIMENSIONS ARE INCHES [MM]	
TOLERANCES: EXCEPT AS NOTED	
INCHES	HOLDS
.X ± .10	ØXX ± .10
.XX ± .020	ØXXX ± .015
.XXX ± .015	ØXXX ± .010
APPROVALS	DATE
DRAWN AY	7/22/10
CHECKED AH	7/23/10
APPROVED	

SIZE X	PART NO. HSH-XX-SG-10-TR	REV. A
REF: S00089T	SCALE: NTS	SHEET 1 OF 1