

Rev	AWO #	Description	Date	Appr
-		RELEASED	5/10/05	

APPROVED: \_\_\_\_\_  
 DATE: \_\_\_\_\_ TITLE: \_\_\_\_\_

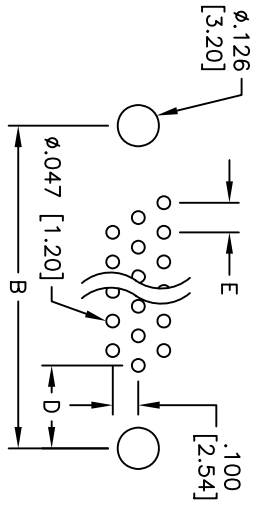
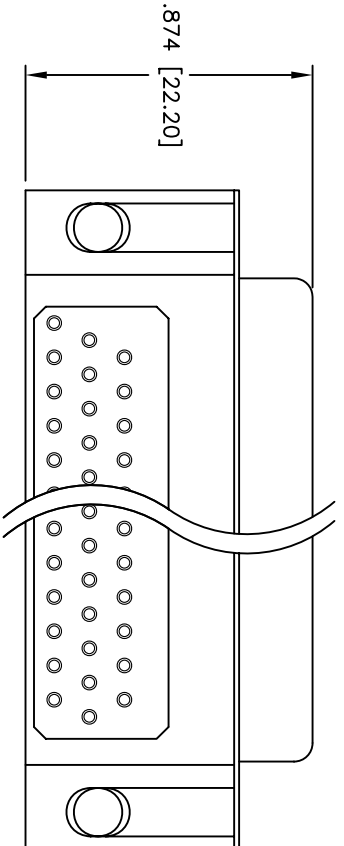
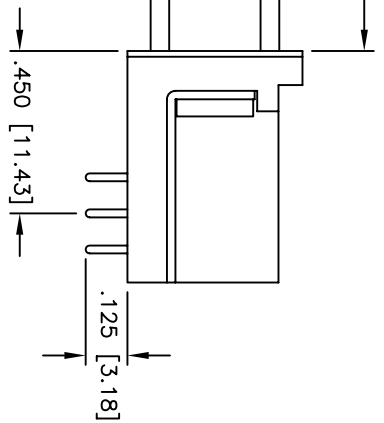
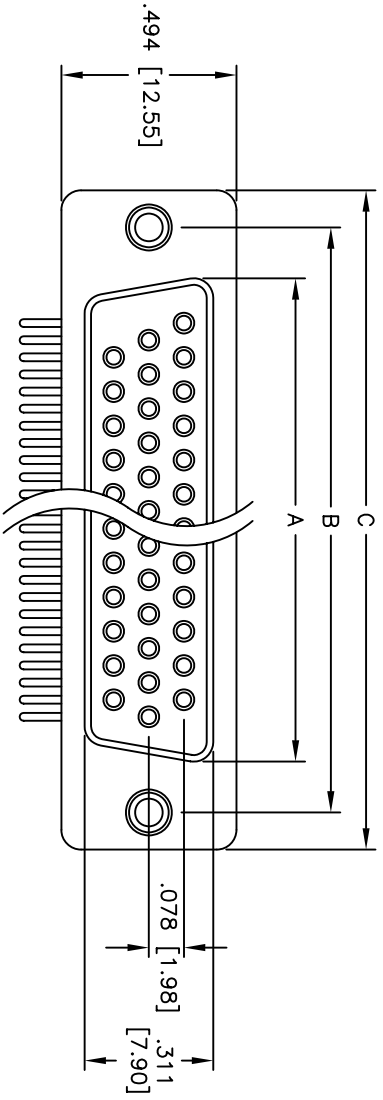

HDTXX	DIMENSIONS				
	A	B	C	D	E
26	.971 [24.66]	1.312 [33.32]	1.541 [39.14]	.271 [6.88]	.090 [2.29]
44	1.511 [38.38]	1.852 [47.04]	2.088 [53.04]	.271 [6.88]	.090 [2.29]
62	2.159 [54.84]	2.500 [63.50]	2.729 [69.32]	.276 [7.00]	.095 [2.41]

**SPECIFICATIONS:**

Material: Insulator: PBT, glass reinforced, rated UL 94V-0  
 Insulator color: Black  
 Contacts: Phosphor Bronze  
 Shell: Steel, Tin plated  
 Hardware: Brass, Nickel plated  
 Plating: Gold flash over Nickel underplate overall

**Electrical:**

Operating voltage: 250 VAC max  
 Current rating: 5 Amps max  
 Contact resistance: 20 mohms max  
 Insulation resistance: 5,000 Mohms min  
 Dielectric withstanding voltage: 1,000 VAC for 1 minute  
 Temperature Rating: Operating temperature: -65°C to +125°C  
 Environmental: Lead free, RoHS compliant  
 Recommended soldering temp: 235°C for 5 seconds



**ADAM TECH**

909 Rahway Avenue, Union, NJ 07083  
 Phone: 908-687-5000 Fax: 908-687-5710

HIGH DENSITY D-SUB SOCKET, EMI FILT.  
 #4-40 INSERTS & TOPSIDE GROUNDSTRAPS

UNLESS OTHERWISE SPECIFIED ALL DIMENSIONS ARE INCHES [MM]		TOLERANCES: EXCEPT AS NOTED	
INCHES		HOLDS	
.X	± .10	ØX	± .10
.XX	± .020	ØXXX	± .015
.XXX	± .015	ØXXXX	± .010
APPROVALS		DATE	
DRAWN	SS	5/10/05	
CHECKED			
APPROVED			
TITLE		SIZE	PART NO.
HIGH DENSITY D-SUB SOCKET, EMI FILT. #4-40 INSERTS & TOPSIDE GROUNDSTRAPS		X	HDLXX-SL-D-EMI
REV.		SCALE:	SHEET 1 OF 1
		NTS	