

| Rev | AWO # | Description | Date | Appr |
|-----|-------|-------------|---------|------|
| - | | RELEASED | 5/10/05 | |

APPROVED: _____
 DATE: _____ TITLE: _____

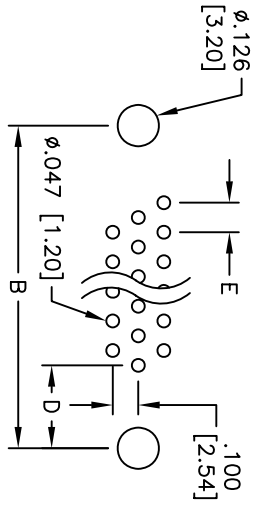
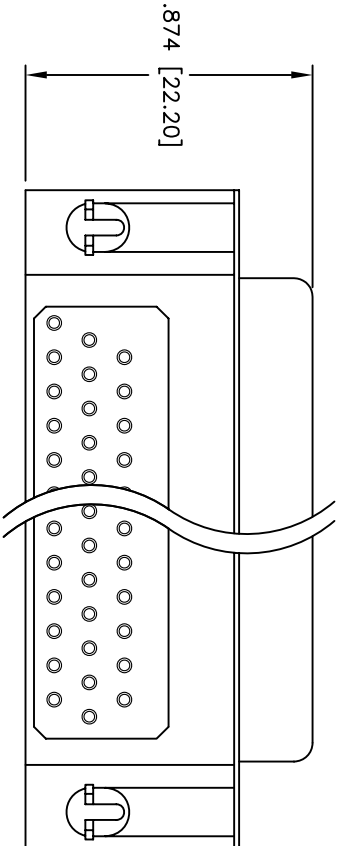
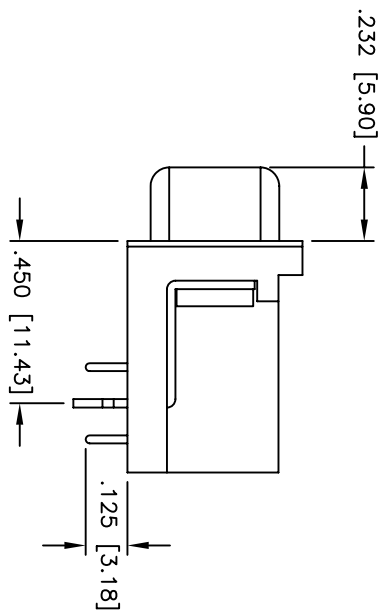
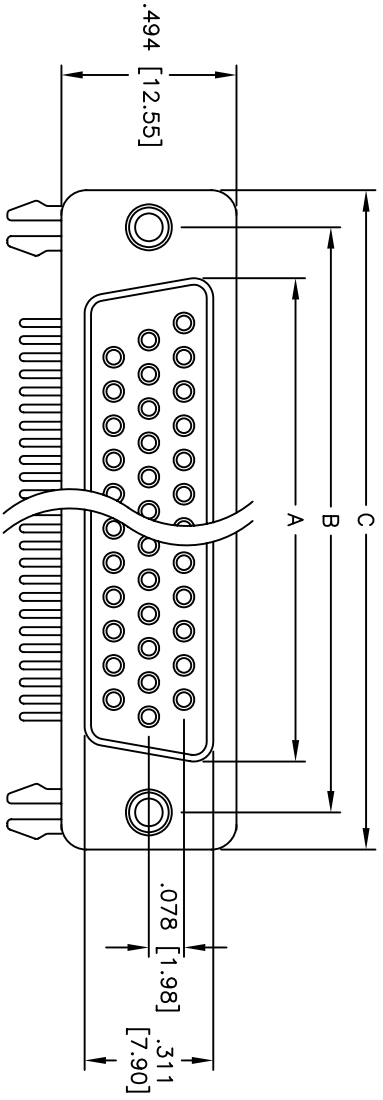

| HDTXX | DIMENSIONS | | | | |
|-------|---------------|---------------|---------------|-------------|-------------|
| | A | B | C | D | E |
| 26 | .971 [24.66] | 1.312 [33.32] | 1.541 [39.14] | .271 [6.88] | .090 [2.29] |
| 44 | 1.511 [38.38] | 1.852 [47.04] | 2.088 [53.04] | .271 [6.88] | .090 [2.29] |
| 62 | 2.159 [54.84] | 2.500 [63.50] | 2.729 [69.32] | .276 [7.00] | .095 [2.41] |

SPECIFICATIONS:

Material:
 Insulator: PBT, glass reinforced, rated UL 94V-0
 Insulator color: Black
 Contacts: Phosphor Bronze
 Shell: Steel, Tin plated
 Hardware: Brass, Nickel plated
 Plating:
 Gold flash over Nickel underplate overall

Electrical:
 Operating voltage: 250 VAC max
 Current rating: 5 Amps max
 Contact resistance: 20 mohms max
 Insulation resistance: 5,000 Mohms min
 Dielectric withstanding voltage: 1,000 VAC for 1 minute
 Temperature Rating:
 Operating temperature: -65°C to +125°C

Environmental:
 Lead free, RoHS compliant
 Recommended soldering temp: 235°C for 5 seconds



ADAM TECH

909 Rahway Avenue, Union, NJ 07083
 Phone: 908-687-5000 Fax: 908-687-5710

HIGH DENSITY D-SUB SOCKET, EMI FILT.
 #4-40 INSERTS & FORKED BOARDLOCKS

| | | | |
|---|--------|-----------------------------|----------------|
| UNLESS OTHERWISE SPECIFIED ALL DIMENSIONS ARE INCHES [MM] | | TOLERANCES: EXCEPT AS NOTED | |
| INCHES | | HOLDS | |
| .X | ± .10 | ØX | ± .10 |
| .XX | ± .020 | ØXXX | ± .015 |
| .XXX | ± .015 | ØXXXX | ± .010 |
| APPROVALS | | DATE | |
| DRAWN | SS | 5/10/05 | |
| CHECKED | | | |
| APPROVED | | | |
| TITLE | | SIZE | PART NO. |
| HIGH DENSITY D-SUB SOCKET, EMI FILT. #4-40 INSERTS & FORKED BOARDLOCKS | | X | HDLXX-SL-B-EMI |
| REF: | | SCALE: | SHEET 1 OF 1 |
| | | NTS | |