

Rev	AWO #	Description	Date	Appr
-		RELEASED	1/6/11	

APPROVED: \_\_\_\_\_  
 DATE: \_\_\_\_\_ TITLE: \_\_\_\_\_

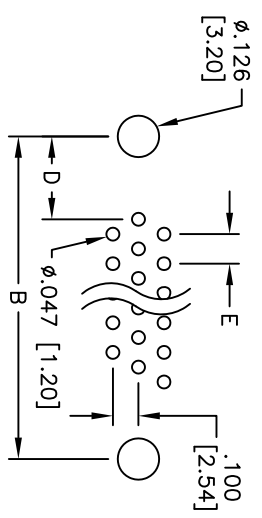
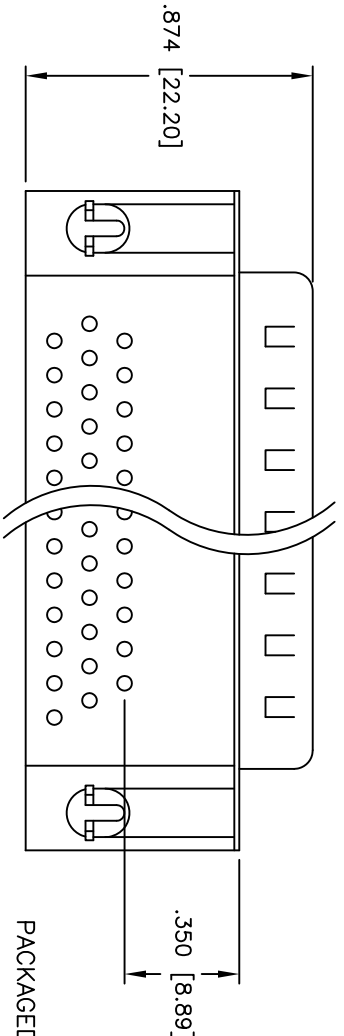
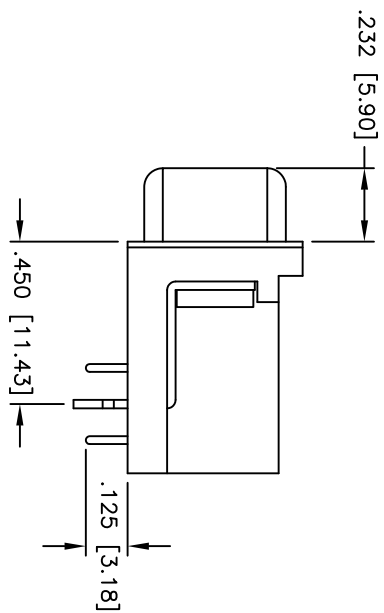
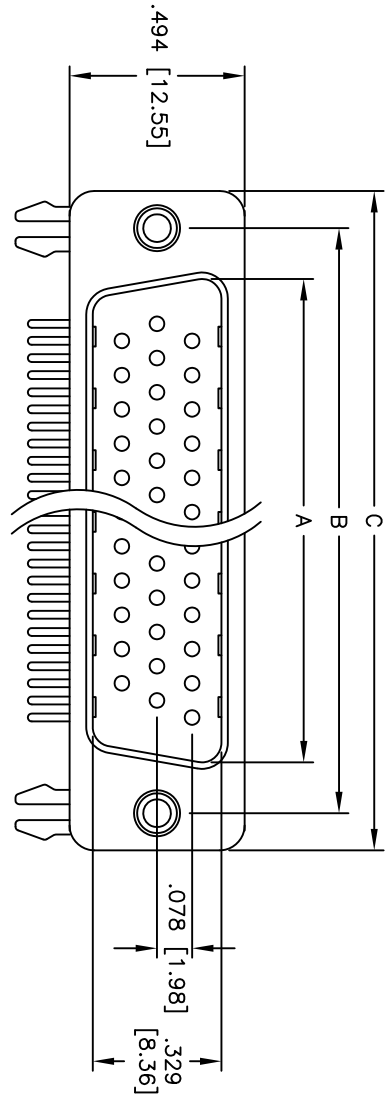

PACKAGED ON TAPE AND REEL

PCB LAYOUT

HDTXX	DIMENSIONS				
	A	B	C	D	E
15	.666 [16.92]	.984 [24.99]	1.213 [30.81]	.277 [7.04]	.090 [2.29]
26	.994 [25.25]	1.312 [33.32]	1.541 [39.14]	.271 [6.88]	.090 [2.29]
44	1.534 [38.96]	1.852 [47.04]	2.088 [53.04]	.271 [6.88]	.090 [2.29]
62	2.182 [55.42]	2.500 [63.50]	2.729 [69.32]	.276 [7.00]	.095 [2.41]

**SPECIFICATIONS:**

Material: Insulator: PBT, glass reinforced, rated UL 94V-0  
 Insulator color: Black  
 Contacts: Phosphor Bronze  
 Shell: Steel, Tin plated  
 Hardware: Brass, Nickel plated  
 Plating: Gold flash over Nickel underplate overall  
 Electrical: Operating voltage: 250 VAC max  
 Current rating: 5 Amps max  
 Contact resistance: 20 mohms max  
 Insulation resistance: 5,000 Mohms min  
 Dielectric withstanding voltage: 1,000 VAC for 1 minute  
 Temperature Rating: Operating temperature: -65°C to +125°C  
 Environmental: Lead free, RoHS compliant  
 Recommended soldering temp: 235°C for 5 seconds



**ADAM TECH**

909 Railway Avenue, Union, NJ 07083  
 Phone: 908-687-5000 Fax: 908-687-5710

HIGH DENSITY D-SUB PLUG, RIGHT ANGLE  
 #4-40 INSERTS & FORKED BOARDLOCKS

UNLESS OTHERWISE SPECIFIED ALL DIMENSIONS ARE INCHES [MM] TOLERANCES: EXCEPT AS NOTED		INCHES		HOLE SIZES	
.X	± .10	Ø.X	± .10		
.XX	± .020	Ø.XXX	± .015		
.XXX	± .015	Ø.XXX	± .010		
APPROVALS		DATE		TITLE	
DRAWN	AY	1/6/11		HDLXX-PL-B-T/R	
CHECKED	JL	1/6/11		PART NO.	
APPROVED				SIZE X	
		REF:		SCALE: NTS	
				SHEET 1 OF 1	