

Rev	AWO #	Description	Date	Appr
-		RELEASED	3/05/10	

APPROVED: _____
 DATE: _____ TITLE: _____

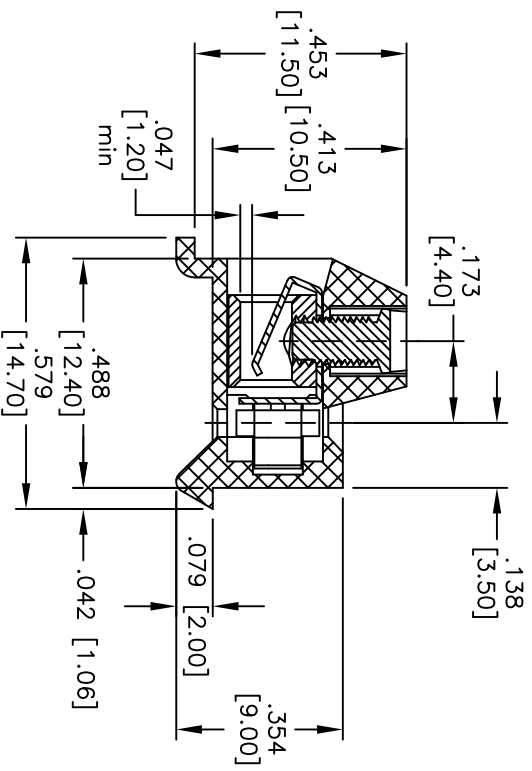
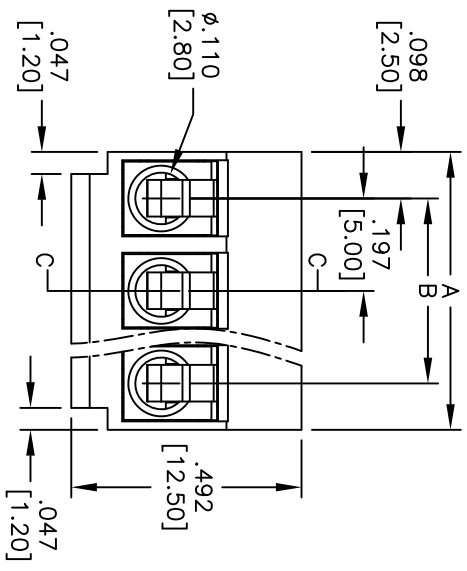
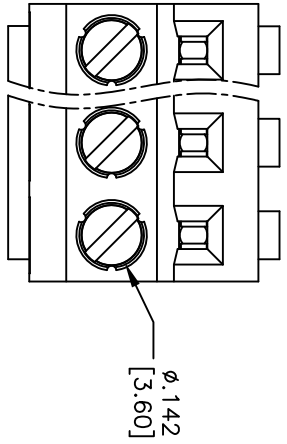

SECTION C-C

Poles: 2 thru 24
 A = .197 [5.00] X No. of Positions
 B = .197 [5.00] X No. of Spaces

UNLESS OTHERWISE SPECIFIED
 ALL DIMENSIONS ARE MM [INCHES]
 TOLERANCES: EXCEPT AS NOTED

INCHES	HOLES
X ± .10	ØX ± .10
.XX ± .020	ØXX ± .015
.XXX ± .015	ØXXX ± .010

ADAM TECH
 909 Rahway Avenue, Union, NJ 07083
 Phone: 908-687-5000 Fax: 908-687-5710

TERMINAL BLOCK, .197" [5.00] PITCH



SPECIFICATIONS:
 Material: Thermoplastic, rated UL 94V-0
 Insulator color: Green
 Wire Cage: Phosphor Bronze, Tin plated.
 Screw: Steel, M2.6/Zinc plated.
 Contact: Brass, Tin plated.
 Electrical:
 Operation voltage: 300 VAC max
 Current rating: 10 Amps max per Pole
 Dielectric withstanding voltage: 1600 VAC for 1 minute
 Mechanical:
 Screw Torque: 3.5 Kgf-cm (max.)
 Wire Range: 14-26 Awg.
 Environmental:
 Operating temperature: -40°C to +115°C
 Lead free, RoHS compliant.
 Recommended soldering temp: 235°C for 5 sec.