

6

5

4

3

2

1

Rev	AWO #	Description	Date	Appr
-		RELEASED	9/10/04	

APPROVED: _____

DATE: _____ TITLE: _____

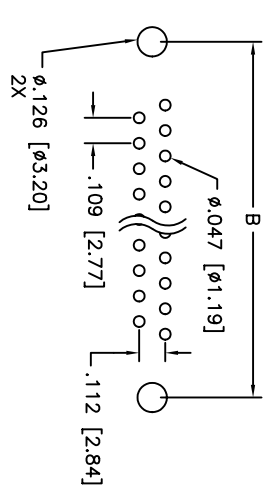
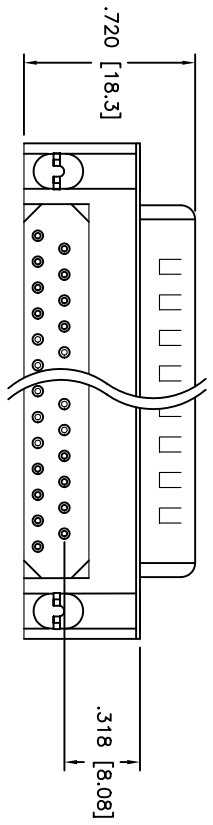
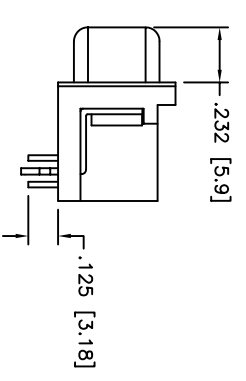
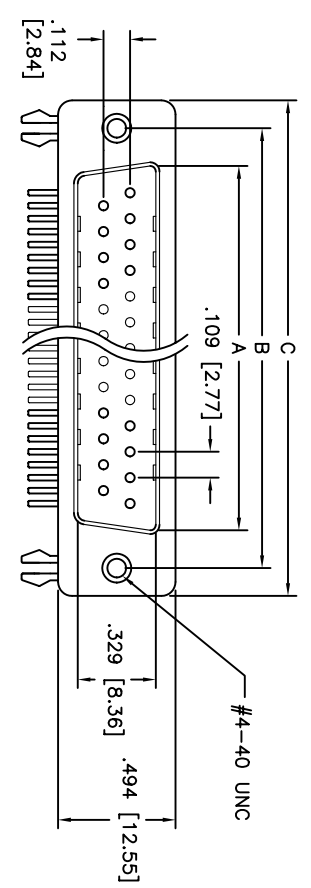

POSITIONS	Plug Dimensions		
	A	B	C
9	.666 (16.92)	.984 (24.99)	1.213 (30.81)
15	.994 (25.25)	1.312 (33.32)	1.541 (39.14)
25	1.534 (38.96)	1.852 (47.04)	2.088 (53.04)
37	2.182 (55.42)	2.500 (63.50)	2.729 (69.32)

SPECIFICATIONS:

Material:
 Insulator: PBT, 30% glass reinforced, rated UL 94V-0
 Insulator color: Black
 Contacts: Phosphor Bronze
 Shell: Steel, Tin plated
 Hardware: Brass, Nickel Plated
 Plating:
 Gold Flash over Nickel underplate overall
 Electrical:
 Operating voltage: 250 V AC/DC max
 Current rating: 5 Amps max
 Contact resistance: 20 mohms max. initial
 Insulation resistance: 5000 Mohms min @ 500 VDC
 Dielectric withstanding voltage: 1000 VAC for 1 minute
 Packaging:
 Anti-ESD plastic trays
 Temperature Rating:
 Operating temperature: -65°C to +125°C

ADAM TECH

909 Railway Avenue, Union, NJ 07083
 Phone: 908-687-5000 Fax: 908-687-5710

D-SUB, RIGHT ANGLE MALE, EMI
 FILTERED, .318 FOOTPRINT PCB

UNLESS OTHERWISE SPECIFIED ALL DIMENSIONS ARE INCHES [MM] TOLERANCES: EXCEPT AS NOTED		TITLE	
INCHES	HOLDS	D-SUB, RIGHT ANGLE MALE, EMI	
.X ± .10	ØXX ± .10	FILTERED, .318 FOOTPRINT PCB	
.XX ± .020	ØXXX ± .015	SIZE	PART NO.
.XXX ± .015	ØXXXX ± .010	X	DXXX-PL-24-EMI
APPROVALS	DATE	SCALE:	NTS
DRAWN	SS	9/10/04	
CHECKED			
APPROVED		REF:	SHEET 1 OF 1

6

5

4

3

2

1