

Rev	AWO #	Description	Date	Appr
-		RELEASED	11/22/04	

APPROVED: _____
 DATE: _____ TITLE: _____

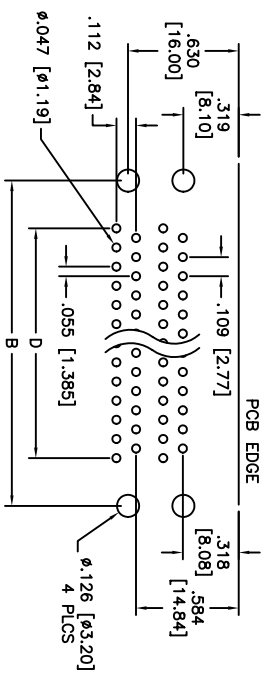
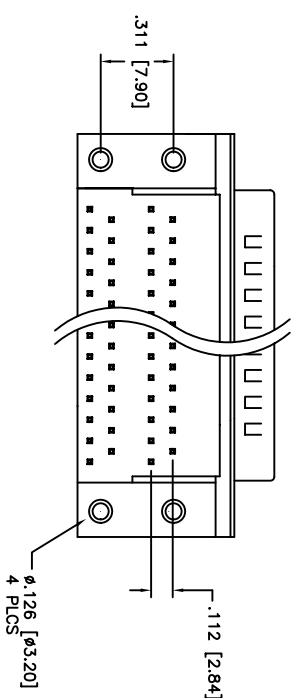
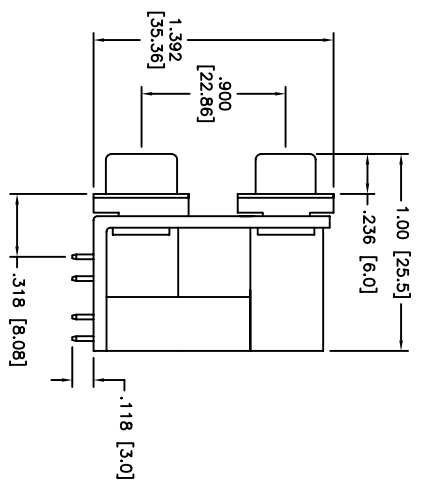
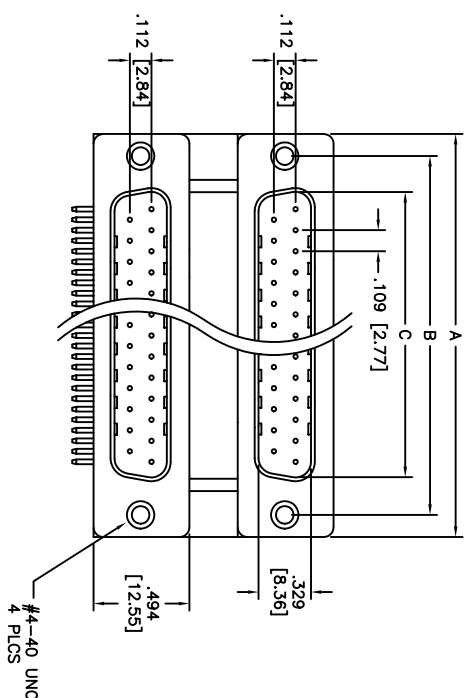

POSITIONS	Plug Dimensions			
	A	B	C	D
9	1.212 [30.80]	.984 [24.99]	.666 [16.92]	.436 [11.08]
15	1.541 [39.14]	1.312 [33.32]	.994 [25.25]	.763 [19.39]
25	2.086 [53.00]	1.852 [47.04]	1.534 [38.96]	1.308 [33.24]
37	2.729 [69.32]	2.500 [63.50]	2.182 [55.42]	1.963 [49.86]

SPECIFICATIONS:

Material: Insulator: PBT, glass reinforced, rated UL 94V-0
 Insulator color: Black
 Contacts: Phosphor Bronze
 Shell: Steel, Zinc plated
 Plating:
 5u" Gold nom over Nickel underplate overall
 Electrical:
 Operating voltage: 250 VAC max
 Current rating: 5 Amps max
 Contact resistance: 20 mohms max
 Insulation resistance: 5000 Mohms min @ 500 VDC
 Dielectric withstanding voltage: 1000 VAC for 1 minute
 Temperature Rating:
 Operating temperature: -65°C to +125°C

UNLESS OTHERWISE SPECIFIED ALL DIMENSIONS ARE INCHES [MM]	
TOLERANCES: EXCEPT AS NOTED	
INCHES	
.X ± .10	ØX ± .10
.XX ± .020	ØXX ± .015
.XXX ± .015	ØXXX ± .010
APPROVALS	DATE
DRAWN	SS 11/22/04
CHECKED	
APPROVED	

ADAM TECH
 909 Rahway Avenue, Union, NJ 07083
 Phone: 908-687-5000 Fax: 908-687-5710

TITLE: DUAL PORT D-SUB, RIGHT ANGLE
 MALE / MALE, XX POSITION, .900" PORT

SIZE	PART NO.	REV.
X	DPD-XX-11-A1	-
REF:	SCALE: NTS	SHEET 1 OF 1