

| Rev | AWO # | Description | Date | Appr |
|-----|-------|-------------|----------|------|
| - | | RELEASED | 10/01/10 | |

APPROVED: _____
 DATE: _____ TITLE: _____

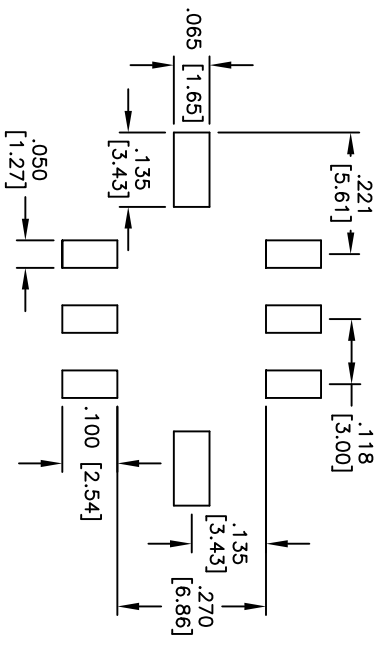

RECOMMENDED PCB LAYOUT

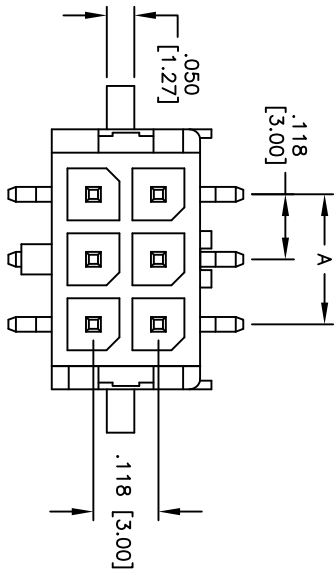
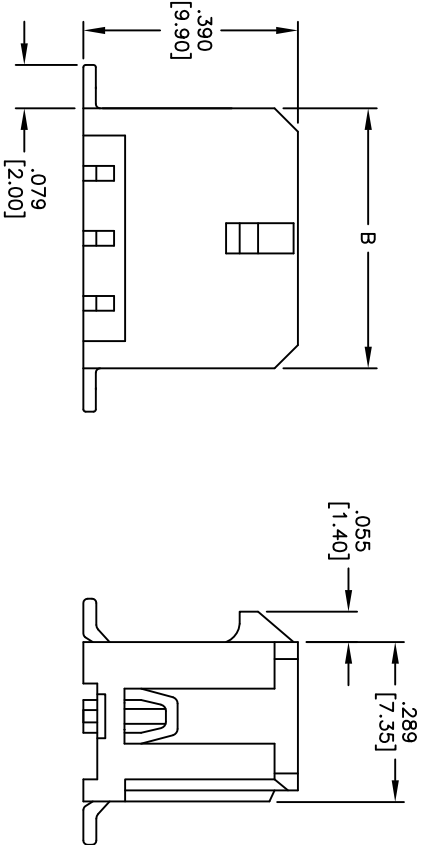

| POSITIONS | Dimension | |
|-----------|---------------|---------------|
| | A | B |
| 2 | N/A | .262 [6.65] |
| 4 | .118 [3.00] | .380 [9.65] |
| 6 | .236 [6.00] | .498 [12.65] |
| 8 | .354 [9.00] | .616 [15.65] |
| 10 | .472 [12.00] | .734 [18.65] |
| 12 | .591 [15.00] | .852 [21.65] |
| 14 | .709 [18.00] | .970 [24.65] |
| 16 | .827 [21.00] | 1.088 [27.65] |
| 18 | .945 [24.00] | 1.206 [30.65] |
| 20 | 1.063 [27.00] | 1.325 [33.65] |
| 22 | 1.181 [30.00] | 1.443 [36.65] |
| 24 | 1.299 [33.00] | 1.561 [39.65] |

PACKAGED ON TAPE & REEL

SPECIFICATIONS:

Material: Insulator: LCP, rated UL 94V-0
 Insulator color: Black
 Contacts: Brass
 Plating: Gold flash over Nickel underplate overall

Operating voltage: 250V AC, DC
 Electrical: Current rating: 5A AC, DC

Contact resistance: 10 mohms max
 Insulation resistance: 1000 mohms min
 Dielectric withstanding voltage: 1500 VAC for 1 minute
 Temperature range: -25°C to +105°C
 Environmental: RoHS compliant.
 Recommended soldering temp: 260°C for 5 sec.

ADAM TECH

909 Railway Avenue, Union, NJ 07083
 Phone: 908-687-5000 Fax: 908-687-5710

Part No. DML-XX-A-V-G-TSMT-T/R
 TITLE: .118 [3.00] DUAL ROW THRU HOLE HEADER
 VERTICAL, TRUE SMT TYPE

| | |
|--|--------------|
| UNLESS OTHERWISE SPECIFIED ALL DIMENSIONS ARE INCHES [MM] | |
| TOLERANCES: EXCEPT AS NOTED | |
| INCHES | HOLDS |
| .X ± .10 | ØXX ± .10 |
| .XX ± .020 | ØXXX ± .015 |
| .XXX ± .015 | ØXXXX ± .010 |
| APPROVALS | DATE |
| DRAWN | DY |
| CHECKED | |
| APPROVED | |

| | | |
|--------------|-----------------------|--------------|
| SIZE | PART NO. | REV. |
| X | DML-XX-A-V-G-TSMT-T/R | |
| REF: S00015T | SCALE: NTS | SHEET 1 OF 1 |

