

APPROVED: \_\_\_\_\_  
 DATE: \_\_\_\_\_ TITLE: \_\_\_\_\_

Rev	AWO #	Description	Date	Appr
-		RELEASED	10/13/04	
		REDRAWN	12/30/10	

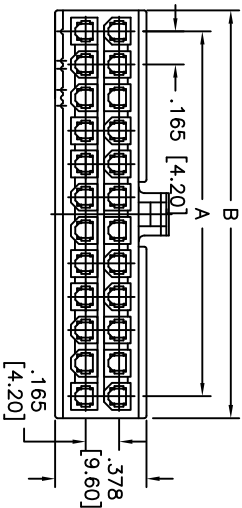
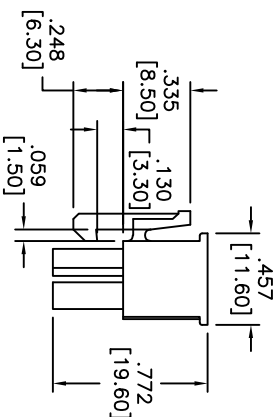
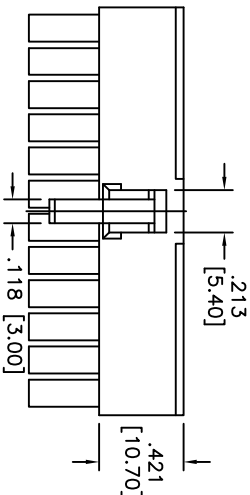
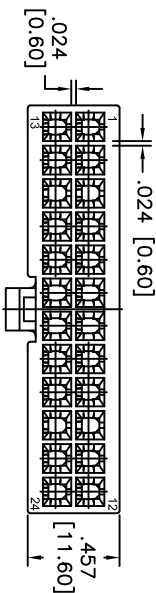

Position	A	B
2	.165 [4.20]	.221 [5.60]
4	.331 [8.40]	.386 [9.80]
6	.496 [12.60]	.551 [14.00]
8	.681 [16.80]	.717 [18.20]
10	.827 [21.00]	.882 [22.40]
12	.992 [25.20]	1.047 [26.60]
14	1.157 [29.40]	1.378 [35.00]
16	1.323 [33.60]	1.543 [39.20]
18	1.488 [37.80]	1.709 [44.10]
20	1.654 [42.00]	1.874 [47.60]
22	1.819 [46.20]	2.039 [51.80]

**SPECIFICATIONS:**

Material: Nylon 66, rated UL 94V-0  
 Insulator color: Natural  
 Electrical:  
 Operating voltage: 600 VAC max  
 Current rating: 9 Arms max  
 Insulation resistance: 1000 Mohms min  
 Dielectric withstanding voltage: 1500 VAC for 1 minute  
 Temperature Rating:  
 Operating temperature: -25°C to +120°C  
 Environmental:  
 Lead free, RoHS compliant.  
 Recommended soldering temp: 235°C for 5 sec.



**ADAM TECH**

909 Rahway Avenue, Union, NJ 07083  
 Phone: 908-687-5000 Fax: 908-687-5710

**WIRE TO WIRE CONNECTOR HOUSING**  
 MALE, 4.2MM PITCH

UNLESS OTHERWISE SPECIFIED ALL DIMENSIONS ARE INCHES [MM] TOLERANCES: EXCEPT AS NOTED		INCHES		HILES	
.X	± .10	ØXX	± .10		
.XX	± .020	ØXXX	± .015		
.XXX	± .015	ØXXX	± .010		
APPROVALS		DATE			
DRAWN	SS	10/13/04			
CHECKED					
APPROVED					
SIZE	PART NO.	SCALE	WTS	SHEET	1 OF 1
X	DMHM-XX				
REF:	S00099T				