

Rev	AWG #	Description	Date	Appr
-		RELEASED	7/28/04	

APPROVED: _____
 DATE: _____ TITLE: _____

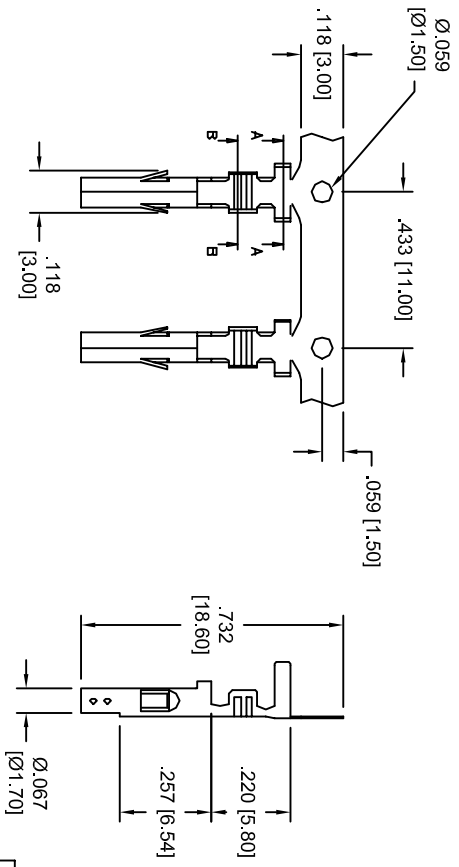

WIRE AWG	DIMENSIONS			
	C	D	E	F
22 ~ 26	.134 [3.4]	.130 [3.3]	.098 [2.5]	.090 [2.3]
18 ~ 22	.157 [4.0]	.177 [4.5]	.098 [2.5]	.090 [2.3]
16	.157 [4.0]	.177 [4.5]	.110 [2.8]	.106 [2.7]

SUPPLIED ON CHAIN REEL

SPECIFICATIONS:

Material: Brass
 Plating: Tin over Copper underplate
 Electrical: Operation voltage: 250 VAC max
 Current rating: 5 Amps max
 Mechanical: Packaging: Chain Reel

UNLESS OTHERWISE SPECIFIED
 ALL DIMENSIONS ARE INCHES [MM]
 TOLERANCES: EXCEPT AS NOTED
 INCHES: .X ± .10 ØXX ± .015
 .XX ± .020 ØXXX ± .010
 .XXX ± .015

ADAM TECH
 909 Rahway Avenue, Union, NJ 07083
 Phone: 908-687-5000 Fax: 908-687-5710

DRAWN	SS	7/28/04
CHECKED		
APPROVED		

TITLE	CRIMP TERMINAL, MINI FIT JR, 4.20mm	
DMH SERIES HOUSING	PART NO.	DMH-C-R
SIZE	X	REV.
SCALE	NTS	SHEET 1 OF 1