

Rev	AWO #	Description	Date	Appr
-		RELEASED	4/12/10	

APPROVED: \_\_\_\_\_  
 DATE: \_\_\_\_\_ TITLE: \_\_\_\_\_

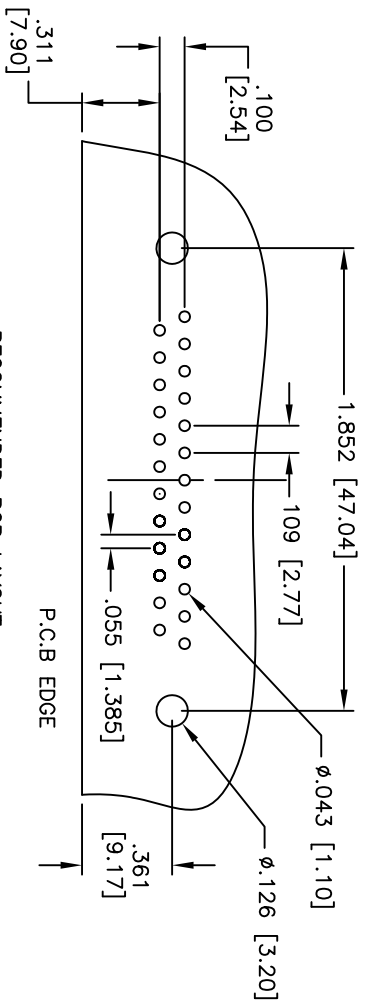
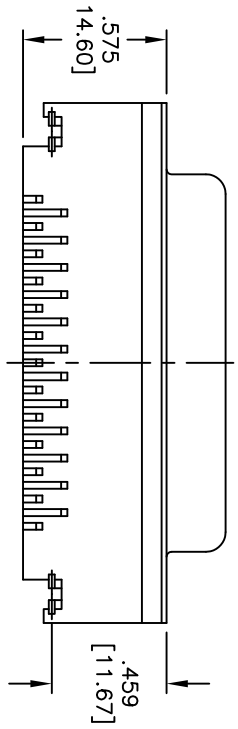
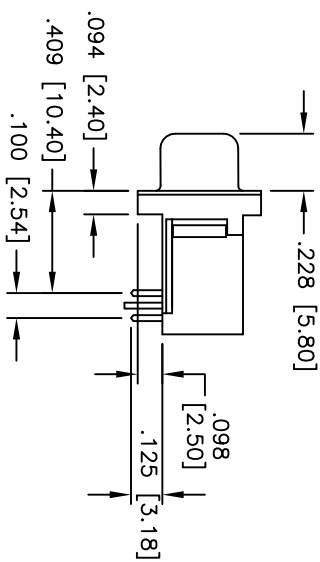
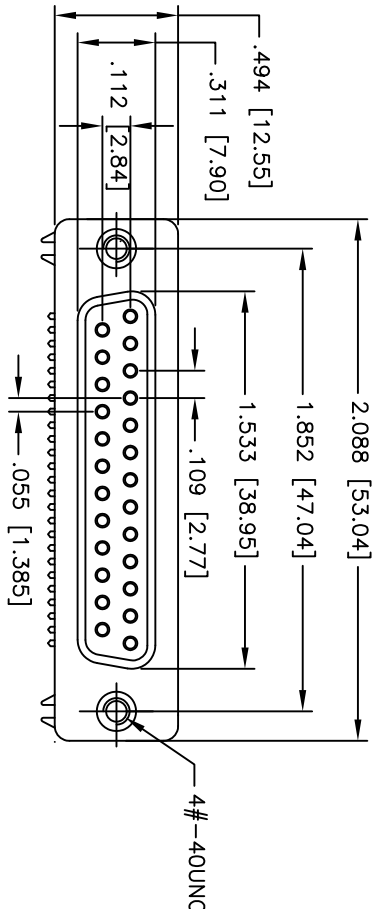

RECOMMENDED PCB LAYOUT

P.C.B EDGE

**SPECIFICATIONS:**

Material:

Insulator: PBT, glass reinforced, rated UL 94V-0

Insulator color: Black

Contacts: Brass

Shell: Steel, Nickel plated

Plating:

Gold flash over Nickel underplate overall

Electrical:

Current rating: 3 Amps max

Contact resistance: 25 mohms max

Insulation resistance: 5000 Mohms min@ 500VDC

Dielectric withstanding voltage: 1,000 VAC for 1 minute

Temperature Rating:

Operating temperature: -55°C to +105°C

Environmental:

Lead free, RoHS compliant

Recommended soldering temp: 235°C for 5 seconds



**ADAM TECH**

909 Rahway Avenue, Union, NJ 07083  
 Phone: 908-687-5000 Fax: 908-687-5710

TITLE: D-SUB CONNECTOR, SOCKET, RIGHT ANGLE  
 W/FORKED BOARD LOCKS, #4-40 THREADED INSERTS

UNLESS OTHERWISE SPECIFIED ALL DIMENSIONS ARE INCHES [MM]	
TOLERANCES: EXCEPT AS NOTED	
INCHES	HOLDS
.X ± .10	ØX ± .10
.XX ± .020	ØXX ± .015
.XXX ± .015	ØXXX ± .010
APPROVALS	DATE
DRAWN DY	4/12/10
CHECKED	
APPROVED	

SIZE X	PART NO. DB25-SJR-24	REV. -
REF: S0002T	SCALE: NTS	SHEET 1 OF 1