

Rev	AWO #	Description	Date	Appr
-		RELEASED	4/12/10	

APPROVED: _____
 DATE: _____ TITLE: _____

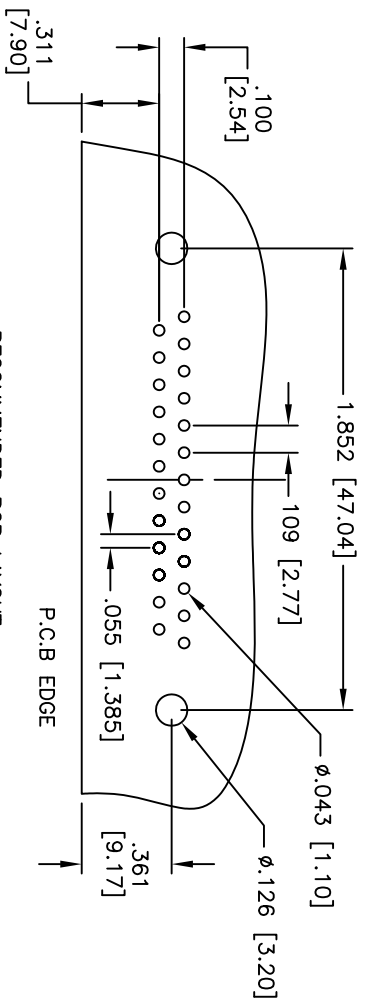
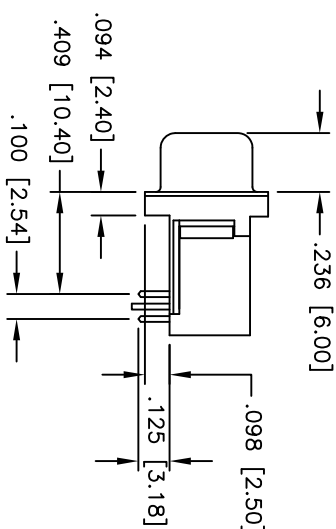
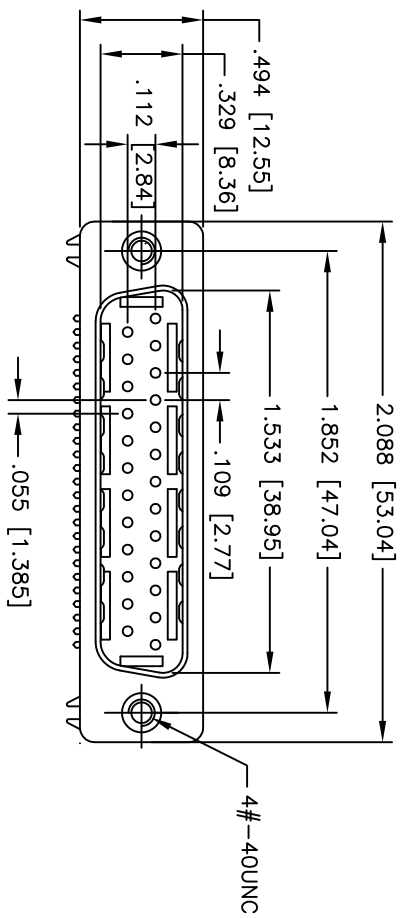

RECOMMENDED PCB LAYOUT

P.C.B. EDGE

SPECIFICATIONS:

Material:

Insulator: PBT, glass reinforced, rated UL 94V-0

Insulator color: Black

Contacts: Brass

Shell: Steel, Nickel plated

Plating:

Gold flash over Nickel underplate overall

Electrical:

Current rating: 3 Amps max

Contact resistance: 25 mohms max

Insulation resistance: 5000 Mohms min@ 500VDC

Dielectric withstanding voltage: 1,000 VAC for 1 minute

Temperature Rating:

Operating temperature: -55°C to +105°C

Environmental:

Lead free, RoHS compliant

Recommended soldering temp: 235°C for 5 seconds



ADAM TECH

909 Railway Avenue, Union, NJ 07083
 Phone: 908-687-5000 Fax: 908-687-5710

TITLE: D-SUB CONNECTOR, PLUG, RIGHT ANGLE

W/FORKED BOARD LOCKS, #4-40 THREADED INSERTS

UNLESS OTHERWISE SPECIFIED ALL DIMENSIONS ARE INCHES [MM]		HOLE SIZE	
TOLERANCES: EXCEPT AS NOTED		HOLE SIZE	
INCHES		HOLE SIZE	
.X	± .10	Ø.X	± .10
.XX	± .020	Ø.XX	± .015
.XXX	± .015	Ø.XXX	± .010
APPROVALS		DATE	
DRAWN	DY	4/12/10	
CHECKED			
APPROVED			
SIZE		PART NO.	
X		DB25-PJR-24	
REF: S0002T		SCALE: NTS	
		SHEET 1 OF 1	