

Rev	AWO #	Description	Date	Appr
-		RELEASED	11/03/09	

APPROVED: \_\_\_\_\_  
 DATE: \_\_\_\_\_ TITLE: \_\_\_\_\_

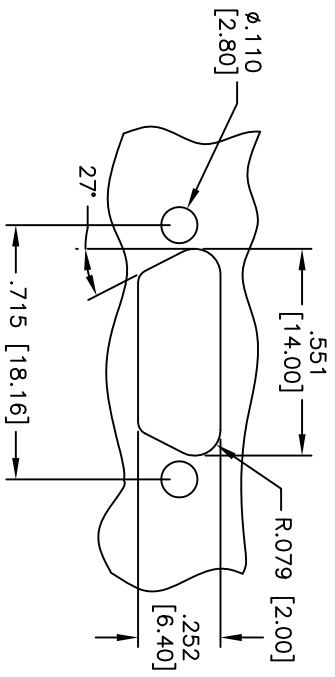
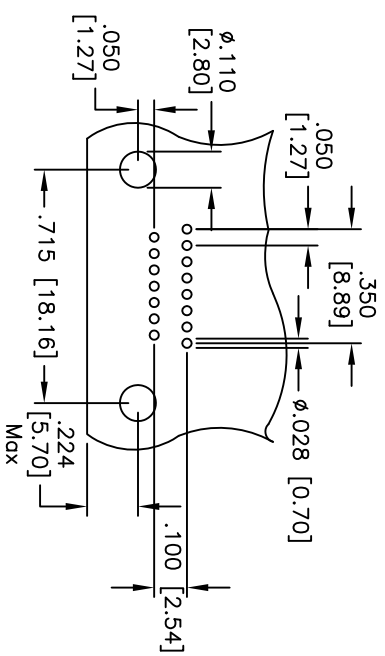
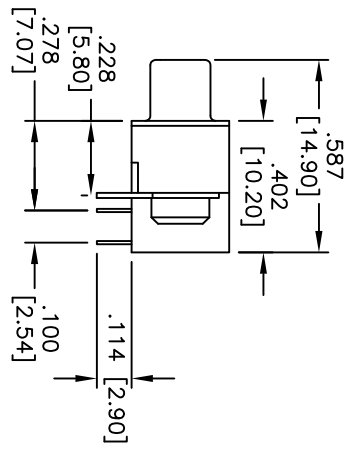
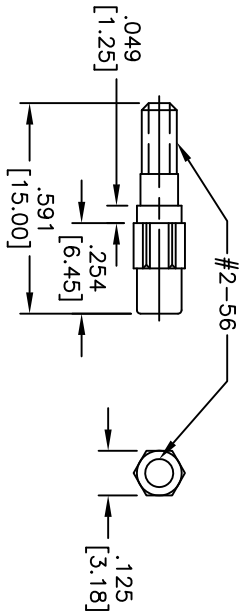
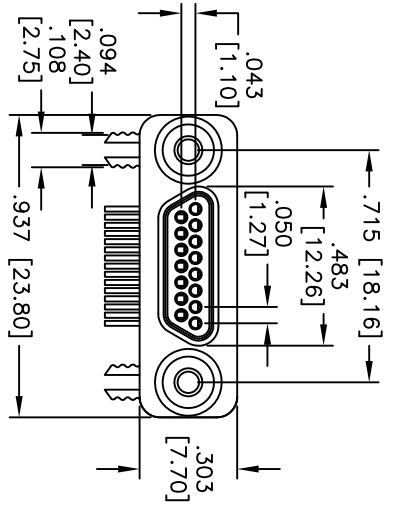
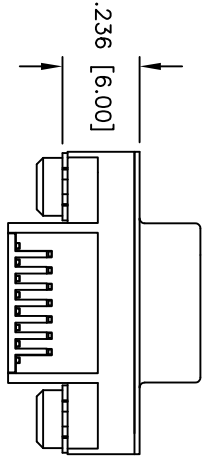

RECOMMENDED PCB LAYOUT  
 (15 POSITION ONLY)

Bulkhead Cutouts For SBUS

**SPECIFICATIONS:**

- Material: Insulator: Thermoplastic, rated UL 94V-0
- Insulator color: Black
- Contacts: Copper Alloy
- Shell: Cold Roller Steel, Tin plated
- Plating: 15u" Gold over Nickel underplate on mating end, Tin over Copper underplate on tails.

Electrical:  
 Current rating: 1 Amps  
 Contact resistance: 45 mohms max  
 Insulation resistance: 1000 Mohms min  
 Dielectric withstanding voltage: 500 VAC for 1 minute

Temperature Rating:  
 Operating temperature: -55°C to +85°C

Environmental:  
 Lead free, RoHS compliant

Recommended soldering temp: 235°C for 5 seconds



**ADAM TECH**

909 Rahway Avenue, Union, NJ 07083  
 Phone: 908-687-5000 Fax: 908-687-5710

TITLE: MICRO MINIATURE CONNECTOR,  
 RIGHT ANGLE TYPE

UNLESS OTHERWISE SPECIFIED ALL DIMENSIONS ARE IN INCHES [MM]		TOLERANCES: EXCEPT AS NOTED	
INCHES		HOLDS	
.X	± .10	ØXX	± .10
.XX	± .020	ØXXX	± .015
.XXX	± .015	ØXXXX	± .010
APPROVALS	DATE		
DRAWN	DY	11/03/09	
CHECKED			
APPROVED			
REF:	SIZE	PART NO.	REV.
S00133T	X	DA15-SG-22	-
SCALE:	NTS	SHEET	1 OF 1