

Rev	AWO #	Description	Date	Appr
-		RELEASED	9/10/10	

APPROVED: \_\_\_\_\_  
 DATE: \_\_\_\_\_ TITLE: \_\_\_\_\_

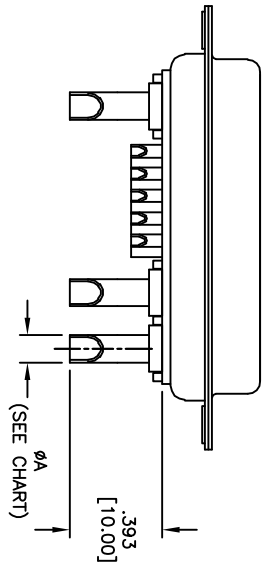
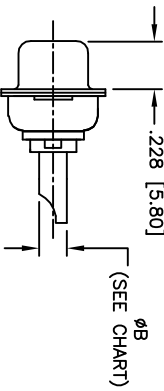
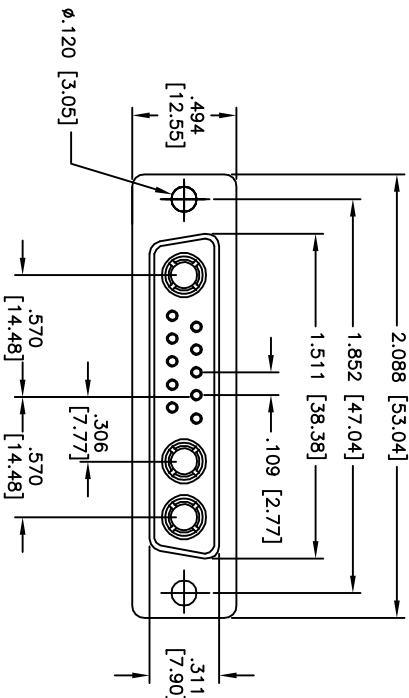

ADAM TECH PART NO.	CURRENT RATING	WIRE SIZE	DIMENSION	
			A	B
D13W3-SDP-61	40 AMPS	8-10 AWG	$\phi$ .181 [4.60]	$\phi$ .216 [5.50]
D13W3-SDP-51	30 AMPS	10-12 AWG	$\phi$ .146 [3.70]	$\phi$ .181 [4.60]
D13W3-SDP-41	20 AMPS	12-14 AWG	$\phi$ .106 [2.70]	$\phi$ .141 [3.60]
D13W3-SDP-31	10 AMPS	16-18 AWG	$\phi$ .067 [1.70]	$\phi$ .098 [2.50]

# ADAM TECH

909 Rahway Avenue, Union, NJ 07083  
 Phone: 908-687-5000 Fax: 908-687-5710

TITLE: D-SUB POWER SOCKET, D13W3, STRAIGHT, FEMALE, SOLDER CUP

UNLESS OTHERWISE SPECIFIED  
 ALL DIMENSIONS ARE INCHES [MM]  
 TOLERANCES: EXCEPT AS NOTED  
 INCHES: .X ±.10 ØXX ±.10  
 .XX ±.020 ØXXX ±.015  
 .XXX ±.015 ØXXXX ±.010

APPROVALS	DATE
DRAWN AY	9/10/10
CHECKED VW	9/10/10
APPROVED	

SIZE	PART NO.	REV.
X	D13W3-SDP-X1	-

REF: S0009T SCALE: NTS SHEET 1 OF 1

### SPECIFICATIONS:

- Material: Insulator: PBT, 30% glass reinforced, rated UL 94V-0
- Insulator color: Black
- Contacts: Brass
- Shell: Steel, Tin plated
- Hardware: Brass, Nickel plated
- Plating: Gold flash over Nickel underplate overall
- Electrical: Operating voltage: 250 VAC max
- Current rating: 10 – 40 Amps max (See Chart)
- Contact resistance: 10 mohms max
- Insulation resistance: 5,000 Mohms min
- Dielectric withstanding voltage: 1,000 VAC for 1 minute
- Temperature Rating: Operating temperature: -55°C to +280°C
- Environmental: Lead free, RoHS compliant

