

Rev	AWO #	Description	Date	Appr
-		RELEASED	9/10/10	

APPROVED: \_\_\_\_\_  
 DATE: \_\_\_\_\_ TITLE: \_\_\_\_\_

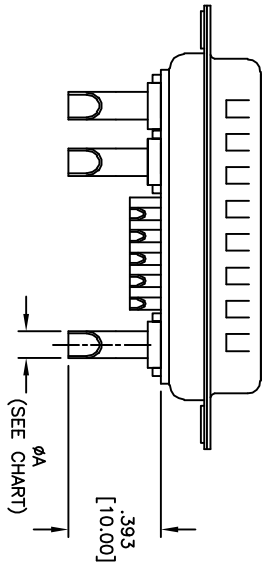
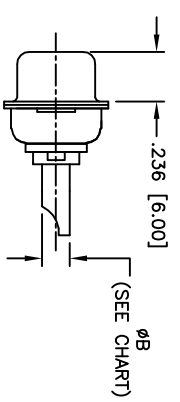
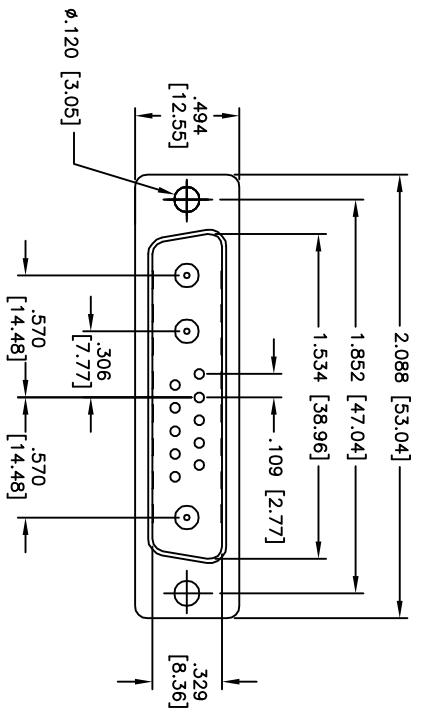

ADAM TECH PART NO.	CURRENT RATING	WIRE SIZE	DIMENSION	
			A	B
D13W3-PDP-61	40 AMPS	8-10 AWG	ø.181 [4.60]	ø.216 [5.50]
D13W3-PDP-51	30 AMPS	10-12 AWG	ø.146 [3.70]	ø.181 [4.60]
D13W3-PDP-41	20 AMPS	12-14 AWG	ø.106 [2.70]	ø.141 [3.60]
D13W3-PDP-31	10 AMPS	16-18 AWG	ø.067 [1.70]	ø.098 [2.50]

**SPECIFICATIONS:**

Material: Insulator: PBT, 30% glass reinforced, rated UL 94V-0  
 Insulator color: Black  
 Contacts: Brass  
 Shell: Steel, Tin plated  
 Hardware: Brass, Nickel plated  
 Plating: Gold flash over Nickel underplate overall

Electrical: Operating voltage: 250 VAC max

Current rating: 10 - 40 Amps max (See Chart)

Contact resistance: 10 mohms max

Insulation resistance: 5,000 Mohms min  
 Dielectric withstanding voltage: 1,000 VAC for 1 minute

Temperature Rating: Operating temperature: -55°C to +280°C  
 Environmental:

Lead free, RoHS compliant



**ADAM TECH**

909 Rahway Avenue, Union, NJ 07083  
 Phone: 908-687-5000 Fax: 908-687-5710

TITLE: D-SUB POWER PLUG, D13W3, STRAIGHT, FEMALE, SOLDER CUP

UNLESS OTHERWISE SPECIFIED ALL DIMENSIONS ARE INCHES [MM]		TOLERANCES: EXCEPT AS NOTED	
.X	± .10	ØX	± .10
.XX	± .020	ØXXX	± .015
.XXX	± .015	ØXXX	± .010
APPROVALS		DATE	
DRAWN	AY	9/10/10	
CHECKED	VW	9/10/10	
APPROVED			
SIZE	PART NO.	REV.	
X	D13W3-PDP-X1	-	
REF:	S00019T	SCALE:	NIS
SHEET 1 OF 1			