

Rev	AWO #	Description	Date	Appr
-	10688	RELEASED	11/05/10	

6

5

4

3

2

1

APPROVED: _____

DATE: _____ TITLE: _____

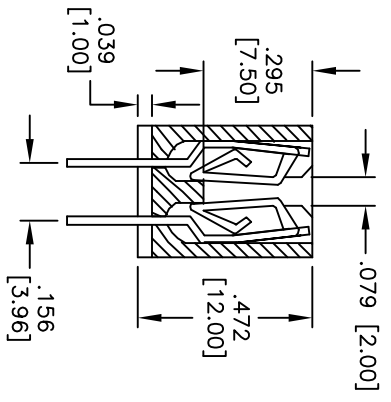
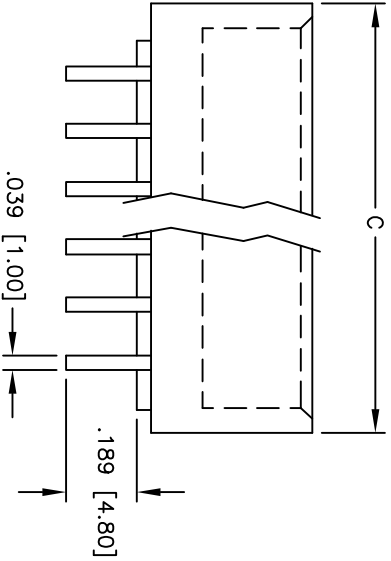
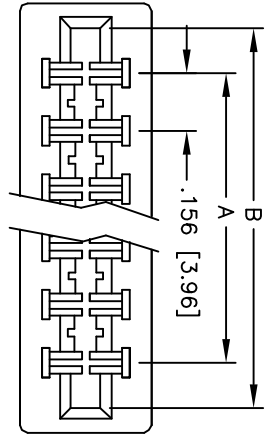

SPECIFICATIONS:

Material: PBT, Glass reinforced, rated UL 94V-0
 Insulator color: Black
 Contacts: Copper Alloy
 Plating: Gold flash over Nickel underplate overall

Electrical:
 Operating voltage: 500 VAC max.
 Current rating: 3 Amps max.
 Contact resistance: 20 mohms max. initial
 Insulation resistance: 5,000 Mohms min.

Temperature Rating:
 Operating temperature: -40°C to +105°C

Environmental:
 Lead free, RoHS compliant

Recommended soldering temp: 235°C for 5 seconds



Positions: 10, 12, 16, 20, 24, 26, 28, 30, 32, 36, 40, 44,
 46, 50, 56, 60, 62, 64, 70, 72
 A = .156 [3.96] x No. of Spaces
 B = A + .324 [8.22]
 C = A + .455 [11.56]

UNLESS OTHERWISE SPECIFIED
 ALL DIMENSIONS ARE INCHES [MM]
 TOLERANCES: EXCEPT AS NOTED

INCHES	HOLDS
.X ± .10	± .10
.XX ± .020	± .015
.XXX ± .015	± .010

ADAM TECH

909 Rahway Avenue, Union, NJ 07083
 Phone: 908-687-5000 Fax: 908-687-5710

TITLE: CARD EDGE CONNECTOR, VERTICAL,
 .156 CENTER SPACING, DIP TYPE

APPROVALS	DATE	SIZE	PART NO.	REV.
DRAWN	11/05/10	X	CE-XX-U-.156	-
CHECKED				
APPROVED				

6

5

4

3

2

1

A

B

C

D