

| Rev | AWO # | Description | Date     | Appr |
|-----|-------|-------------|----------|------|
| -   |       | RELEASED    | 11/10/09 |      |

APPROVED: \_\_\_\_\_  
 DATE: \_\_\_\_\_ TITLE: \_\_\_\_\_

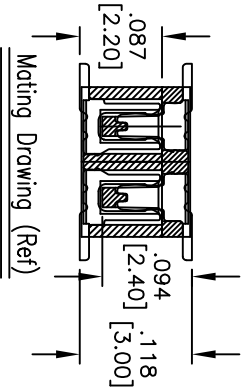
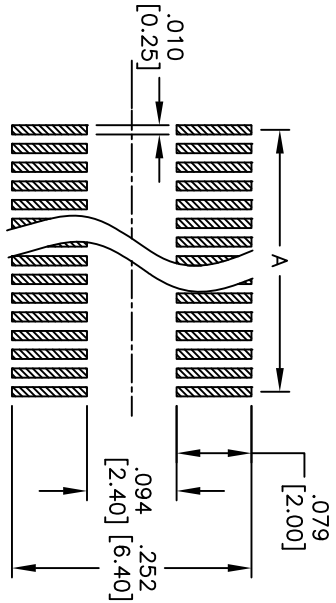
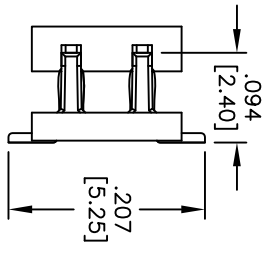
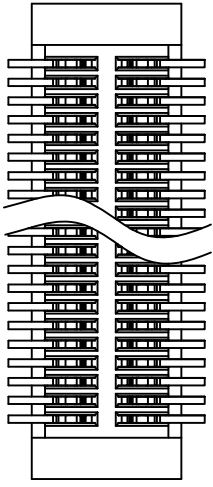
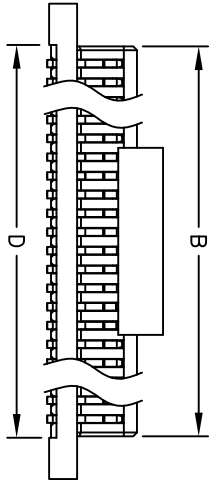
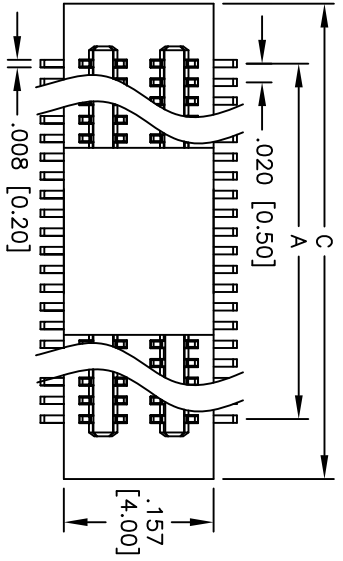

RECOMMENDED PCB LAYOUT

**SPECIFICATIONS:**  
 Material: Nylon 46, rated UL 94V-0  
 Insulator color: White  
 Contacts: Phosphor Bronze  
 Plating: Gold flash over Nickel underplate overall

**Electrical:**  
 Operating voltage: 50 VAC max.  
 Current rating: 0.5 Amps max.  
 Contact resistance: 30 mohms max. initial  
 Insulation resistance: 100 Mohms min@ 100V DC  
 Dielectric withstanding voltage: 100 VAC for 1 minute  
 Temperature Rating: -20°C to +105°C

**Environmental:**  
 Lead free, RoHS compliant  
 Recommended soldering temp: 260°C for 5 seconds



Positions: 10, 12, 14, 16, 18, 20, 22, 24, 26, 28, 30, 32, 34, 36, 38, 40, 42, 44, 46, 48, 50, 60, 70, 80, 90, 100, 100, 120

A = .020 [0.50] x (No. of Contacts - 1) + .036 [0.92]  
 B = .020 [0.50] x (No. of Contacts - 1) + .126 [3.20]  
 C = .020 [0.50] x (No. of Contacts - 1) + .039 [1.00]  
 D = .020 [0.50] x (No. of Contacts - 1) + .039 [1.00]

**ADAM TECH**

909 Rahway Avenue, Union, NJ 07083  
 Phone: 908-687-5000 Fax: 908-687-5710

TITLE: .020 [0.50] BOARD TO BOARD PLUG  
 2.2 MM HEIGHT, SMT TYPE, NO PEG

|  |              |
|--|--------------|
| UNLESS OTHERWISE SPECIFIED<br>ALL DIMENSIONS ARE INCHES [MM] |              |
| TOLERANCES: EXCEPT AS NOTED                                  |              |
| INCHES   | HOLDS        |
| .X ± .10   | ØXX ± .10    |
| .XX ± .020   | ØXXX ± .015  |
| .XXX ± .015  | ØXXXX ± .010 |
| APPROVALS  | DATE         |
| DRAWN  | DY           |
| CHECKED  |              |
| APPROVED   |              |

|              |                |              |
|--------------|----------------|--------------|
| SIZE         | PART NO.       | REV.         |
| X            | BB5-PD-XX-G-NP | -            |
| REF: S00035T | SCALE: NTS     | SHEET 1 OF 1 |