

APPROVED: _____

DATE: _____ TITLE: _____

Rev	AWO #	Description	Date	Appr
-		RELEASED	4/7/05	

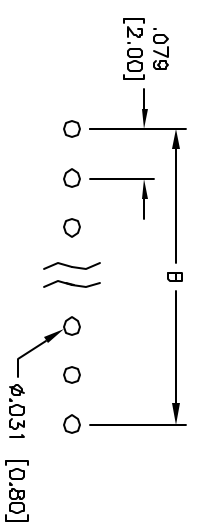
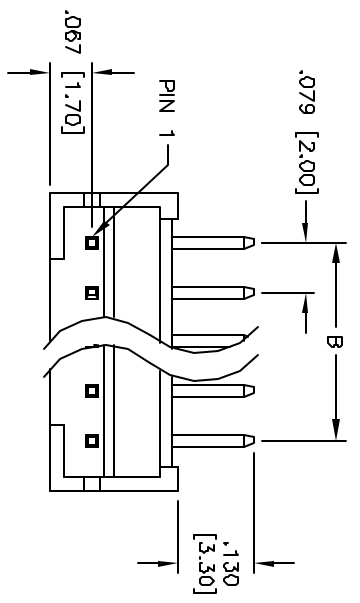

PCB LAYOUT

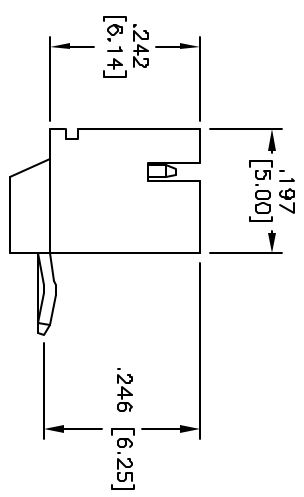
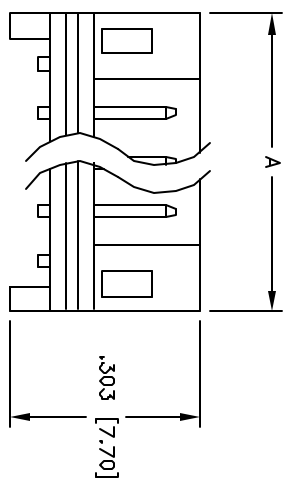

SPECIFICATIONS:

Material:

Insulator: Nylon 66, rated UL 94V-0

Insulator color: White

Contacts: Brass

Plating:

Tin over Copper underplate overall

Electrical:

Operating voltage: 100 VAC max

Current rating: 2 Amps max

Contact resistance: 10 mohms max

Insulation resistance: 1,000 Mohms min @ 500 VDC

Dielectric withstanding voltage: 1,000 VAC for 1 minute

Temperature Rating:

Operating temperature: -25°C to +85°C

Environmental:

Lead free, RoHS compliant

Recommended soldering temp: 230°C for 5 seconds



Positions: 2 thru 15
 A = .079 [2.00] x No. of Positions + .075 [1.90]
 B = .079 [2.00] x No. of Spaces

UNLESS OTHERWISE SPECIFIED
 ALL DIMENSIONS ARE NICHES [MM]
 TOLERANCES: EXCEPT AS NOTED
 INCHES: ±.10
 .XX ±.020
 .XXX ±.015
 .XXX ±.015

APPROVALS	DATE	TITLE
DRAWN: SS	4/7/05	ADAM TECH 909 Rahway Avenue, Union, NJ 07083 Phone: 908-687-5000 Fax: 908-687-5710 .079 [2.00] SHROUDED HEADER RIGHT ANGLE PCB
CHECKED:		
APPROVED:		

SIZE	PART NO.	SCALE	SHEET	OF
X	28H-C-XX-TR	NIB	1	1