

Rev	AWO #	Description	Date	Appr
-		RELEASED	7/22/10	

APPROVED: _____
 DATE: _____ TITLE: _____

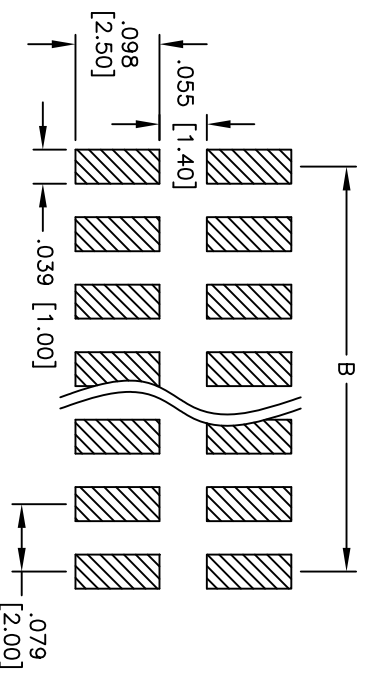

RECOMMENDED PCB LAYOUT

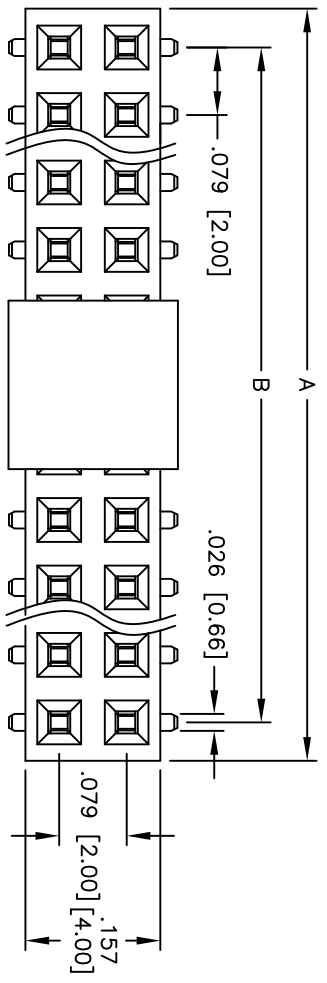
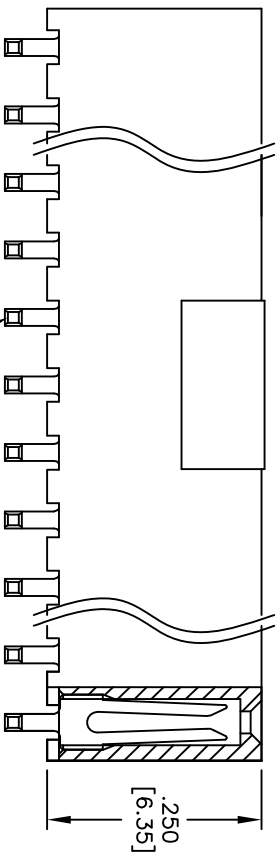

PACKAGED ON TPAE & REEL

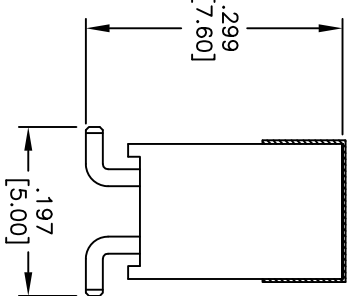

POSITIONS: 02 thru 40 per row
 A = .079 [2.00] x No. of Positions + .012 [0.30]
 B = .079 [2.00] x No. of Spaces

SPECIFICATIONS:
 Material: LCP, UL 94V-0
 Insulator color: Black
 Contacts: Phosphor Bronze
 Plating:
 Gold Flash over Nickel underplate on contact area, Tin over Copper underplate on SMT tails
 Electrical:
 Current rating: 2 Amps max.
 Contact resistance: 20 mohms max. initial
 Insulation resistance: 1,000 Mohms min.
 Dielectric withstanding voltage: 500 VAC for 1 minute
 Temperature Rating:
 Operating temperature: -55°C to +105°C
 Environmental:
 Lead free, RoHS compliant
 Recommended soldering temp: 260°C for 5 seconds

ADAM TECH
 909 Rahway Avenue, Union, NJ 07083
 Phone: 908-687-5000 Fax: 908-687-5710

TITLE: .079x.079 DUAL ROW RECEPTACLE STRIP
 .250 [6.35] HEIGHT, SEL GOLD PLATED, SMT

UNLESS OTHERWISE SPECIFIED ALL DIMENSIONS ARE IN INCHES [MM]	
TOLERANCES: EXCEPT AS NOTED	
.X INCHES	±.10
.XX HOLE	±.015
.XXX HOLE	±.010
APPROVALS	
DRAWN	AY
CHECKED	AH
DATE	7/22/10
APPROVED	

REF: S00032T	SCALE: NTS	SHEET 1 OF 1
SIZE	PART NO.	REV.
X	2RS2H-XX-SG-SMT-KT-T/R	-

