

Rev	AWO #	Description	Date	Appr
-		RELEASED	6/26/06	

APPROVED: _____
 DATE: _____ TITLE: _____

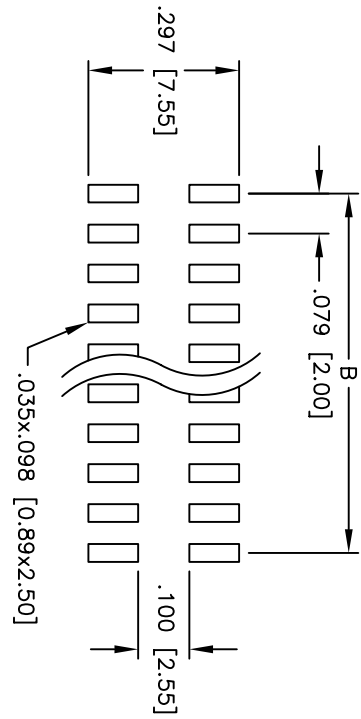

RECOMMENDED
PCB LAYOUT

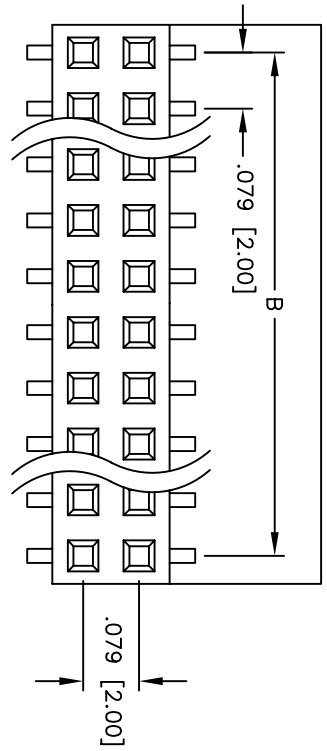
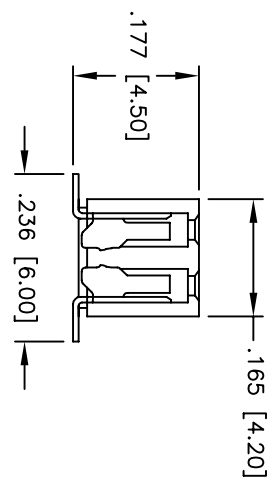
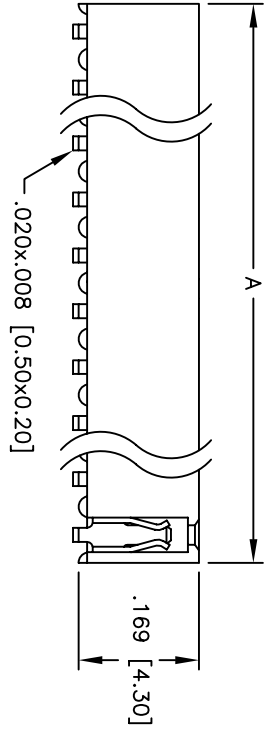

SPECIFICATIONS:

Material:
 Insulator: Hi-Temp Thermo plastic, rated UL 94V-0
 Insulator color: Black
 Contacts: Phosphor Bronze
 Plating:
 Gold flash over Nickel underplate on mating area, Tin over
 Copper underplate on SMT tails

Electrical:
 Operating voltage: 250 VAC max.

Current rating: 1 Amp max.

Contact resistance: 20 mohms max. initial

Insulation resistance: 5,000 Mohms min.

Dielectric withstanding voltage: 1,000 VAC for 1 minute

Temperature Rating:
 Operating temperature: -40°C to +105°C

Environmental:
 Lead free, RoHS compliant

Recommended soldering temp: 260°C for 5 seconds



Positions: 02 thru 80
 A = .079 [2.00] x No. of Positions per Row
 B = .079 [2.00] x No. of Spaces

UNLESS OTHERWISE SPECIFIED
 ALL DIMENSIONS ARE INCHES [MM]
 TOLERANCES: EXCEPT AS NOTED

INCHES	HOLES
.X ± .10	ØX ± .10
.XX ± .020	ØXXX ± .015
.XXX ± .015	ØXXX ± .010

ADAM TECH
 909 Railway Avenue, Union, NJ 07083
 Phone: 908-687-5000 Fax: 908-687-5710

TITLE: .079 x .079 DUAL ROW RECEPTACLE STRIP
 .169 [4.30] HEIGHT, SMT

APPROVALS	DATE
DRAWN SS	6/26/06
CHECKED	
APPROVED	

SIZE	PART NO.	REV.
X	2RS2-XX-SG-SMT-T/R	

SCALE: NTS SHEET 1 OF 1